

**Trailer hitch Corsa****Electrical equipment****Remove, dismantle**

Disconnect the earth cable from the battery and place it on one side. Disconnect the wiring harness plug from the rear lights.

**Install, fit**

Fit the trailer hitch wiring harness into the rear panel using a grommet. Connect the trailer hitch wiring harness to the bodywork wiring harness and the rear lights.

**Install, fit**

Fit the rubber seal on the trailer hitch wiring harness. Connect the trailer hitch wiring harness to the socket. Bolt the socket to the bracket.

Terminal assignment for 7-pole socket

1/L	Indicator left	(Black-and-white)
2/54 G	Rear fog light	(Black-and-blue)
3/31	Earth	(Brown)
4/R	Indicator right	(Black-and-green)
5/58 R	Parking light, right	(Grey-and-red)
6/54	Brake light	(Black-and-yellow)
7/58 L	Parking light, left	(Grey-and-black)

Terminal assignment for 13-pole socket

1	Indicator left	(Black-and white)
2	Rear fog light	(Black-and-blue)
3	Earth for circuit contact 1–8	(Brown 1.5 mm ²)
4	Indicator right	(Black-and-green)
5	Parking light, right	(Grey-and-red)
6	Brake light	(Black-and-yellow)
7	Parking light, left	(Grey-and-black)
8	Reversing light	(White-and-black)
9	Permanent positive terminal "30"	(Red 2.5 mm ²)
10–12	not used	
13	Earth for circuit contact 9–13	(Brown 2.5 mm ²)

**Install, fit**

When laying the "permanent current" cable to the socket, a free fuse slot in the fuse box is to be selected and a 20 A fuse fitted in this slot. The supply cable for this fuse must be laid to the positive pole on the battery and connected to it.

**Remove, dismantle**

Remove the indicator unit.

**Install, fit**

Insert the cable for the additional indicator control lamp with a flat plug sleeve in connector C2 for the trailer hitch indicator unit. Fit the trailer hitch indicator unit.

**Remove, dismantle**

Turn the signal switch casing (screws 1 and 2) on the steering column through 90°. **Figure D 4501 shows the column with the steering wheel removed for better clarity.**

**Remove, dismantle**

Unclip the indicator switch and wiper switch from the signal switch casing and hang them on one side (clip-on levers on both sides).

**Remove, dismantle**

Instrument cover (3 screws)

Remove the instrument cover between the upholstery and the

**Remove, dismantle****Instrument assembly**

Unscrew the speedometer shaft from the transmission.

Release the instrument assembly.

Pull the instrument assembly out of the instrument panel. Press down the retaining springs on the speedometer shaft and pull off the speedometer shaft. Release the 26-pole wiring harness plug from the instrument panel.

**Install, fit**

Connect the cable from the indicator unit, connection C2 to the wiring harness plug for the instrument panel, connection 26. Replace the wiring harness plug.

**Install, fit**

Fit the bulb for the additional indicator control lamp in the instrument assembly.

For vehicles without a rev counter I (10).

For vehicles with a rev counter II (1).

**Install, fit**

Reconnect the speedometer shaft.

**Important!**

The spring must click into position.

**Install, fit**

Insert the instrument assembly into the instrument panel and screw it into position.

Screw on the instrument cover.

Fit the indicator switch and wiper switch.

Screw on the signal switch casing.

Connect the speedometer shaft to the transmission.

Reconnect the battery.

**Important!**

Check additional indicator control lamp by switching on the hazard warning lights.

After disconnecting the battery, all volatile memories are to be reprogrammed. If the radio has a code and also station settings, the client is to be informed that the code and the station settings will have been deleted.

**Install, fit**

The "Admissible nose weight" sticker is to be affixed in a position where it is clearly visible (near the tow ball).

Check that the system works correctly.

To check the system, hitch a trailer to the vehicle.

If you test the system without a trailer, the socket terminals are to be tested using a test lamp.

When a trailer is hitched the two control lamp system is a sealed system.

The system will signal an error is only one bulb on the vehicle or the trailer fails.

When using the vehicle without a trailer, only the vehicle control light is operational.



How the dual control lamp system for the indicator control lights works.

With a trailer attached

Additional indicator control lamp	Standard indicator control lamp	Condition of indicator system on the activated side
flashes	flashes	Indicator system in working order
does not flash	flashes	One indicator failed – either on vehicle or trailer
does not flash	flashes at double speed	Two indicators failed – on vehicle alone or on vehicle and trailer, of three indicators failed – vehicle and trailer

Without a trailer attached

Additional indicator control lamp	Standard indicator control lamp	Condition of indicator system on the activated side
does not flash	flashes	Indicator system in working order
Please note: One to three flashes immediately after switching on is normal.		
does not flash	flashes at double speed or does not flash	One or two indicators failed

If you are towing a caravan with a Jäger System 13-pole plug, the appropriate 13-pole socket to match the plug from the Parts & Accessories range must be fitted on the towing vehicle instead of the 7-pole socket. A caravan with a 13-pole Multicon System plug may be connected to the 7-pole socket.

If, however, power is required in the caravan for interior lighting and the refrigerator, the appropriate 13-pole socket to match the plug from the Parts & Accessories range must be fitted on the towing vehicle instead of the 7-pole plug.

Connection of the 10-wire vehicle wiring harness to the 13-pole socket:

13-pol socket, terminal	Code colour	Cable connection	7-pole socket, terminal
1	Black-and-white	Indicator left	1/L
2	Black-and-blue	Rear fog light	2/54 G
3	Brown 1.5 mm ²	Earth for circuit contact 1–8	3/31
4	Black-and-green	Indicator right	4/R
5	Grey-and-red	Parking light, tail light, right	5/58 R
6	Black-and-yellow	Brake light	6/54
7	Grey-and-black	Parking light, tail light, left	7/58 L
8	White-and-black	Reversing light	
9	Red	Permanent positive terminal “30”	
10–12		Not used	
13	Brown 2.5 mm ²	Earth for circuit contact 9–13	

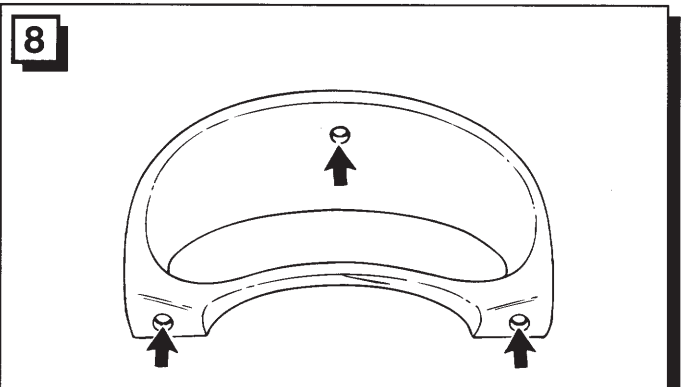
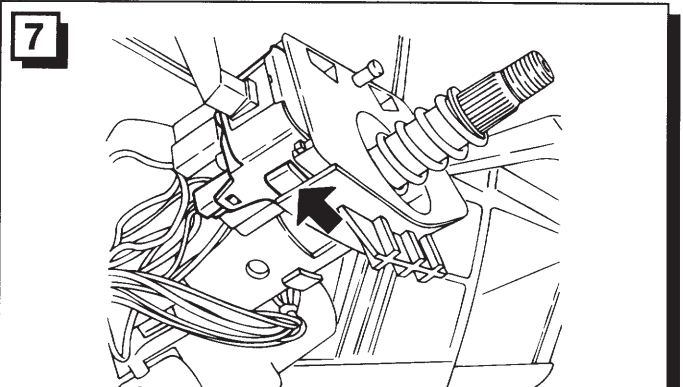
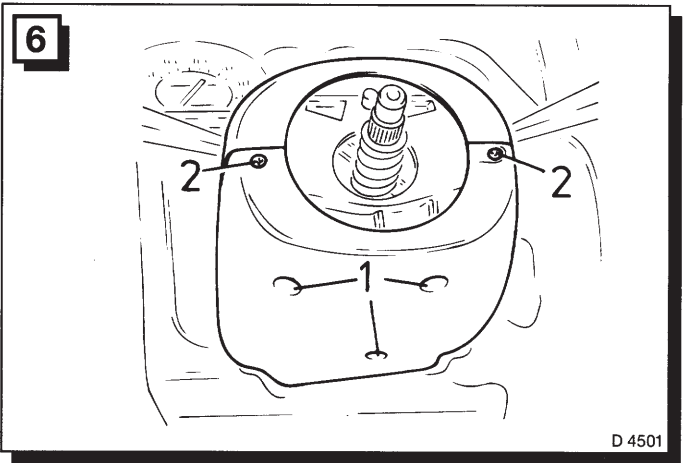
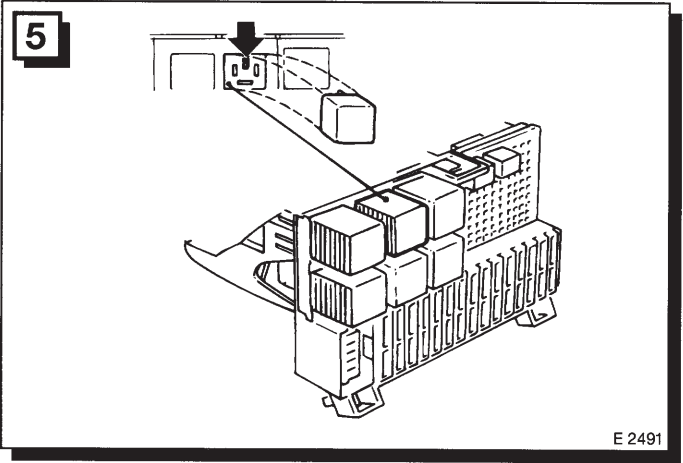
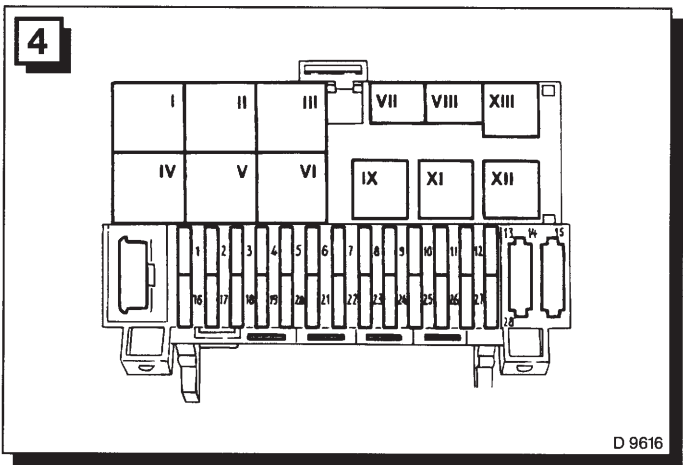
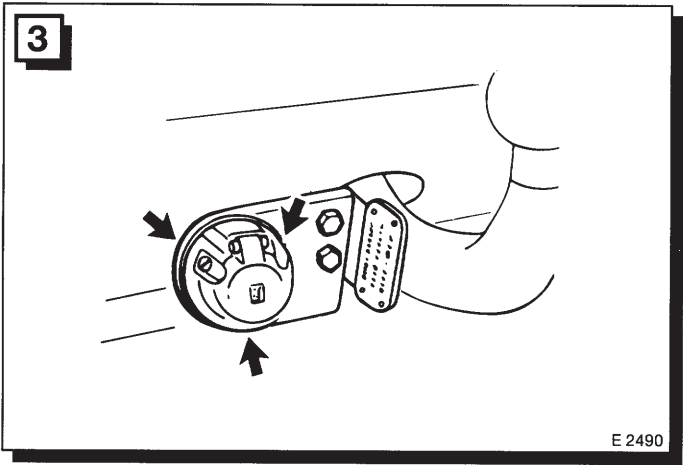
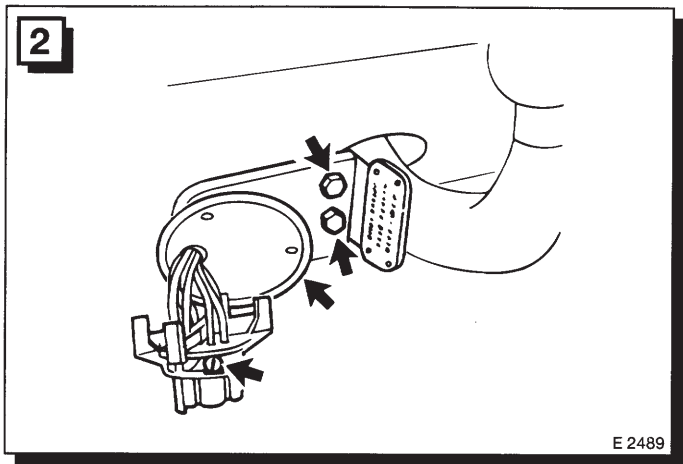
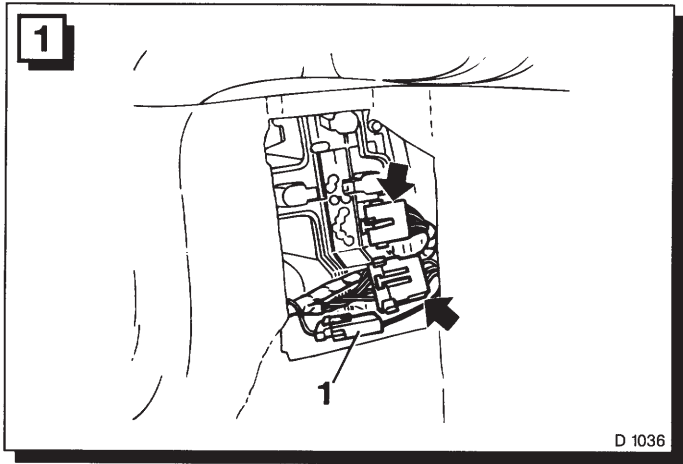

part number: 90486407

