

part numbers: 20989178 / 20989180

(D)	Änderungen bezüglich Konstruktion, Ausstattung, Farbe sowie Irrtum vorbehalten. Angaben und Abbildungen unverbindlich.	(D)	Einbauanleitung / nur Händlereinbau
(GB)	Subject to change in terms of construction, equipment and colour, and may contain errors. The information and illustrations are non-binding.	(GB)	Installation instructions / Dealer installation only
(F)	Sous réserve de modifications de la construction, de l'équipement, de la couleur et sous réserve d'erreurs. Les indications et les illustrations sont sans engagement.	(F)	Consignes de montage / Montage uniquement par le concessionnaire
(NL)	Wijzigingen met betrekking tot constructie, uitvoering en kleur evenals vergissingen voorbehouden. Gegevens en afbeeldingen niet bindend.	(NL)	Montagehandleiding / Montage alleen door dealers
(DK)	Ændringer med hensyn til konstruktion, udstyr, farver samt fejl forbeholdes. Oplysninger og illustrationer er uforpligtende.	(DK)	Montagevejledning / Montage kun hos forhandleren
(N)	Endringer angående konstruksjon, utstyr, farge og feiltagelse forbeholdes. Opplysninger og illustrasjoner uforbindtlig.	(N)	Monteringsinstruksjon / Montasje kun hos forhandleren
(S)	Med reservation för ändringar vad det gäller konstruktion, utrustning, färg samt för misstag. Uppgifterna och bilderna är inte bindande.	(S)	Installationsanvisning / Får endast monteras av återförsäljaren
(FIN)	Pidätämme oikeuden rakennetta, varustusta, väriä koskeviin sekä erehdyksistä johtuviin muutoksiin. Tiedot ja kuvat eivät ole sitovia.	(FIN)	Asennusohje / Asennus vain myyntiliikkeen toimesta
(I)	Con riserva di modifiche relative a progettazione, dotazione, colore ed errori. Le indicazioni e figure sono fornite senza impegno.	(I)	Istruzioni per il montaggio / Installazione solo presso la concessionaria
(E)	Reservadas las modificaciones respecto a diseño, equipamiento, color, así como error. Indicaciones y figuras sin compromiso.	(E)	Instrucciones de montaje / Instalación exclusiva por el distribuidor
(P)	Reservamos o direito de alterações relativamente ao desenho, equipamento, cor, bem como de erro. Os dados e as gravuras não implicam compromisso da nossa parte.	(P)	Instruções de montagem / Montagem só no concessionário
(GR)	Διατηνούμε κάθε επιφύλαξη ως προς αλλαγές σε σχέση με κατασκευή, εξοπλισμό, διαρρύθμιση, χρωματισμούς και λάθη παραδρομής.	(GR)	Οδηγίες εγκατάστασης / Συναρμολόγηση μόνο από εμπόρους
(CZ)	Změny, týkající se konstrukce, vybavení, barvy, jakož i omyly jsou vyhrazeny. Údaje a vyobrazení jsou nezávazné.	(CZ)	Návod k montáži / Montáž pouze prodejcem
(PL)	Zastrzega się prawo do zmian dot. konstrukcji, wykończenia, kolorystyki oraz pomyłek. Dane i ilustracje niewiążące.	(PL)	Instrukcja montażu / Montaż tylko u dealera
(TR)	Tasarım, donanım ve renk bakımından değişiklik yapma hakkı ve hata ve eksiklik mahfuzdur. Veriler ve resimler bağlayıcı değildir.	(TR)	Montaj talimatı / Sadece satıcı tarafında monte edilir
(H)	A szerkezet, a kivétel és a szín változtatása, valamint a változások joga fenntartva. Az adatok és az ábrák nem kötelező érvényűek.	(H)	Beépítési útmutató / Csak a kereskedő építheti be
(HR)	Pravo promjena u svezi konstrukcije, opreme, boje kao i zabune oridžavamo. Podaci i ilustracije su neobavezne.	(HR)	Upute o ugradnji / Ugradnja samo od strane trgovca
(BUL)	Запазени права по отношение на конструкцията, оборудването, цвета и грешки. Данните и изображенията не са обвързващи.	(BUL)	Инструкция за монтаж / Монтажът може да се извърши само от търговеца
(RO)	Ne rezervăm dreptul unor modificări ale construcției, dotării, culorii și dreptul la erori. Datele indicate și imaginile sunt orientative.	(RO)	Instrucțiuni de montaj / Se va monta numai de către dealer
(RUS)	Права на внесение изменений относительно конструкции, оснащения, окраски, а также на ошибки сохраняются. Данные и иллюстрации имеют примерный характер.	(RUS)	Инструкция по монтажу и установке / Устанавливать только у дилера
(LT)	Pasilikama konstrukcijos, įrangos bei reikmenų, spalvos pakeltimų ir klaidų teisė. Duomenys ir iliustracijos nepareigojantys.	(LT)	Montavimo informacija / Montuoja tik prekybininkas
(LV)	Tiek paturētas tiesības uz konstrukcijas, iekārtu, krāsu izmaiņām, kā arī kļūdīšanās. Dati un attēli bez saistībām.	(LV)	Iemontēšanas pamācība / Tikai pārdevēja iebūve
(EST)	Konstruktsioonid, varustuse ja värvi osas muudatused ning eksimised lubatud. Andmed ja joonised on mitteisiduvad.	(EST)	Paigaldusjuhend / Paigaldab ainult müüja
(SLO)	Zadržana pravica do sprememb glede konstrukcije, opreme, barve ter pomote. Podatki in slike so neobvezne.	(SLO)	Navodilo za vgradnjo / Vgradnja le od trgovca
(SK)	Zmeny, ktoré sa týkajú konštrukcie, vybavenia, farby, ako aj omyly sú vyhradené. Údaje a zobrazenia sú nezáväzné.	(SK)	Montážny návod / Montáž iba obchodníkom
(J)	構造、装備、色に關しての変更、または間違ひがある可能性があります。記載事項および図に關して責任を負いません。	(J)	取り付け説明書 / 販売業者取り付けのみ
(ROK)	구조, 장치, 색채와 그의 오류점의 변경 보류할. 지시 사항과 사진들에 관해 책임을 지지 않을.	(ROK)	장치 지시사항 / 오직 전문상인이 장치
(THA)	อาจมีการเปลี่ยนแปลงแก้ไขในแง่ของโครงสร้าง อุปกรณ์ และสี และอาจมีข้อผิดพลาดได้ ข้อมูลและภาพประกอบไม่ถือเป็นข้อผูกมัด	(THA)	คู่มือการติดตั้ง / ติดตั้งโดยตัวแทนจำหน่ายเท่านั้น
(VR)	保留設計、配置、顏色以及錯誤的修改權。給出的資料和插圖均沒有法律約束力。	(VR)	安裝說明書 / 僅供銷售商安裝用
(VR)	保留設計、配置、顏色以及錯誤的修改權。給出的資料和插圖均沒有法律約束力。	(VR)	安裝說明書 / 僅供銷售商安裝用

part numbers: 20989178 / 20989180

Front Floor Console Cup Holder Illumination Lamp Package Installation

Installation Instructions Part Number

20989180

Cupholder Lighting Kit Contents

Qty	Description
1	Lighting ECU
1	Cupholder LED's with Pigtail Harness
1	Switch with Pigtail Harness
1	8 - Way Connector (shipped loose)
1	Power Harness
1	Installation and Hardware Kit
1	Installation Instructions
1	Owner's Manual

Footwell Lighting Kit Contents

Qty	Description
1	Footwell LED's with Pigtail Wiring Harness
1	Footwell Specific Hardware Kit

Recommended Tools

- Plastic Trim Removal Tool
- Drill with 1/8", 5/32", 5/16", 9/16" and 15/32" drill bits
- ¼ Drive Ratchet with 7 mm and 10 mm Sockets
- Center Punch/Awl
- T 20 Torx bit

Installation Sequence

Note If the vehicle is Right Hand Drive (RHD), then the procedure needs to be followed in the same way but in the opposite side as seen in a mirror.

Note Please review the entire procedure before trying to perform it.

Note After safety mandated preparatory steps have been taken, the installation sequence is the suggested method for completing the accessory installation. In some instances, the suggested sequence is written for one associate to install and in others the sequence is given as part of a team accessory installation. Unless otherwise stated in the document, the associates may perform the installation steps in any order to make the installation as efficient as possible while maintaining consistent quality.

Battery Disconnect

part numbers: 20989178 / 20989180

1.

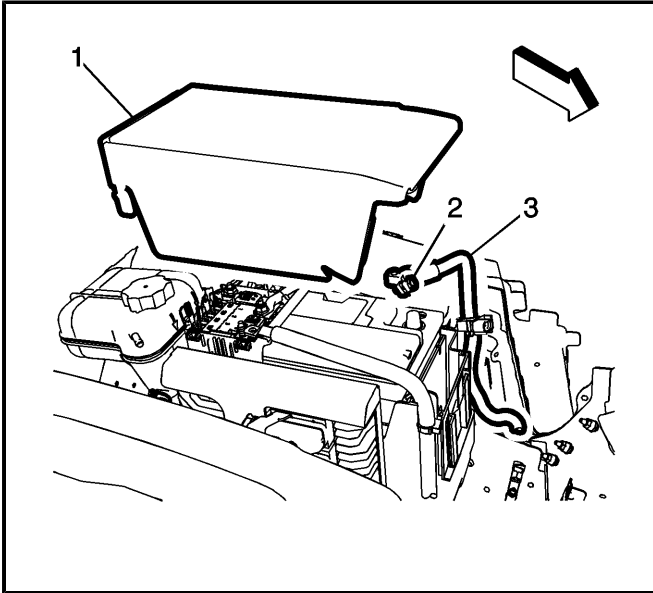

Note Unless directed otherwise, the ignition and start switch must be in the OFF or LOCK position, and all electrical loads must be OFF before servicing any electrical component. Disconnect the negative battery cable to prevent an electrical spark should a tool or equipment come in contact with an exposed electrical terminal. Failure to follow these precautions may result in personal injury and/or damage to the vehicle or its components.

Record radio and engine oil life presets.

2. Turn off all lamps and accessories.
3. Place the ignition switch in the OFF position.
4. Remove the battery cover (1).
5. Loosen negative battery terminal fastener (2), and remove negative battery cable (3) from battery.

Remove Front Floor Console

1.

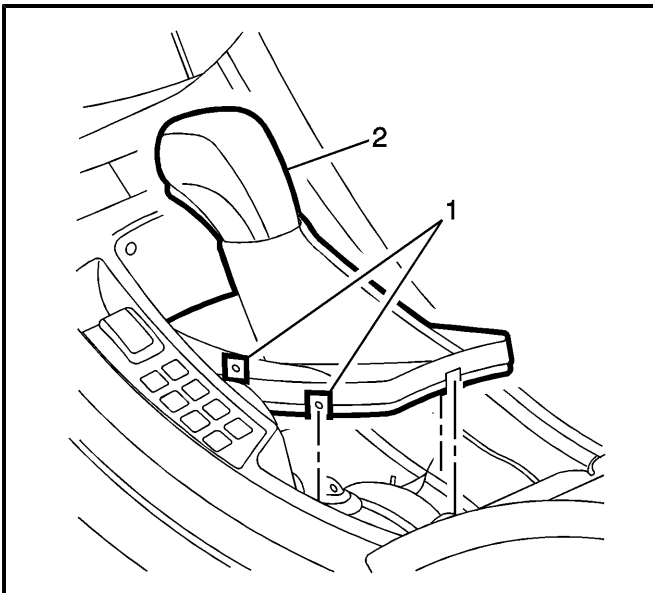

Note Apply protective tape to the console around the shifter trim plate to prevent scratching.

Note The control lever boot and knob are removed as an assembly.

part numbers: 20989178 / 20989180

Using a flat-bladed plastic trim tool, release the retainer clips (1) securing the control lever boot.

2. Pull upward and twist control lever knob (2) and remove boot assembly.

3.

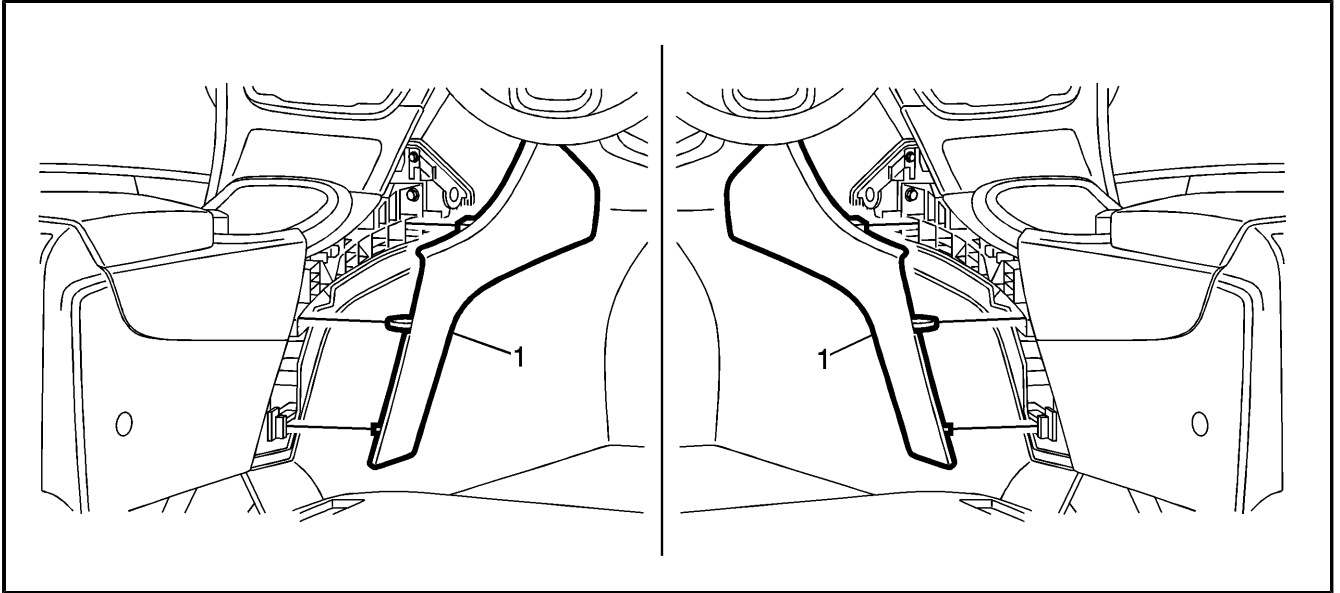

Grasp the extension panels (1) and pull outward to disengage the retainer clips securing the panels to the front floor console.

4.

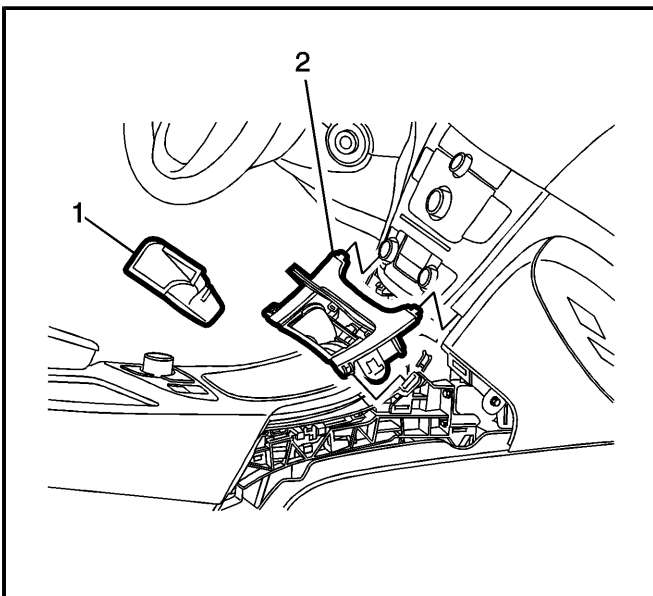

Remove ashtray (1) from ashtray housing.

5. Using a flat-bladed plastic trim tool, release the I/P ashtray housing (2) from the instrument panel.

6. Disconnect electrical connections.

part numbers: 20989178 / 20989180

7.

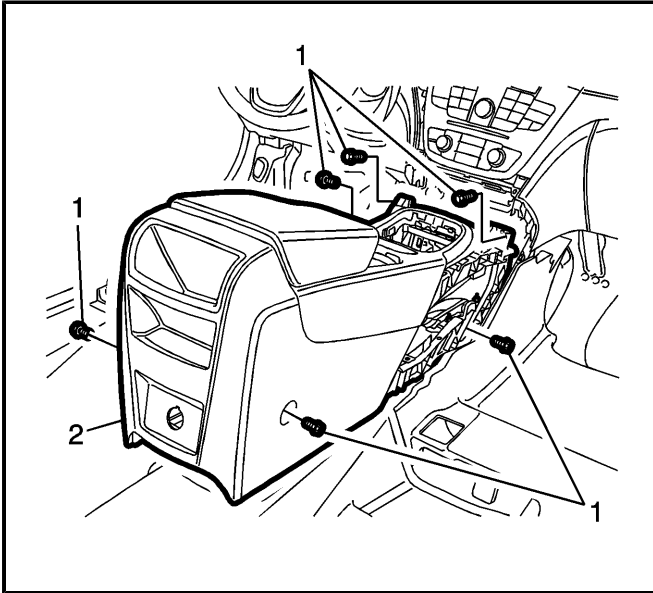

Move the front seats forward or rearward in order to access the fasteners (1) for removal.

8. Disconnect electrical connections and front HVAC duct.
9. Remove front floor console (2) from vehicle.
10. Remove rear air duct from front floor console.

Remove Front Floor Console Cup Holder

1.

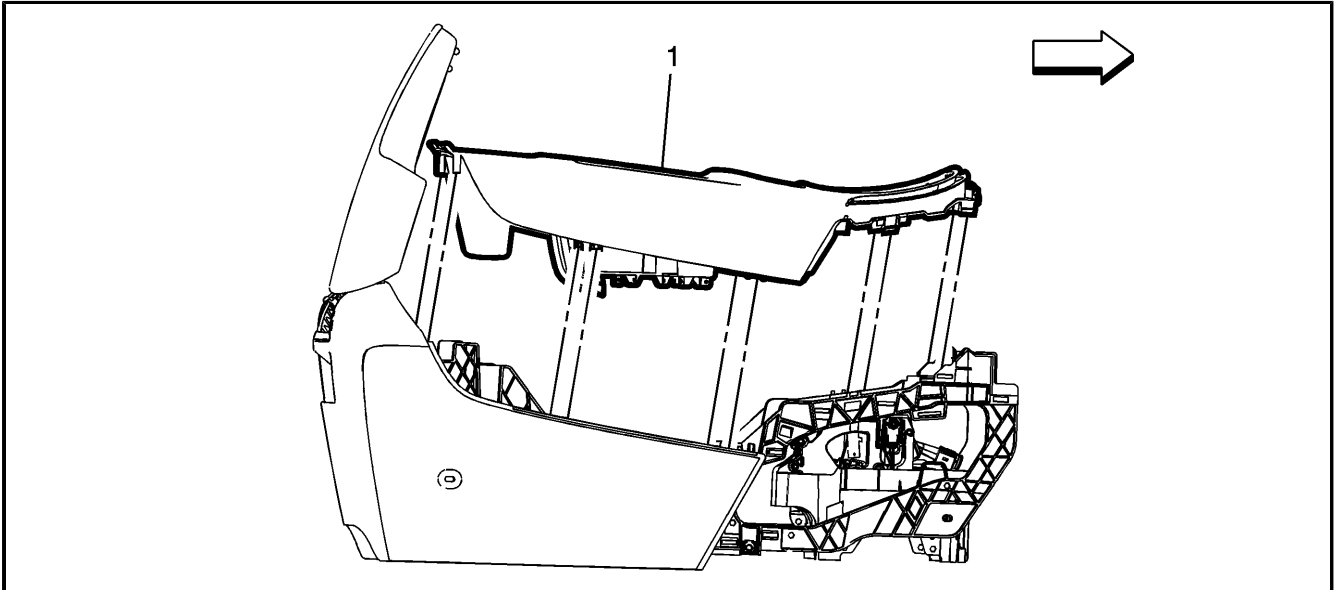

Position the front floor console armrest in the full upper position.

2. Remove the front floor upper console trim panel assembly (1), by lifting upward in order to release the retainers.
3. Disconnect electrical connections from front floor upper console trim panel.

part numbers: 20989178 / 20989180

4.

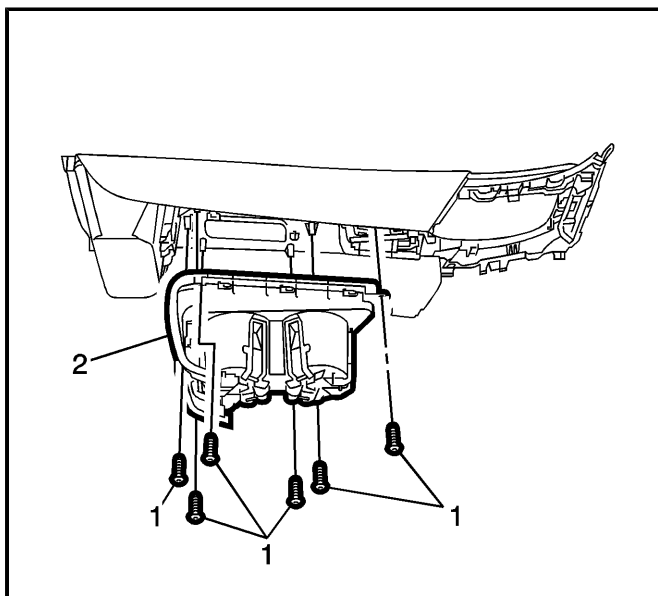

Remove the fasteners (1) from the front floor console cup holder.

5. Remove the front floor console cup holder (2) from upper console trim panel.

Install Cupholder Lamps

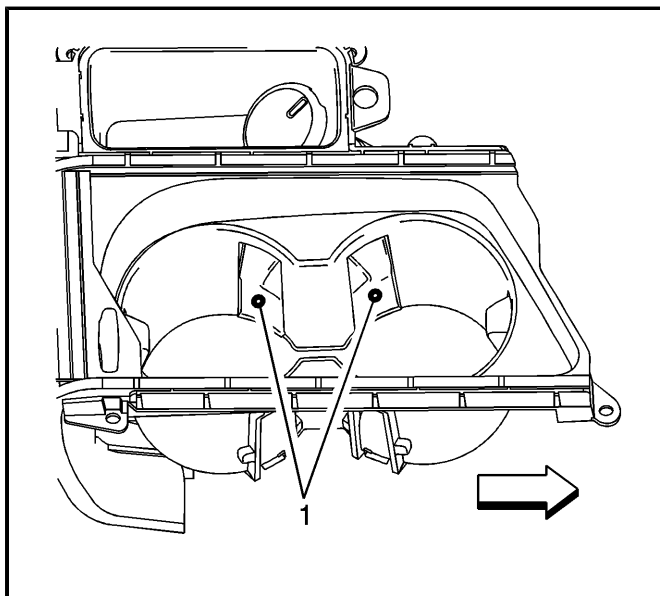

Note Both LED's are to be mounted in the side wall (1) of each cupholder, on the side of the auxiliary power outlet (left side of the cupholder inset).

1.

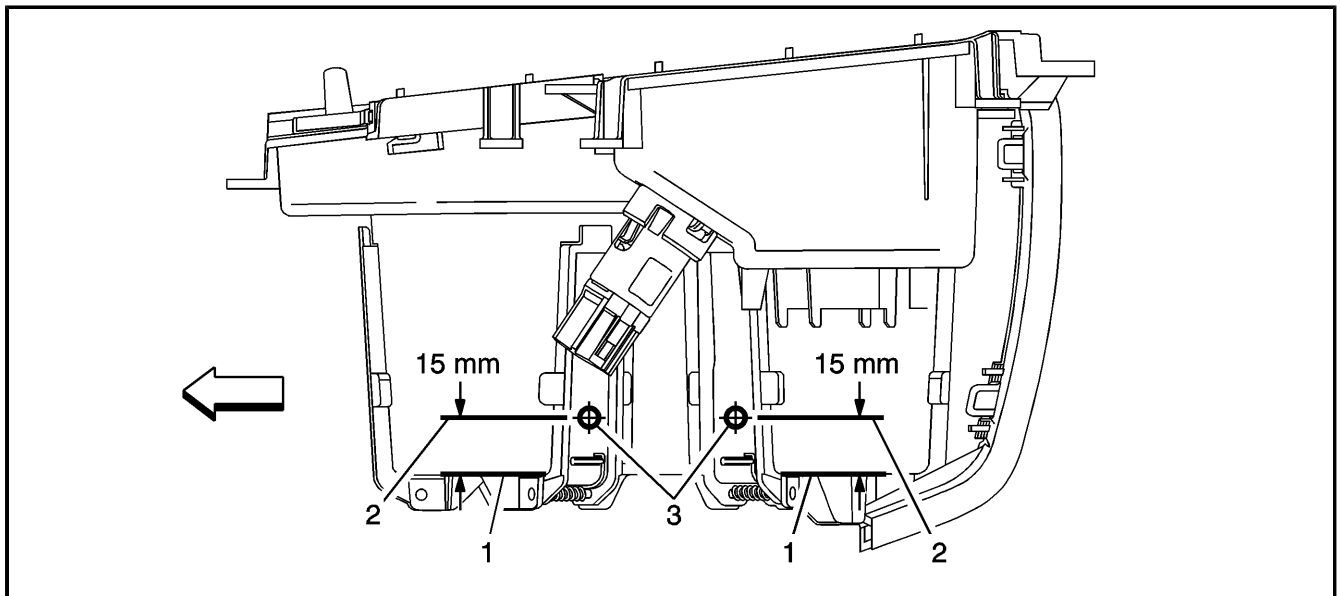

Lay the cupholder insert on its right side and locate the flat vertical ribs on the outside wall of each cup (where the cup retaining springs are mounted).

2. Using the bottom of each cup (1) as a starting point, measure 15mm up (2) and scribe a mark in the center of each flat rib.
3. Drill pilot holes (3) in both cups using a (1/8") drill bit.
4. **Note** Use caution not to oversize the holes.

Drill a final hole (3) using a (5/16") drill bit.

5.

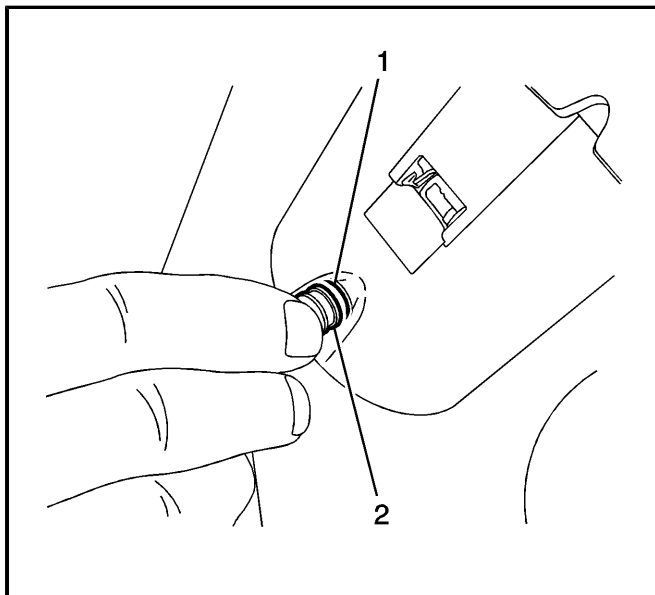

From inside of cupholder, insert a lens (2) through the drilled holes.

Note Leave tape adhesive dot on lens. Install the single harness LED in the rear cupholder and the two harnesses LED in the front cupholder, given that one of the circuit wiring connects to the lighting box.

6. Place serrated washer (1) to outside of cupholder over lens body.
7. From the outside of the cupholder, install the LED's onto the lenses. Turn the LED while holding the lens from the inside. LED's should firmly seat to the cupholder.

part numbers: 20989178 / 20989180

Install Switch

1.

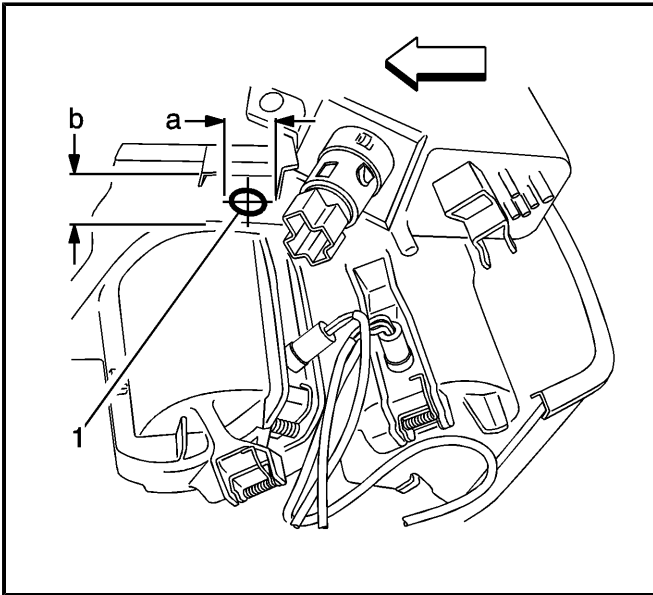

Note The switch will be located on the left side of the cupholders insert, being not visible for the driver, centered in the horizontal distance marked in line (A) and the vertical distance marked in line (B).

Drill pilot hole (1) using a (1/8") drill bit.

2. **Note** Use caution not to oversize holes.

Drill a final hole (1) using a (15/32") drill bit.

3.

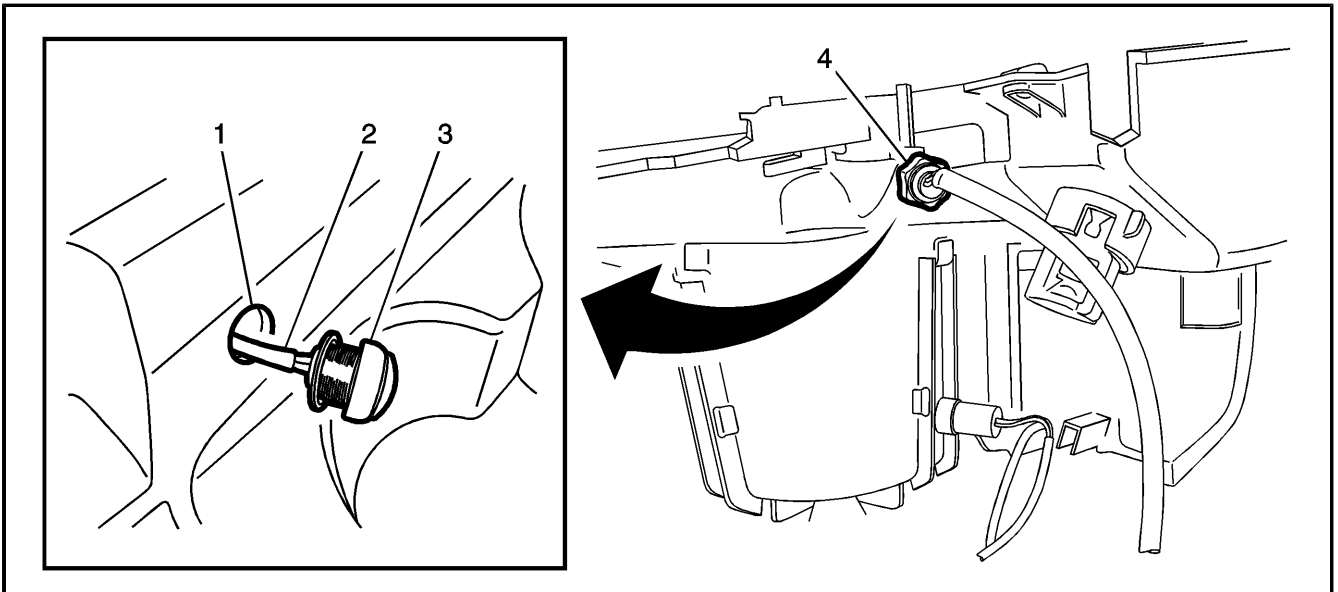

With the LED switch in hand, remove the nut from the switch and wiring pigtail, keep gasket in place on switch.

4. Insert the switch wiring (2) and switch (3) through the hole (1).

5. Attach nut (4) to the backside of switch and securely tighten the switch to the cupholder. Use wrench to snug the nut.

part numbers: 20989178 / 20989180

6.

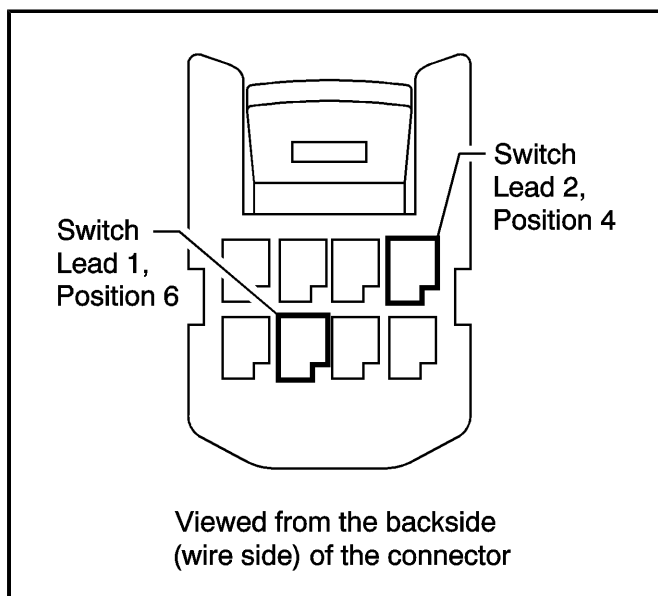

Insert bare terminals on ends of switch harness into cavities 4 and 6 of the WHITE 8-pin spare connector included in the switch package. Press down on the TPA on the top of the connector body to lock the terminals into the connector. Refer to connector cavity number as shown for proper terminal location.

Note Either WHITE wire can be inserted into either cavity.

7.

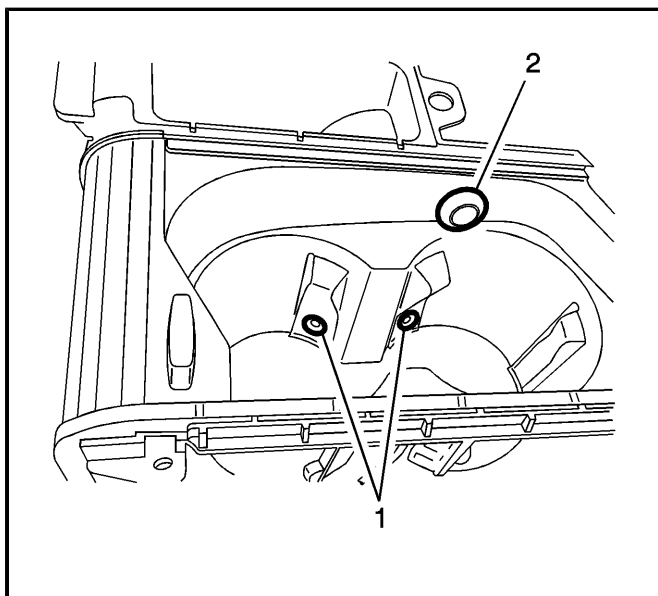

Once installed, this is how the cupholder LED's (1) and switch (2) should look.

Install Power Harness

part numbers: 20989178 / 20989180

1.

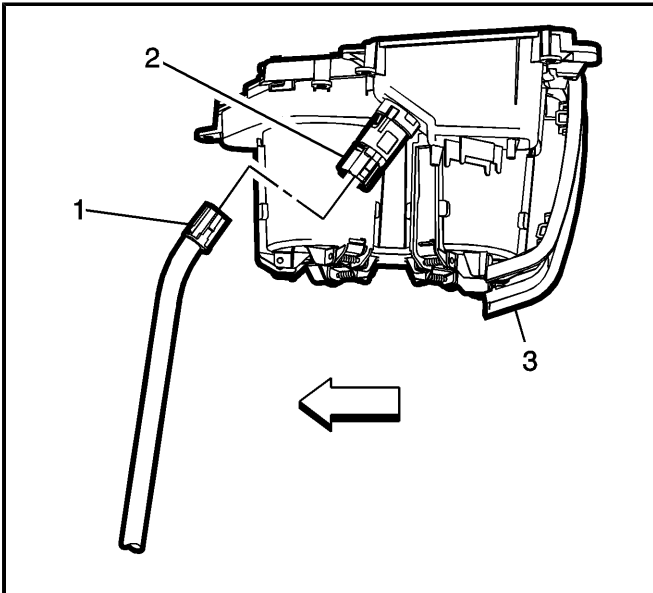

Position the center console cupholder insert (3) on its right side.

2. Disconnect the power harness connector (1) from the auxiliary power outlet connector (2).

3.

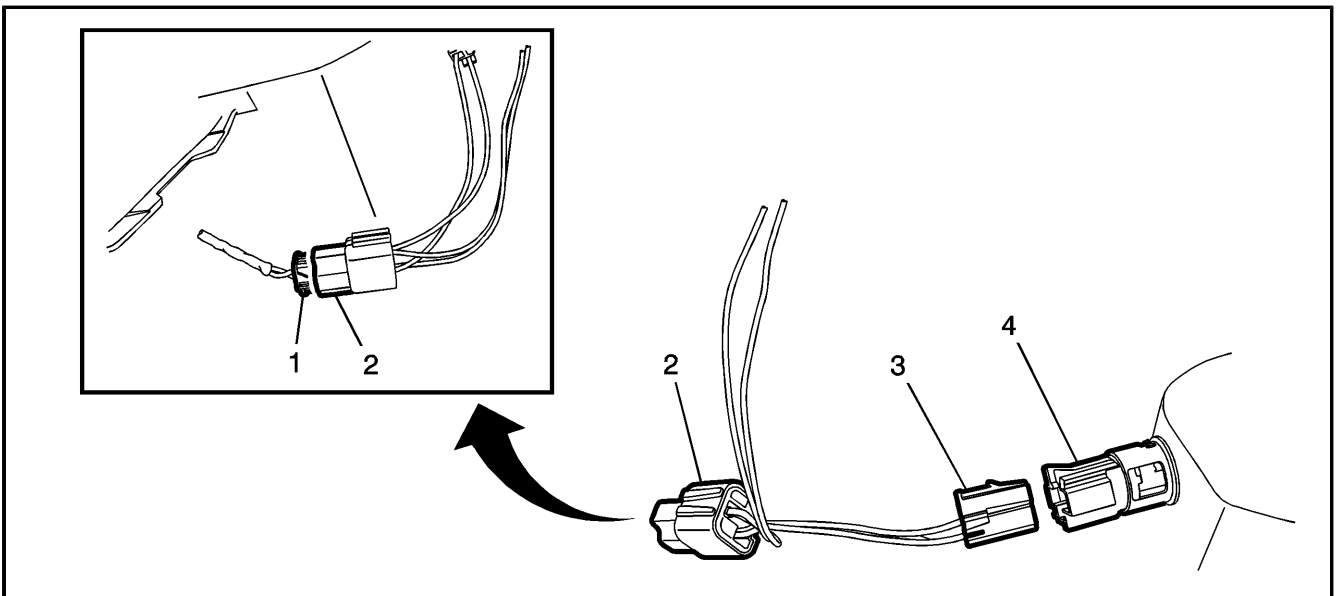

Connect the power harness connector (3) to the auxiliary power outlet (4)

4. Connect the power harness connector (2) to the auxiliary power outlet harness connector (1).

5. Install front floor console cupholder to the front floor upper console trim plate.

6. **Note** Properly route the harness to eliminate pinching/chaffed wires.

Install front floor upper console trim plate to front floor console.

part numbers: 20989178 / 20989180

7.

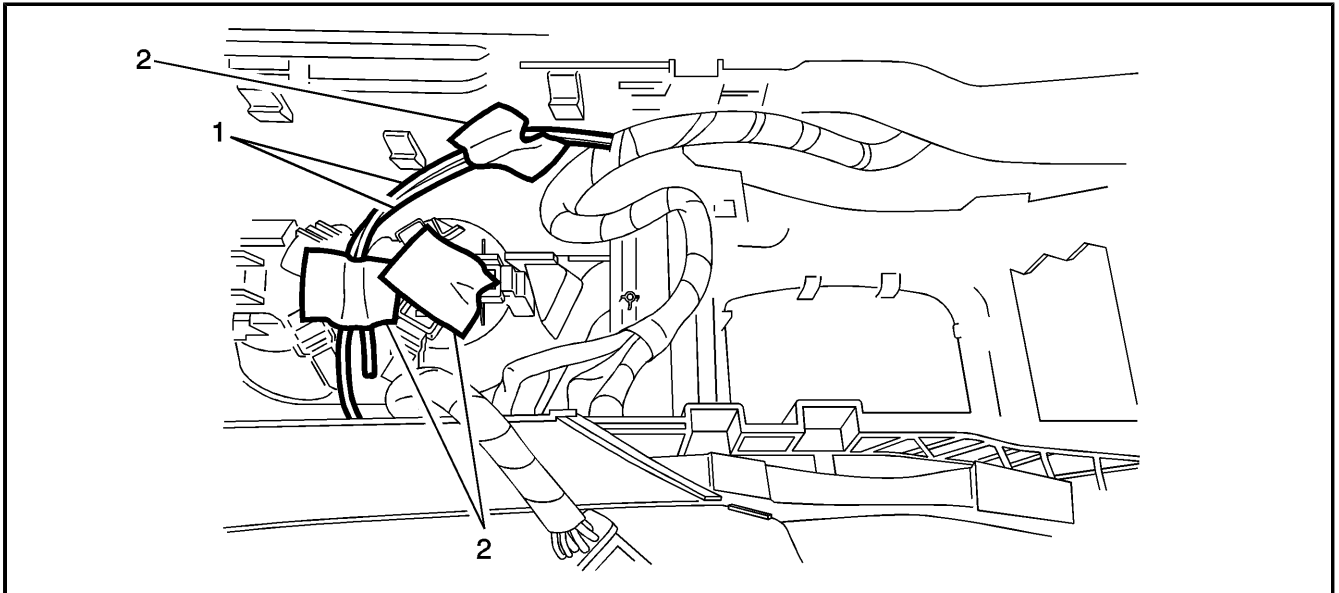

From the underside of front floor console, route the power harness, switch harness and cupholder LED harnesses (1) on the bottom surface of the cupholders, then along the inside surface of the console and secure with adhesive pads (2).

Installation of Footwell Lighting

Install Right Side Illuminator

1.

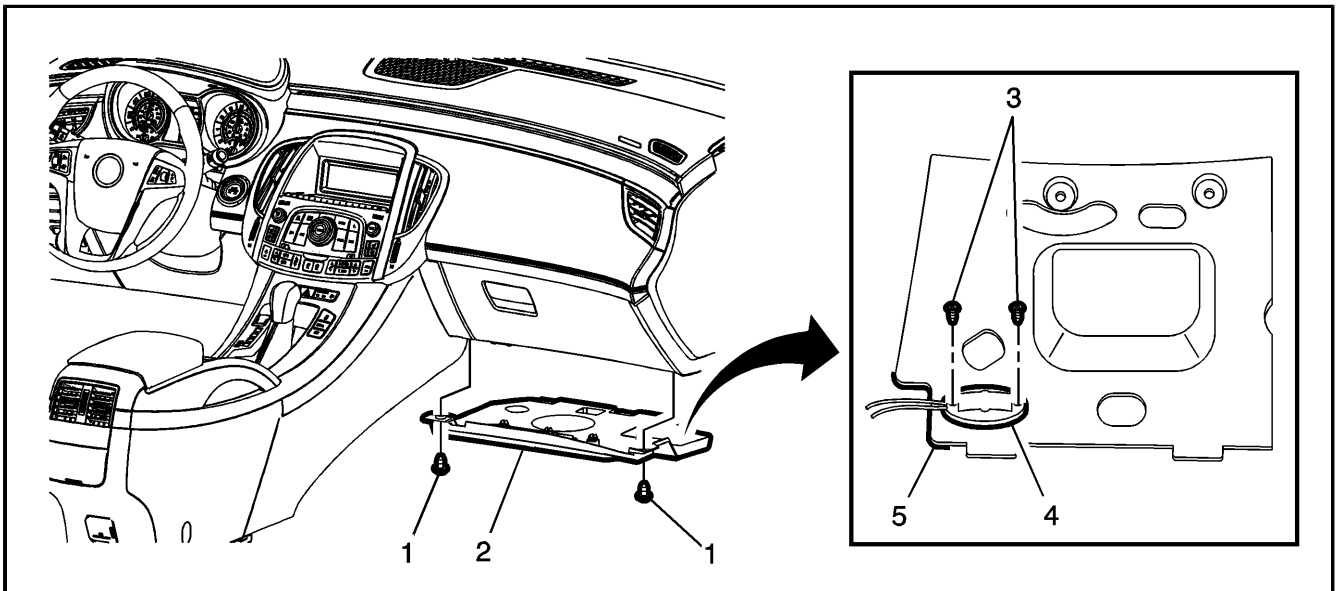

Remove the screws (1) from the right side instrument panel sound insulator (2). Remove the sound insulator panel (2).

2. Route the wiring harness/illuminator assembly (4) through the edge (5) in the insulator panel.
3. Clean the area to remove grease and wax where illuminator (4) will be mounted.
4. Using the pull-tab, remove the tape liner from the back of the illuminator (4).

Note Avoid finger contact with the adhesive surface.

5. Firmly press the illuminator (4) to the insulator panel to secure.
6. Secure the illuminator (4) to the panel using the two self-tapping screws (3).

part numbers: 20989178 / 20989180

7. Install the insulator panel.
8. Route the left side illuminator under the center of the IP toward the left side insulator panel.
- 9.

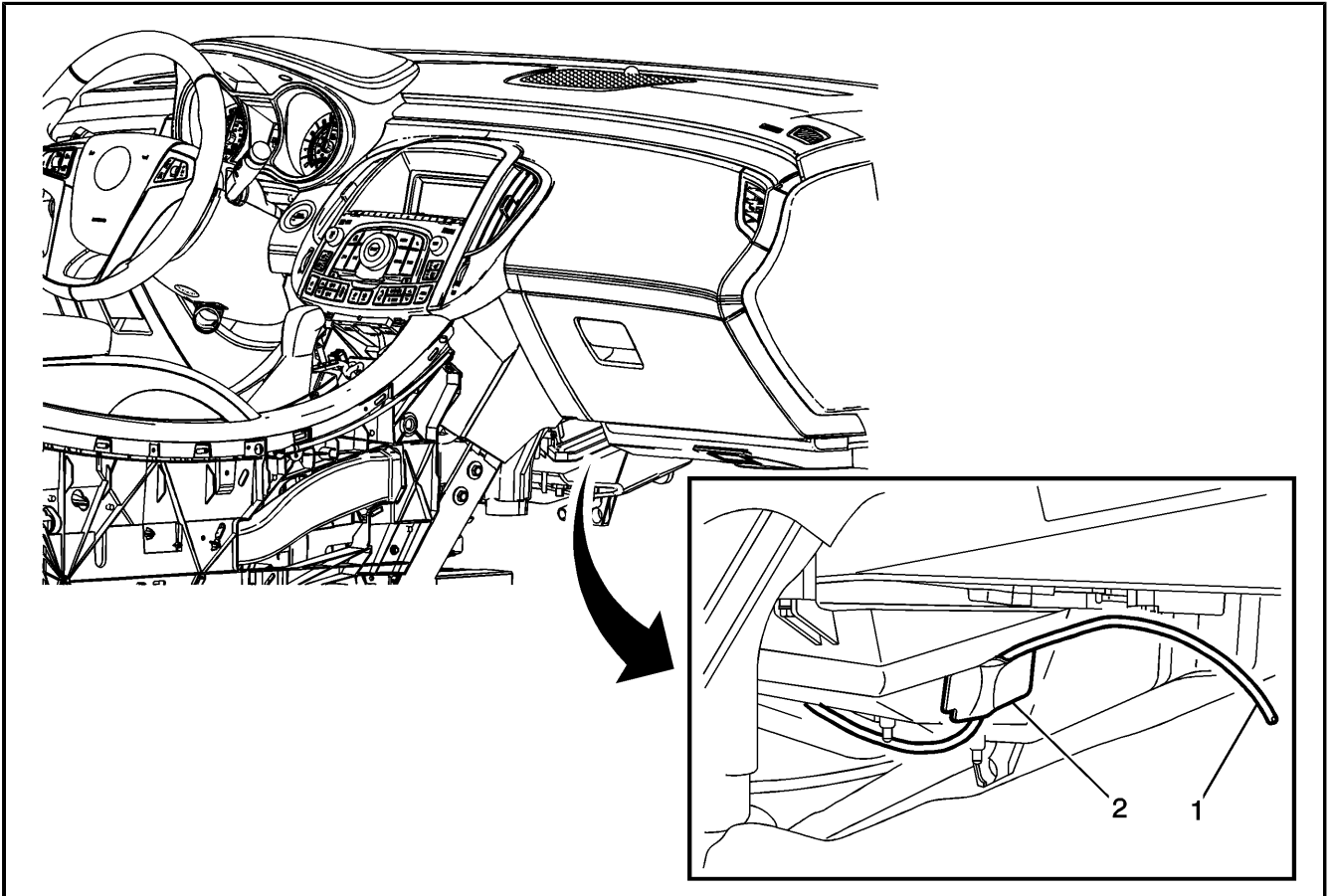

Secure wiring harness (1) to evaporator drain box with adhesive foam pad (2).

Install Left Side Illuminator

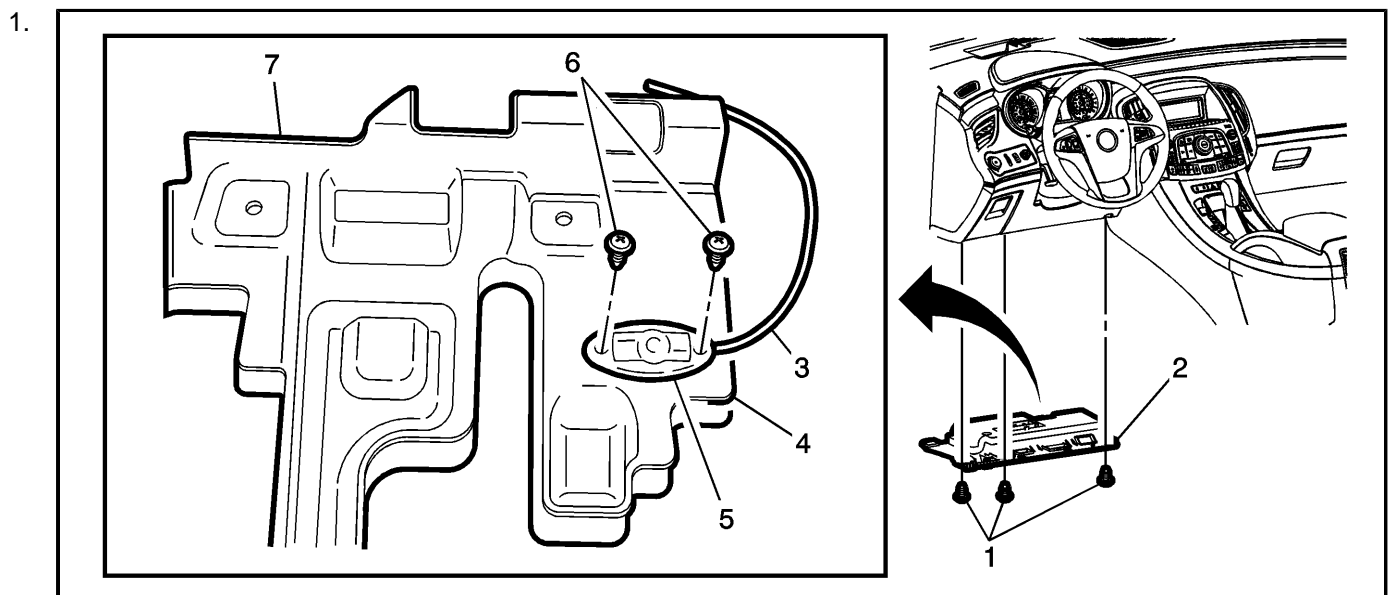

Remove the screws (1) and partially lower the left side instrument panel sound insulator (2).

2. Route the wiring harness/illuminator assembly (5) through the edge (4) in the insulator panel.

part numbers: 20989178 / 20989180

3. Clean the area remove grease and wax where illuminator (5) will be mounted.
4. Using the pull-tab, remove the tape liner from the back of the illuminator (5).

Note Avoid finger contact with the adhesive surface.

5. Firmly press the illuminator (5) to the insulator panel (7) to secure.
6. Secure the illuminator (5) to the panel using the two self-tapping screws (6).
7. Secure the wiring harness (3) by wrapping a foam pad around sound proofing and secure with cable tie.
8. Install the insulator panel.
- 9.

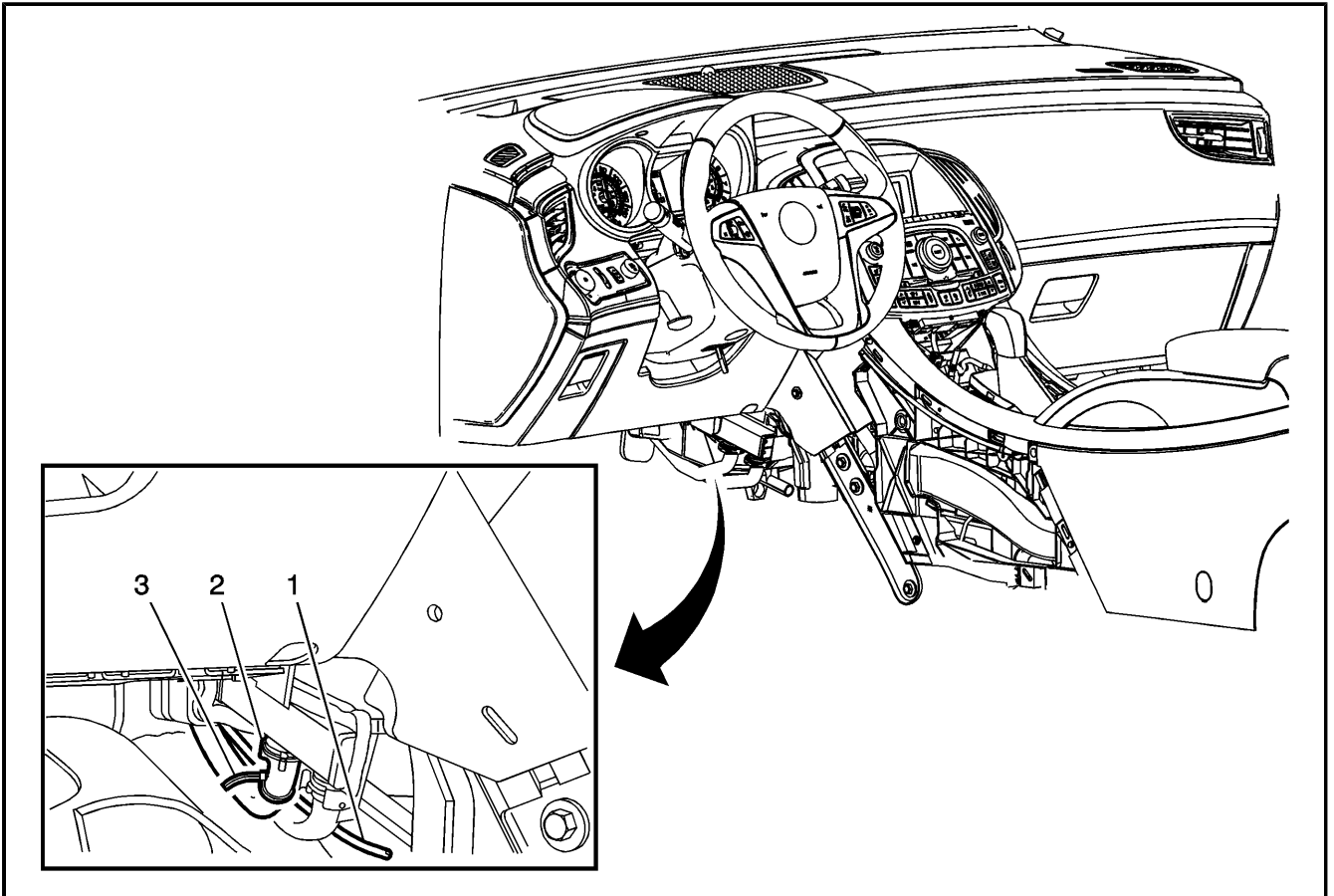

Secure wiring harness (1) with cable tie (3) to coolant line (2).

Install Lighting Control Module

1. Finish routing the following harness connectors toward the right side metal instrument panel support leg:
 - Power/ground harness
 - Cupholder lamp harness
 - Switch harness
 - Footwell lamp harness (if installed)
2. Connect all connectors to the lighting control module.
3. Connect negative battery cable and place ignition on (engine off) position. Test the system functionality before mounting the control module.

Note Refer to owner's manual card.

part numbers: 20989178 / 20989180

4.

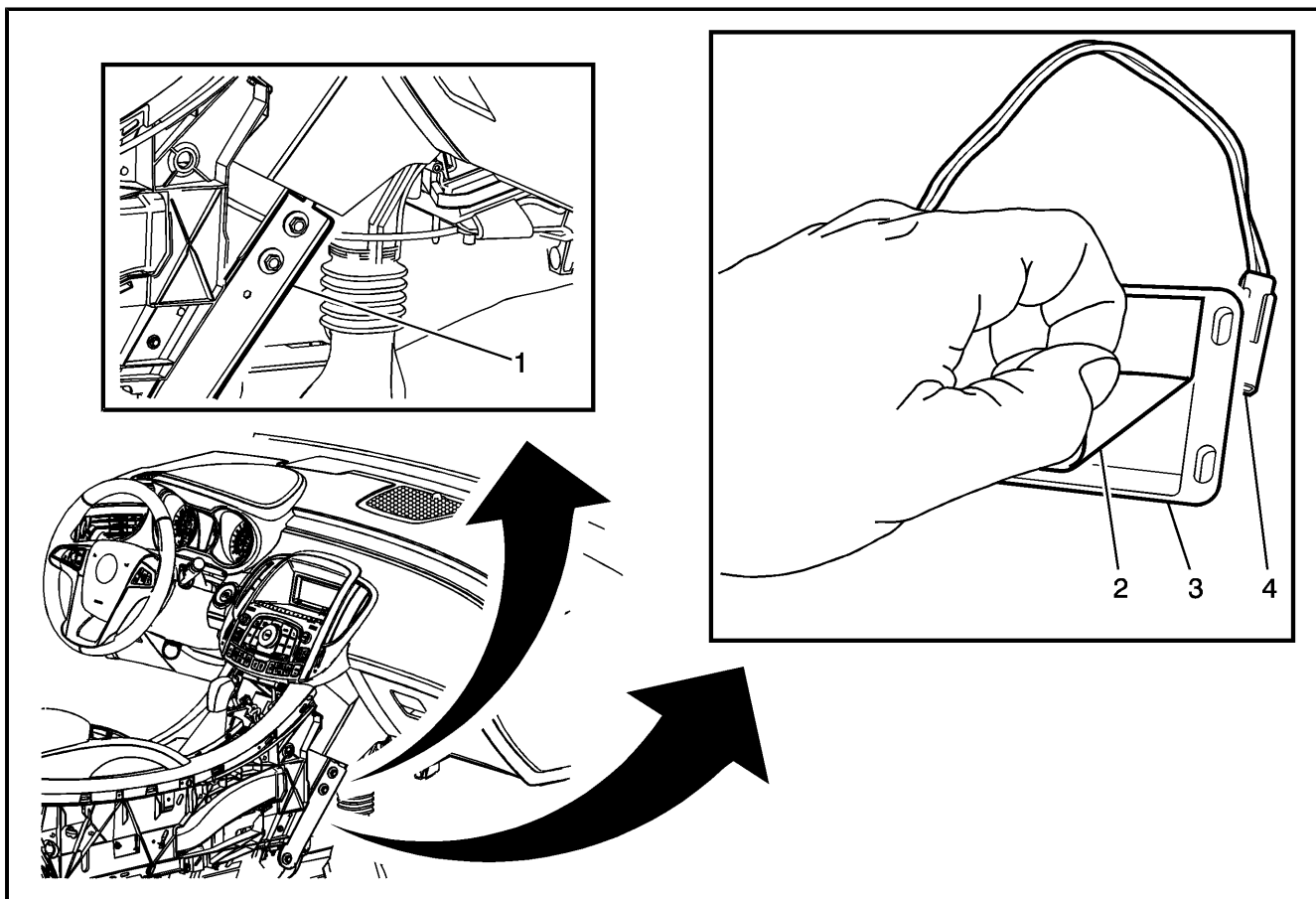

Inspect and clean the inside surface of the right side metal instrument panel support leg (1) using a clean cloth and alcohol.

5. Remove adhesive liner (2) from the control module (3).
6. Carefully position the control module (3) into position with connectors facing down (4).

Note Mount the module (3) so it is perpendicular to the leg.

7. Firmly press the module (3) onto inside surface of support leg (1).

Reassemble Vehicle

1. Reinstall the front floor console assembly and previously removed trim components.
2. Test the LED lighting system per owner's manual instructions.