

D	Änderungen bezüglich Konstruktion, Ausstattung, Farbe sowie Irrtum vorbehalten. Angaben und Abbildungen unverbindlich.
GB	Subject to change in terms of construction, equipment and colour, and may contain errors. The information and illustrations are non-binding.
F	Sous réserve de modifications de la construction, de équipement, de la couleur et sous réserve d'erreurs. Les indications et les illustrations sont sans engagement.
NL	Wijzigingen met betrekking tot constructie, uitvoering en kleur evenals vergissingen voorbehouden. Gegevens en afbeeldingen niet bindend.
DK	Ændringer med hensyn til konstruktion, udstyr, farver samt fejl forbeholdes. Oplysninger og illustrationer er uforpligtende.
N	Endringer angående konstruksjon, utstyr, farge og feiltagelse forbeholdes. Opplysninger og illustrasjoner uforbindtlig.
S	Med reservation för ändringar vad det gäller konstruktion, utrustning, färg samt för misstag. Uppgifterna och bilderna är inte bindande.
FIN	Pidätämme oikeuden rakennetta, varustusta, väriä koskeviin sekä erehdyksestä johtuviin muutoksiin. Tiedot ja kuvat eivät ole sitovia.
I	Con riserva di modifiche relative a progettazione, dotazione, colore ed errori. Le indicazioni e figure sono fornite senza impegno.
E	Reservadas las modificaciones respecto a diseño, equipamiento, color, así como error. Indicaciones y figuras sin compromiso.
P	Reservamos o direito de alterações relativamente ao desenho, equipamento, cor, bem como de erro. Os dados e as gravuras não implicam compromisso da nossa parte.
GR	Διατηρώνουμε κάθε επιφύλαξη ως προς αλλαγές σε σχέση με κατασκευή, εξοπλισμό, διαρρύθμιση, χρωματισμούς και λάθη παραδρομής.
CZ	Změny, týkající se konstrukce, vybavení, barvy, jakož i omyly jsou vyhrazeny. Údaje a vyobrazení jsou nezávazné.
PL	Zastrzega się prawo do zmian dot. konstrukcji, wykończenia, kolorystyki oraz pomyłek. Dane i ilustracje niewiążące.
TR	Tasarım, donanım ve renk bakımından deęişiklik yapma hakkı ve hata ve eksiklik mahfuzdur. Veriler ve resimler baęlayıcı deęildir.
H	A szerkezet, a kivitel és a szín változtatása, valamint a változások joga fenntartva. Az adatok és az ábrák nem kötelező érvényűek.
HR	Pravo promjena u svezi konstrukcije, opreme, boje kao i zabune oridžavamo. Podaci i ilustracije su neobavezne.
BUL	Запазени права по отношение на конструкцията, обзавеждането, цвета и грешки. Данните и изображенията не са обвързващи.
RO	Ne rezervăm dreptul unor modificări ale construcției, dotării, culorii și dreptul la erori. Datele indicate și imaginile sunt orientative.
RUS	Права на внесение изменений относительно конструкции, оснащения, окраски, а также на ошибки сохраняются. Данные и иллюстрации имеют примерный характер.
LT	Pasiliekaama konstrukcijos, įrangos bei reikmenų, spalvos pakeitimų ir klaidų teisė. Duomenys ir iliustracijos neįpareigojantys.
LV	Tiek paturētas tiesības uz konstrukcijas, iekārtu, krāsu izmaiņām, kā arī kļūdīšanās. Dati un attēli bez saistībām.
EST	Konstruktsiooni, varustuse ja vœrvi osas muudatused ning eksimine lubatud. Andmed ja joonised on mittesiduvad.
SLO	Zadržana pravica do sprememb glede konstrukcije, opreme, barve ter pomote. Podatki in slike so neobvezne.
SK	Zmeny, ktoré sa týkajú konštrukcie, vybavenia, farby, ako aj omyly sú vyhradené. Údaje a zobrazenia sú nezáväzné.

D	Einbauanleitung
GB	Installation instructions
F	Consignes de montage
NL	Montagehandleiding
DK	Montagevejledning
N	Monteringsinstruksjon
S	Installationsanvisning
FIN	Asennusohje
I	Istruzioni per il montaggio
E	Instrucciones de montaje
P	Instruções de montagem
GR	Οδηγίες εγκατάστασης
CZ	Návod k montáži
PL	Instrukcja montażu
TR	Montaj talimatı
H	Beépítési útmutató
HR	Upute o ugradnji
BUL	Инструкция за монтаж
RO	Instrucțiuni de montaj
RUS	Инструкция по монтажу и установке
LT	Montavimo informacija
LV	Iemontēšanas pamācība
EST	Paigaldusjuhend
SLO	Navodilo za vgradnjo
SK	Montážny návod

ADAM OPEL AG · D-65423 Rüsselsheim
VAUXHALL, Griffin House, Luton LU1 3YT, England

B24 9202 68 05/04

Vectra F68 / F69 - Vectra Caravan F35 - Signum F48

F68 / F69

93 160 447

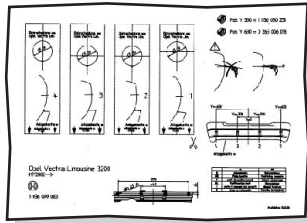
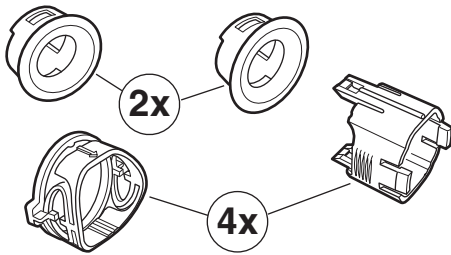

93 160 432

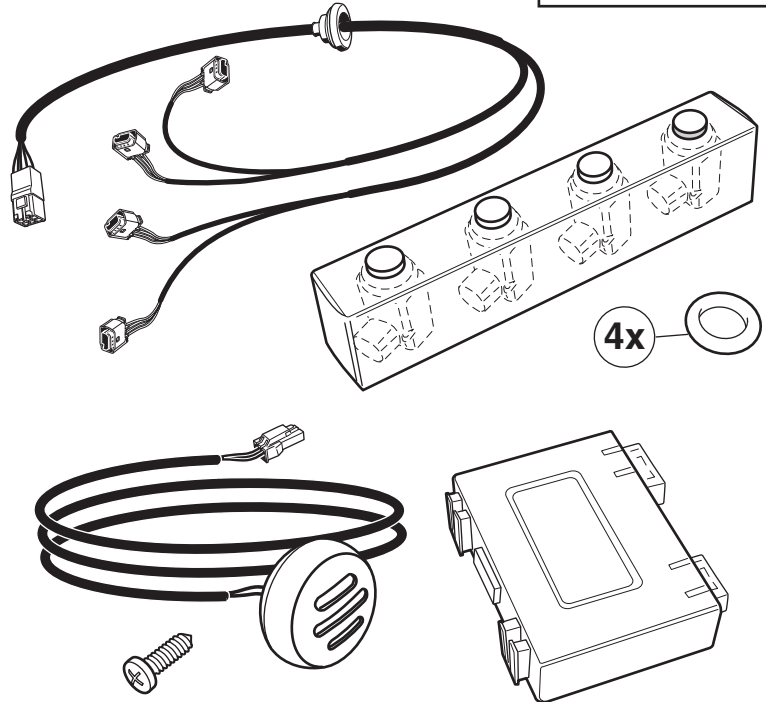

F48

93 160 919

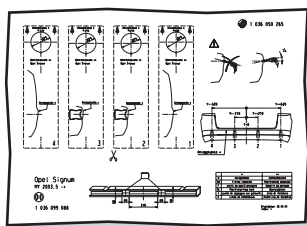
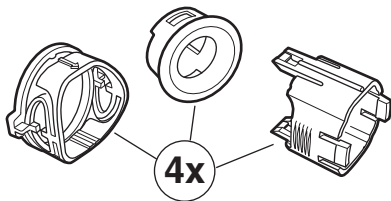

F35

13 100 341

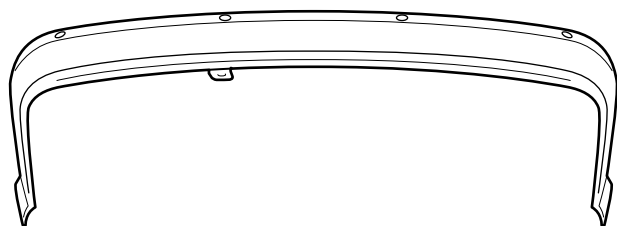

93 173 965

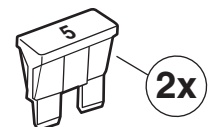

8 / 10 / 13 mm



TORX 20/25



Ø 2 / 3,3 / 12 / 24 / 29 mm

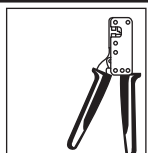
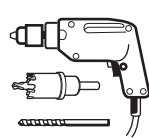

MKM-923

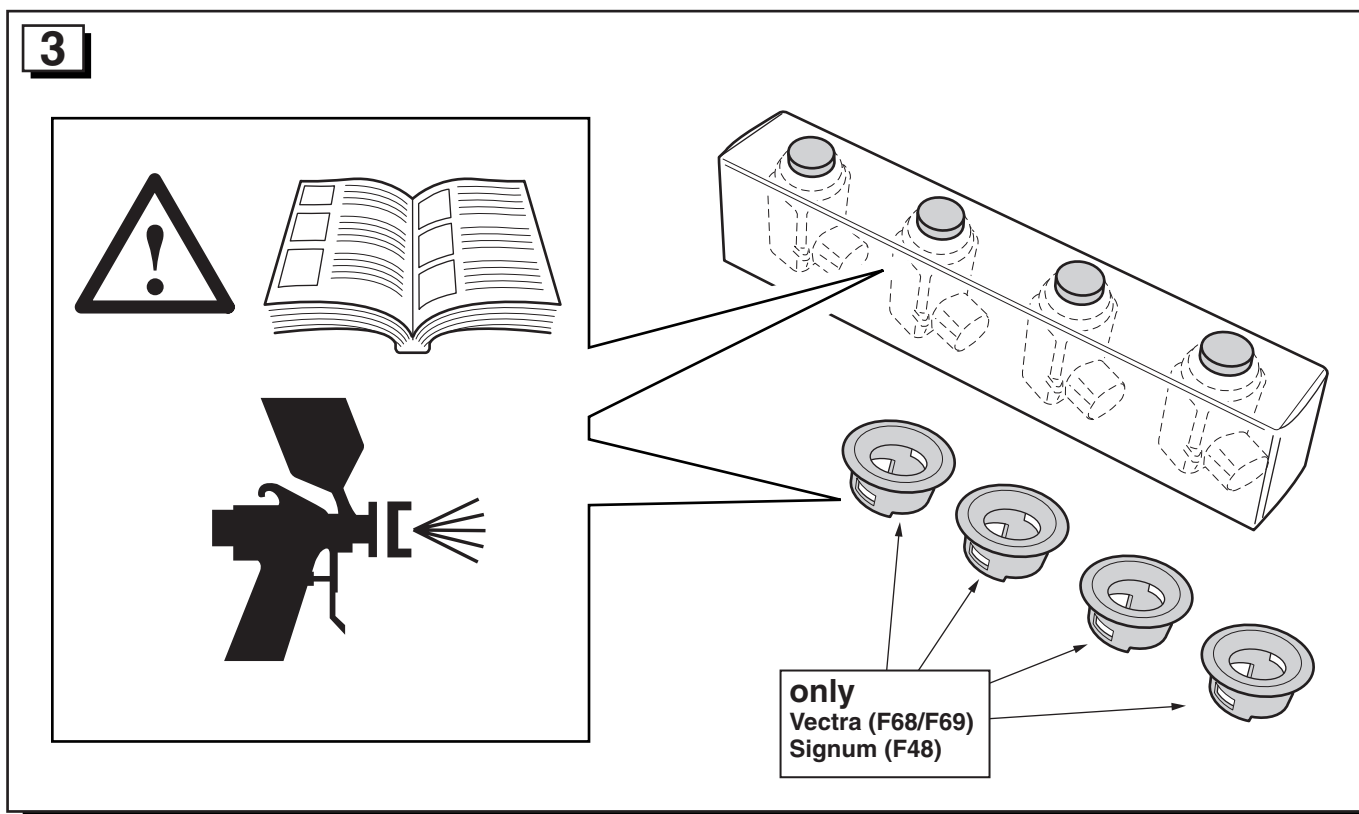
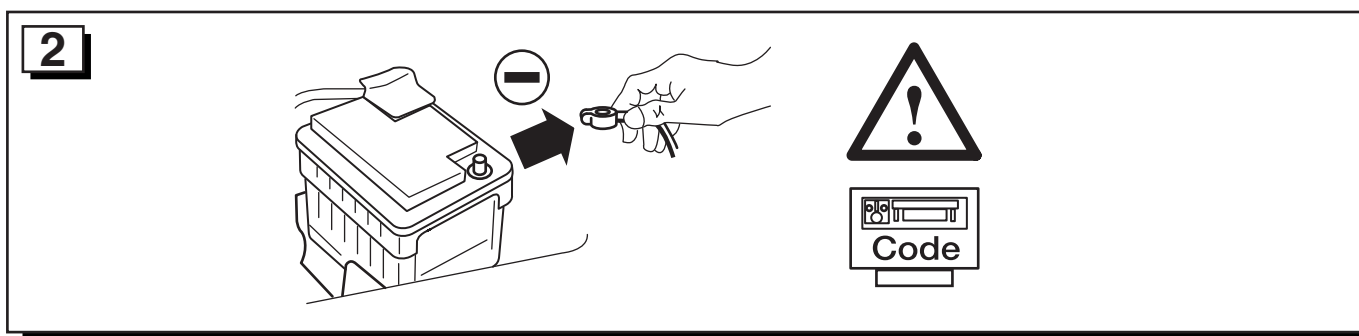
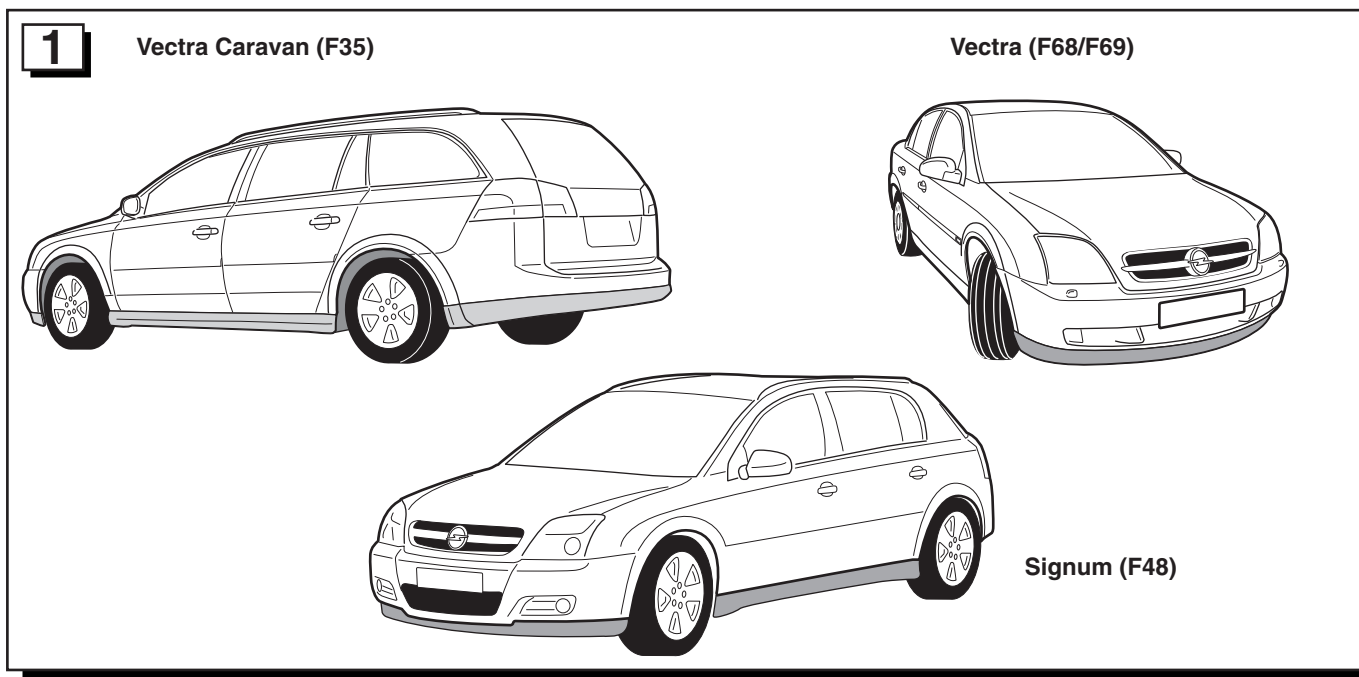

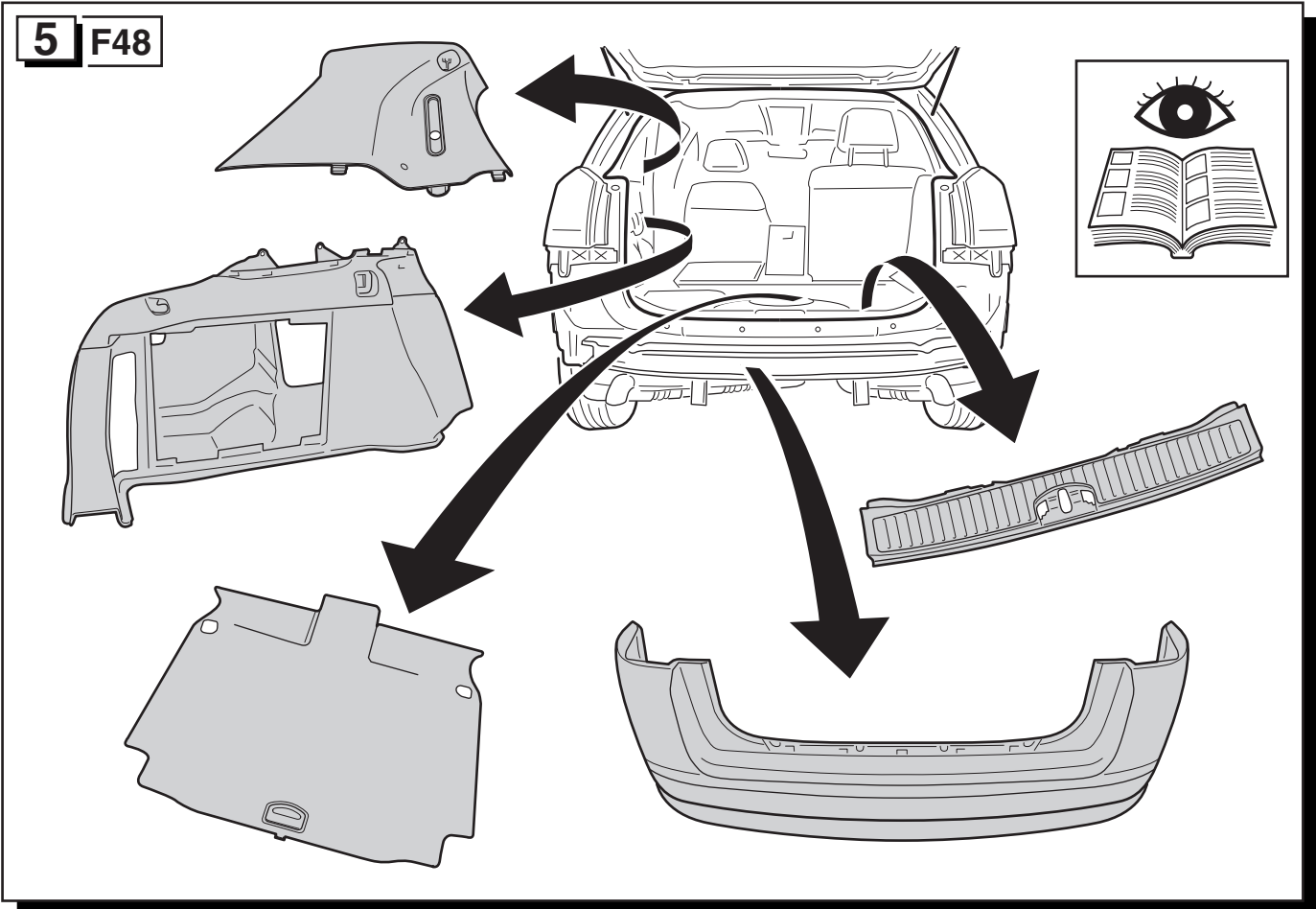
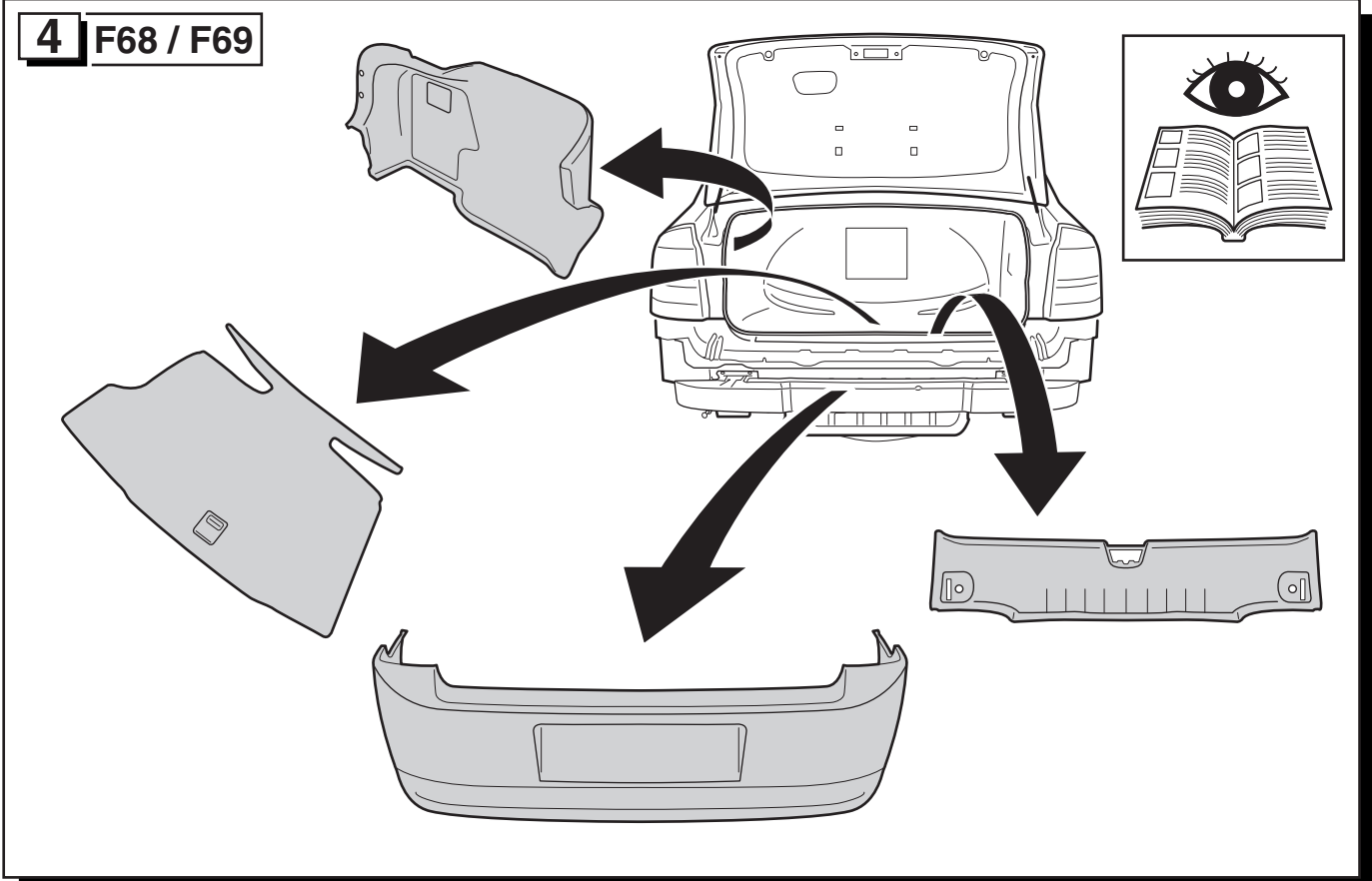

6 F35

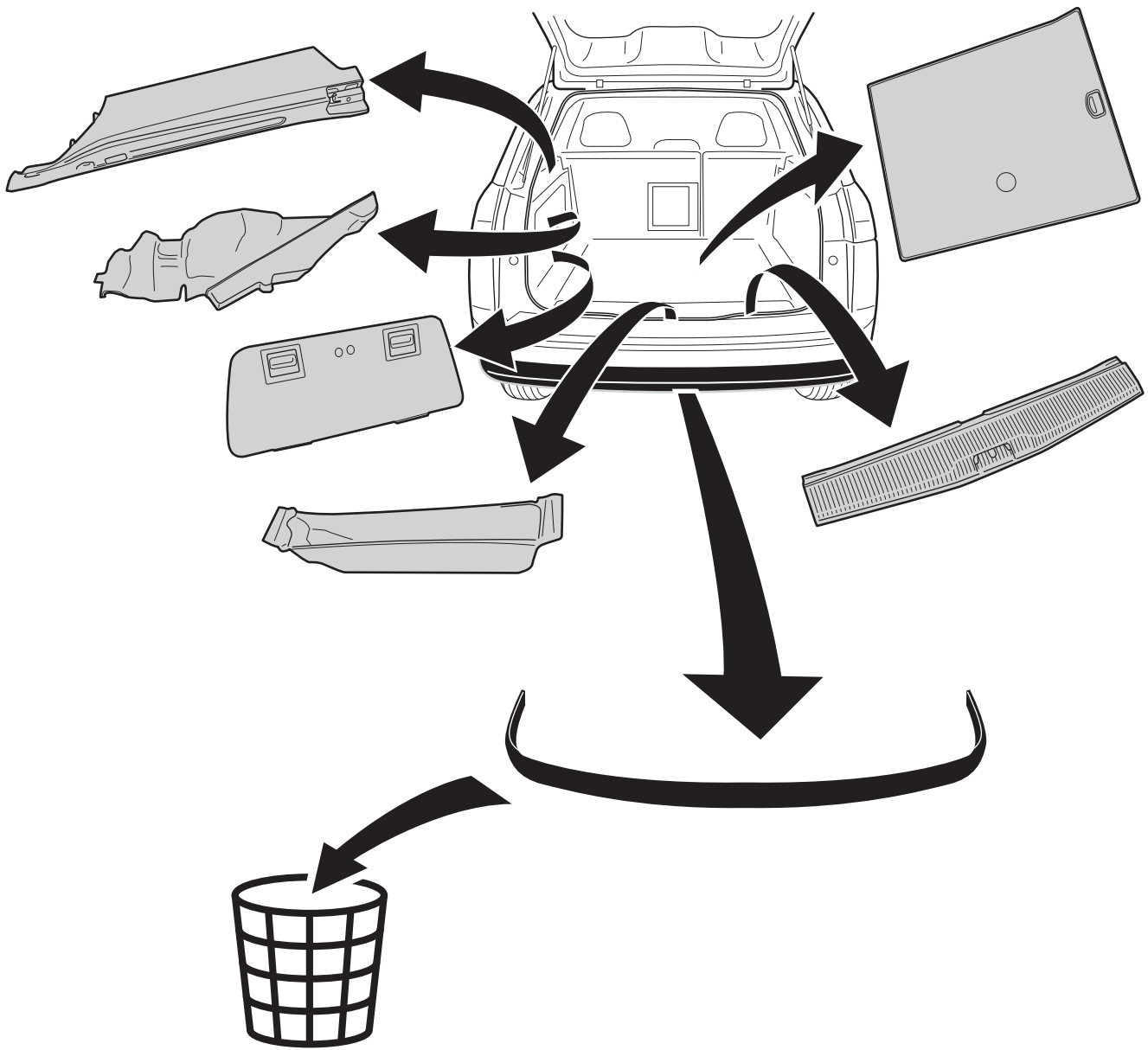

7 F68 / F69

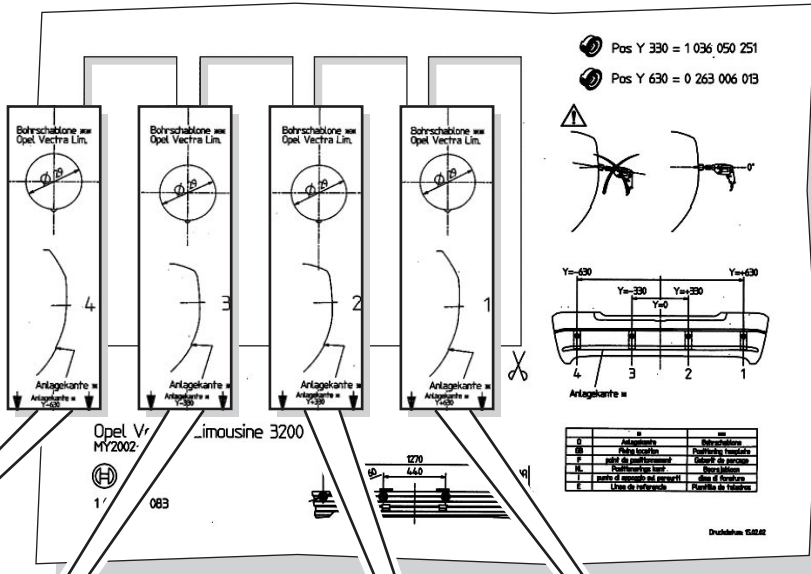
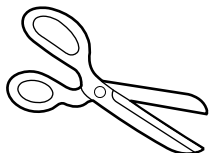

- ⊕ Pos Y 330 = 1 036 050 251
- ⊕ Pos Y 630 = 0 263 006 018

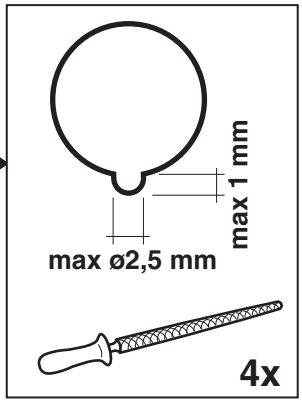
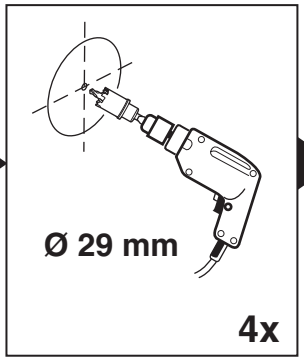
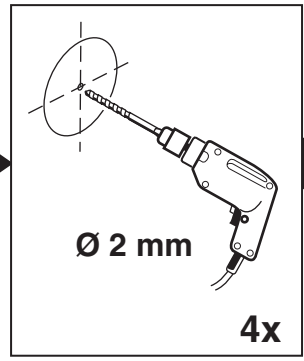
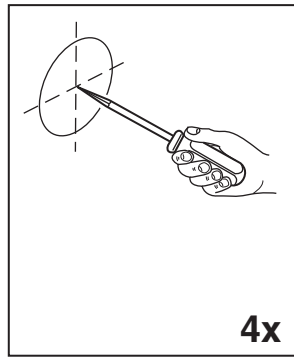
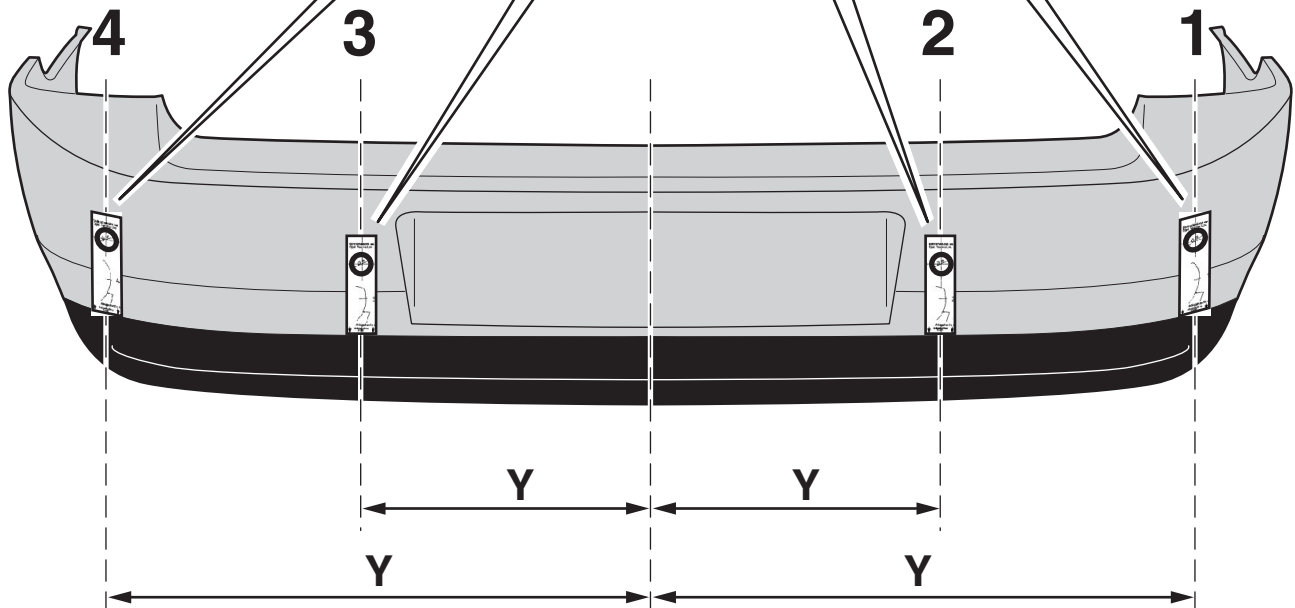
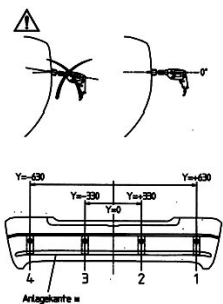

8 F48

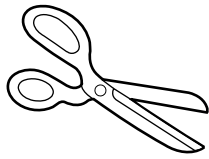

1 036 050 265

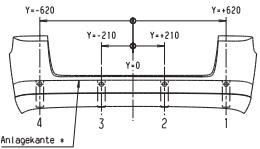

	D	**
	Anlagekante	Bohrschablone
Ø	Fixing location	Positioning template
F	Point of positioning	Center of passage
N	Positioning mark	Bohrschablone
I	Point of support on part	Line of fracture
E	Line of reference	Frattura di separazione

Druckdatum: 26.04.04
Index: 1

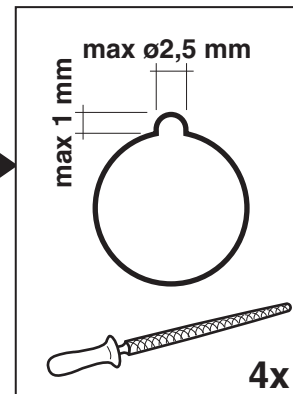
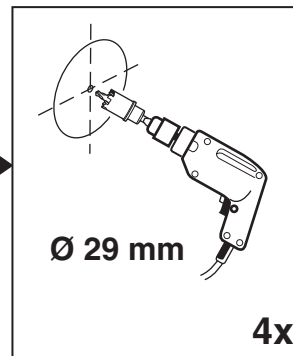
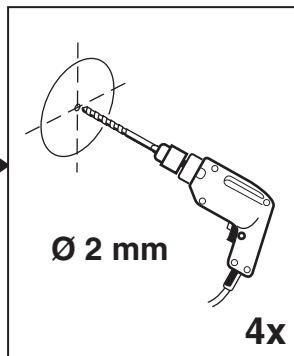
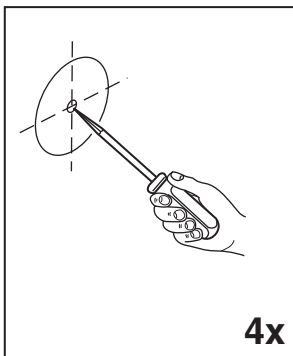
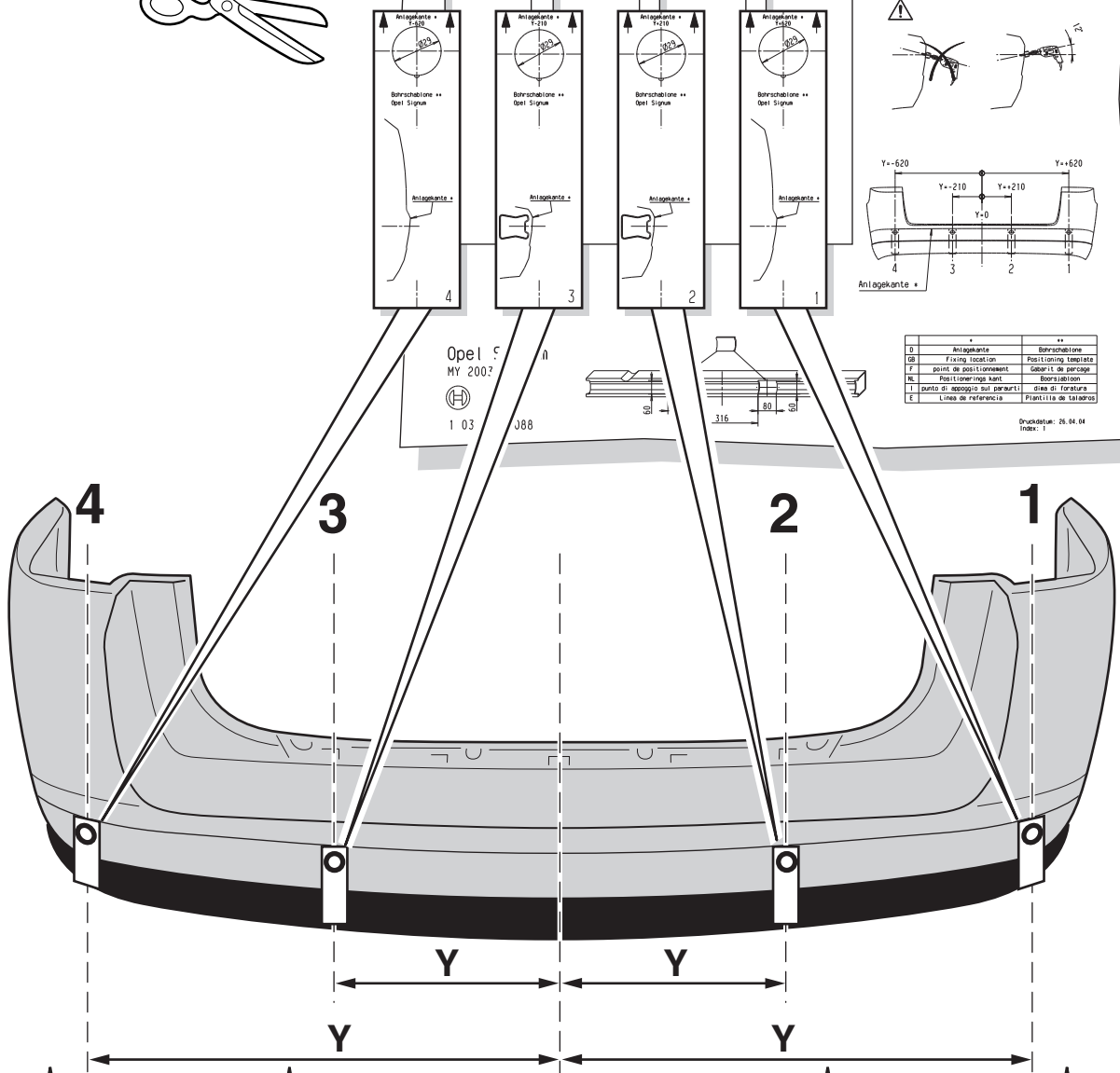

9 F68 / F69 / F48

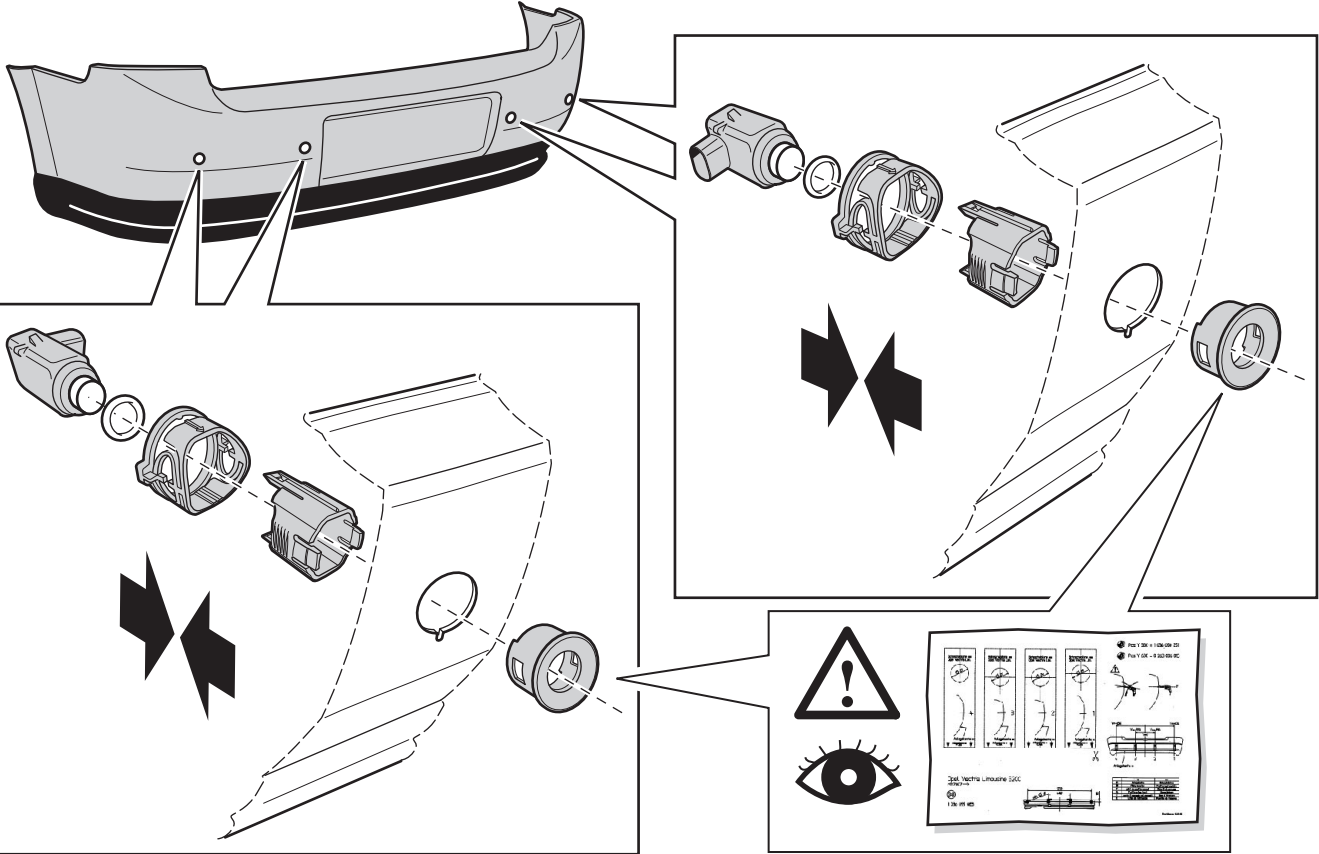

10 F35

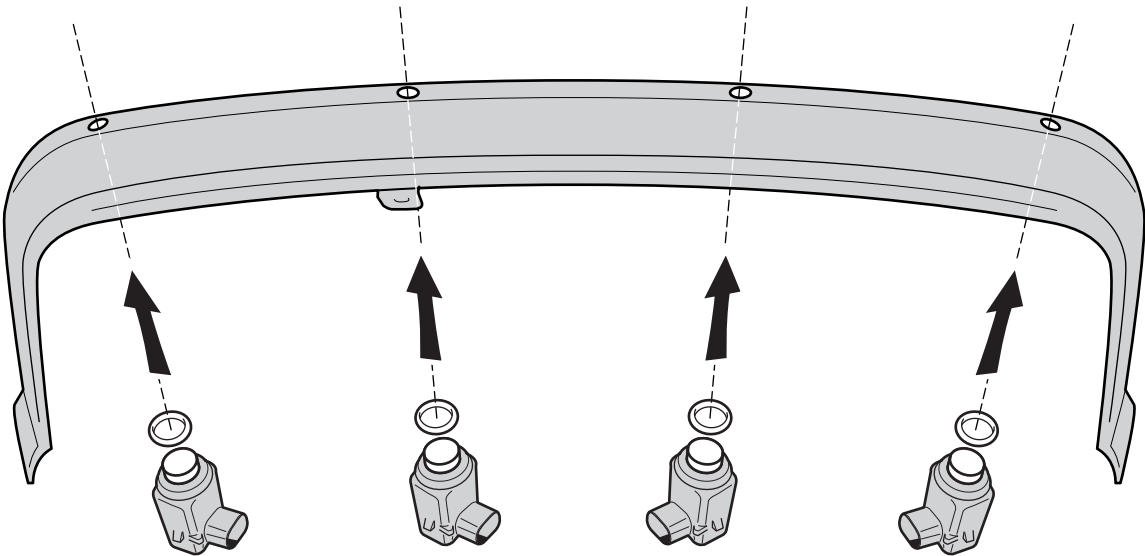

11 F68 / F69

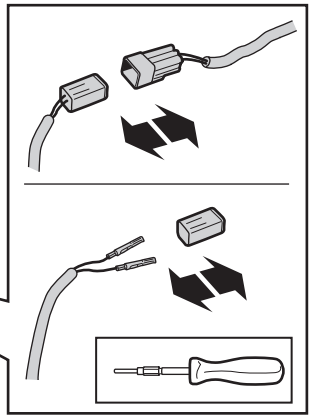
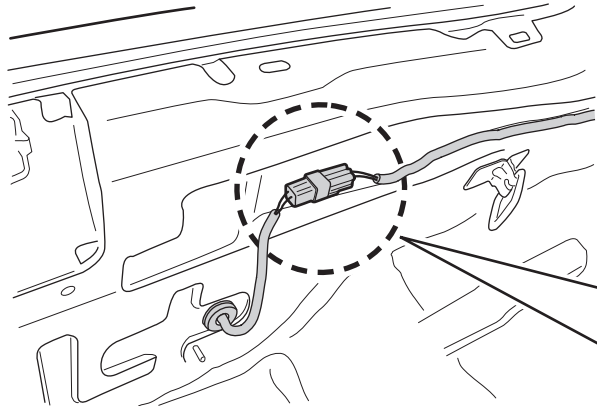
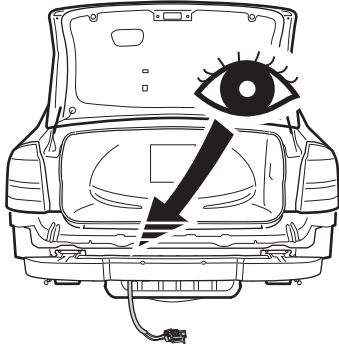

12 F68 / F69

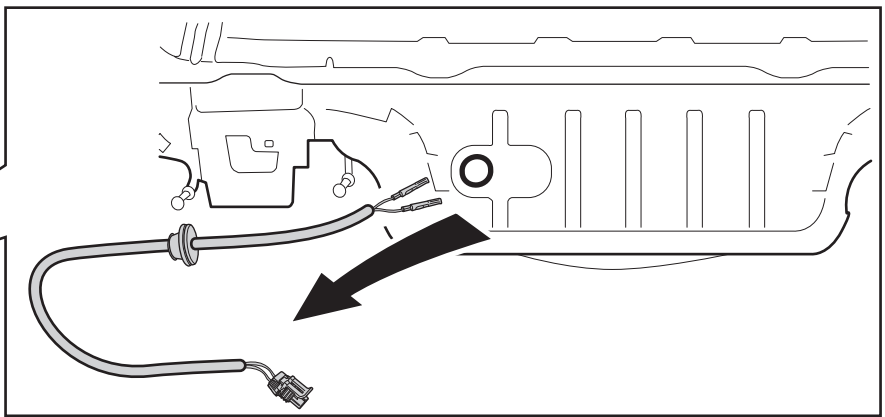
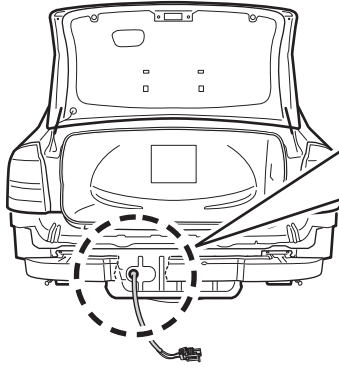

13 F68 / F69

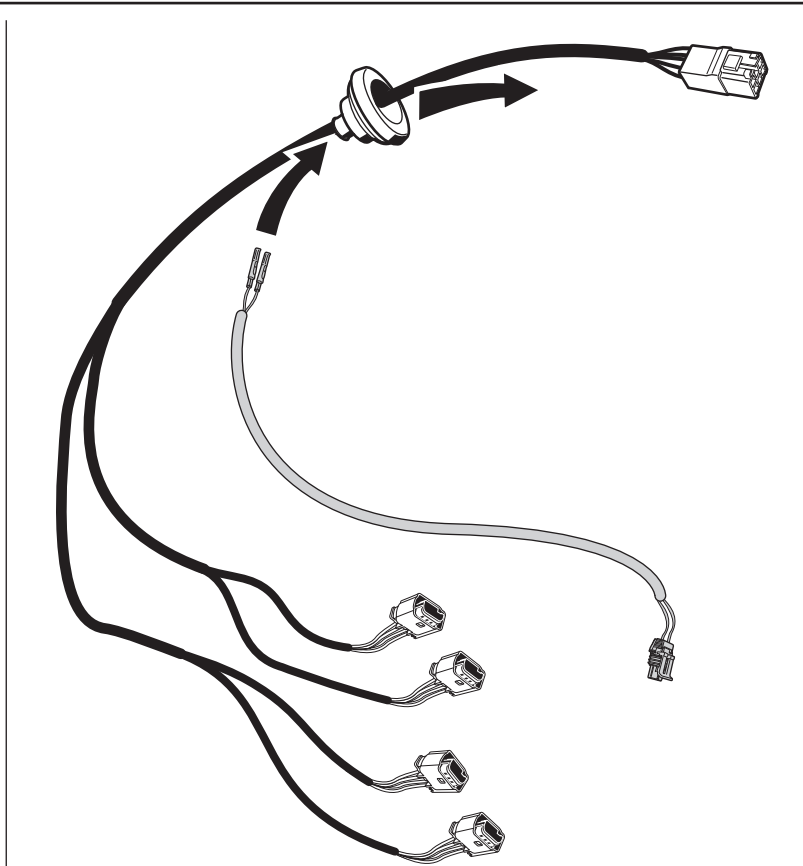
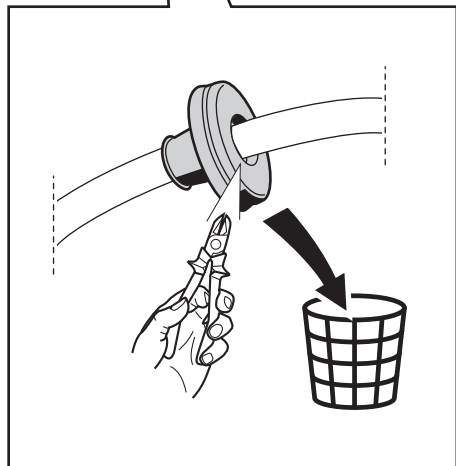
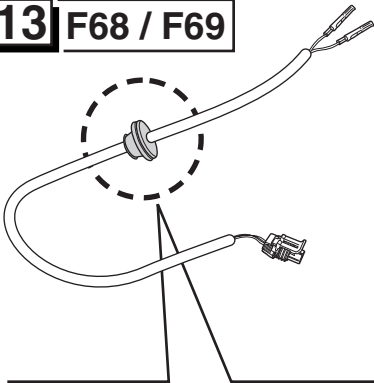

14 F68 / F69

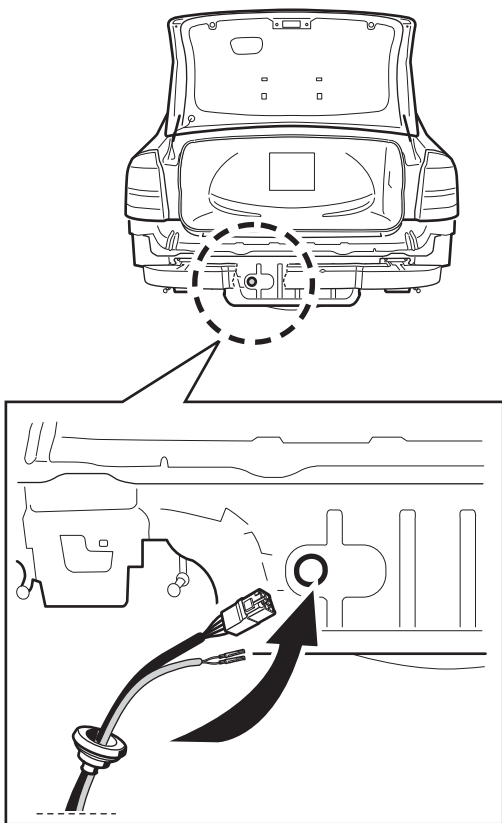

15 F68 / F69

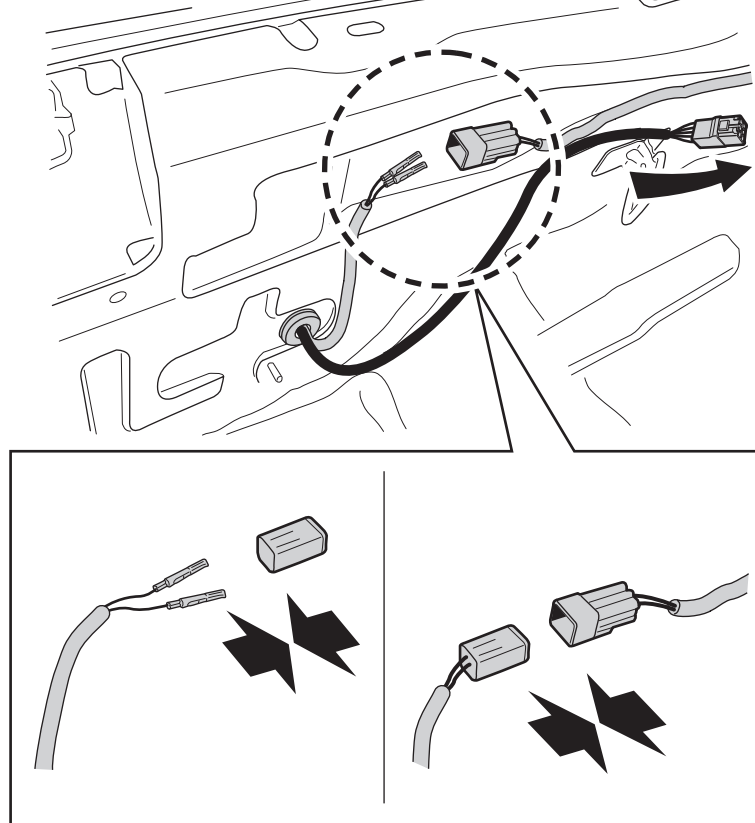

16 F48

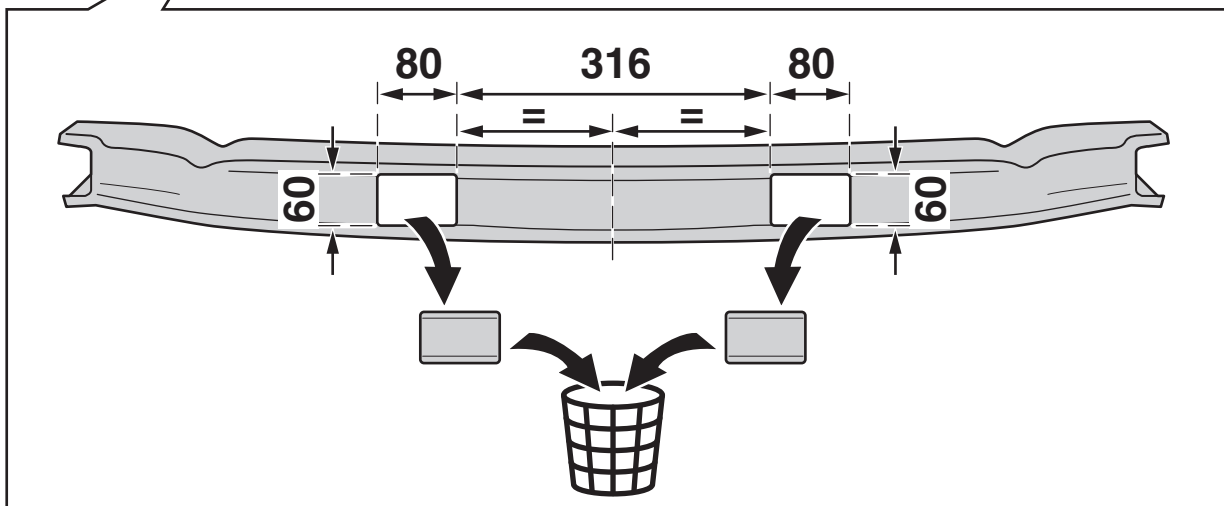
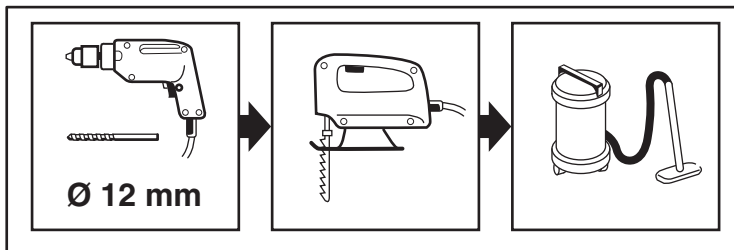
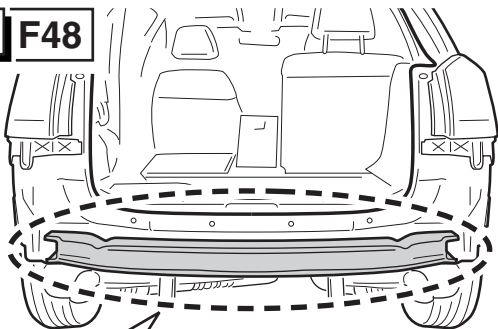

17 F48

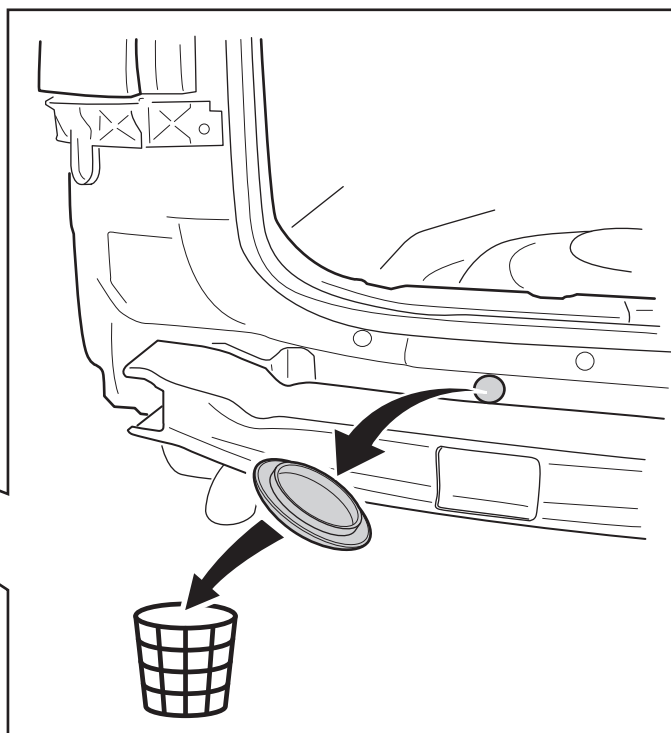
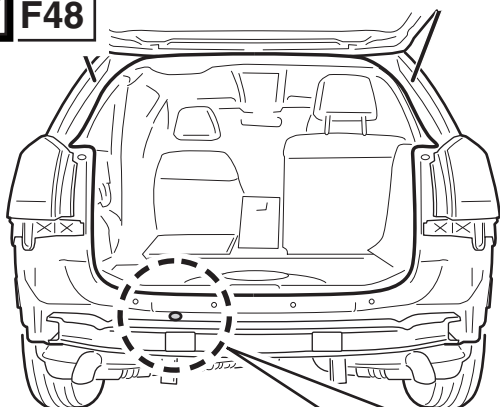

18 F48

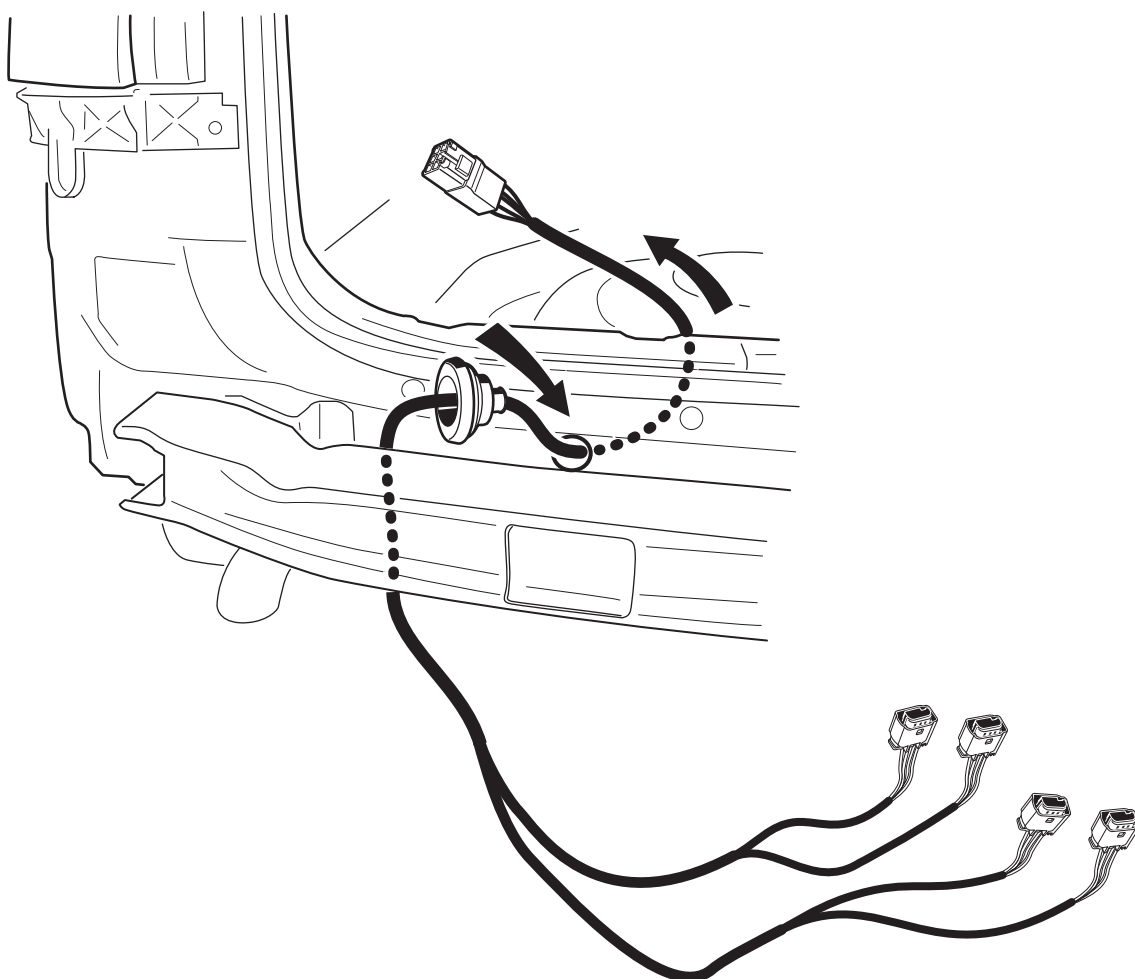

19 F35

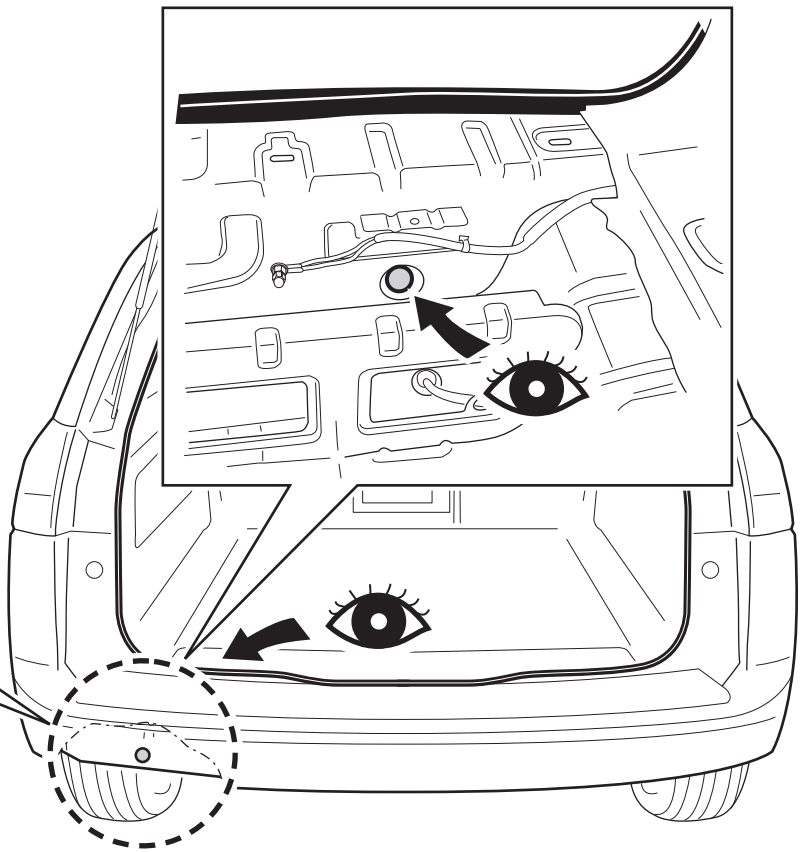
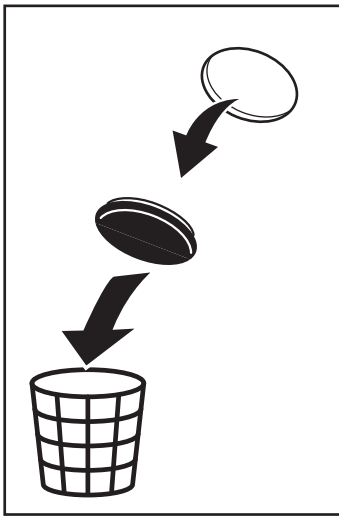

20 F35

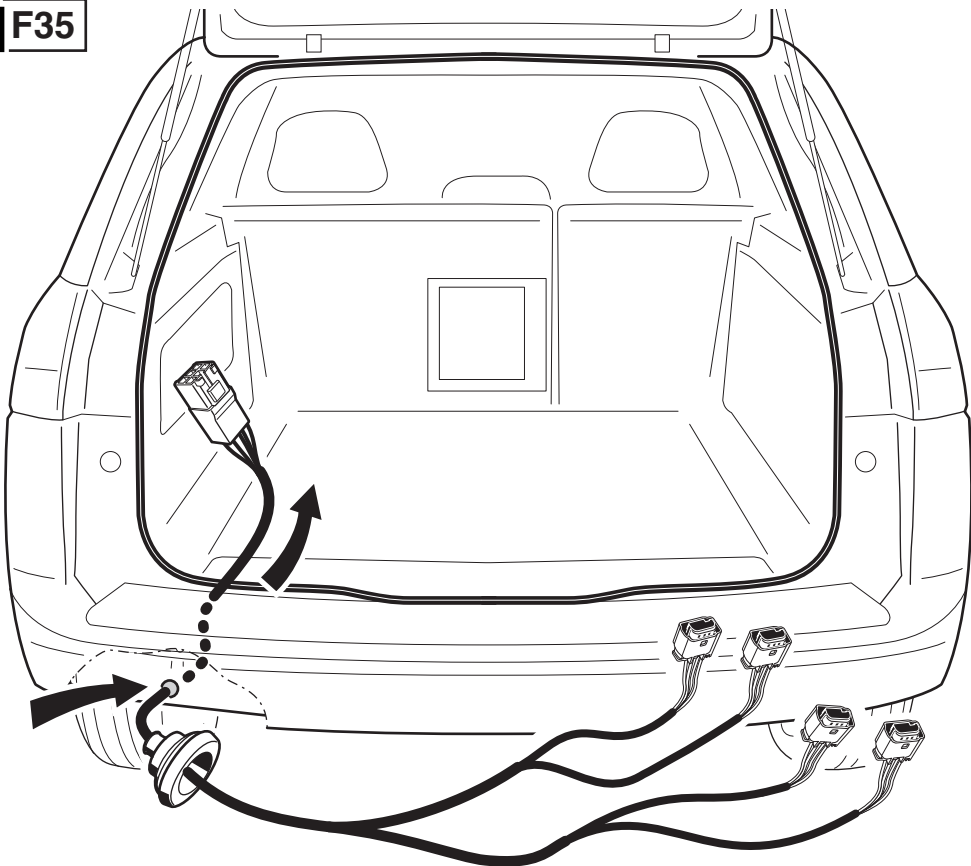

21

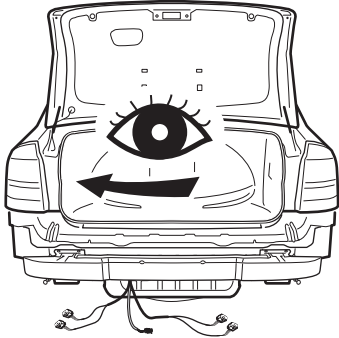

F68 / F69

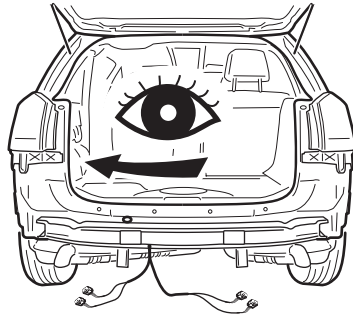

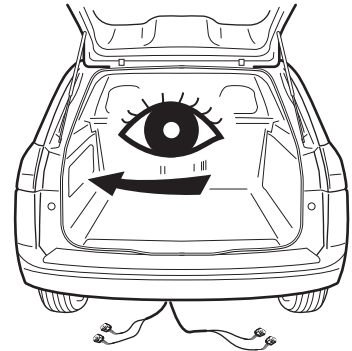

F48





F35

 → **24-25**
F68 / F69 / F48 / F35

 → **26**
F68 / F69 / F48 / F35

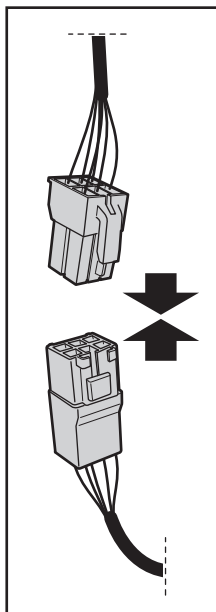
 → **22-23**
F68 / F69 / F48 / F35



 → **27**
F68 / F69
F48
F35

 → **37**
F68 / F69 / F48 / F35

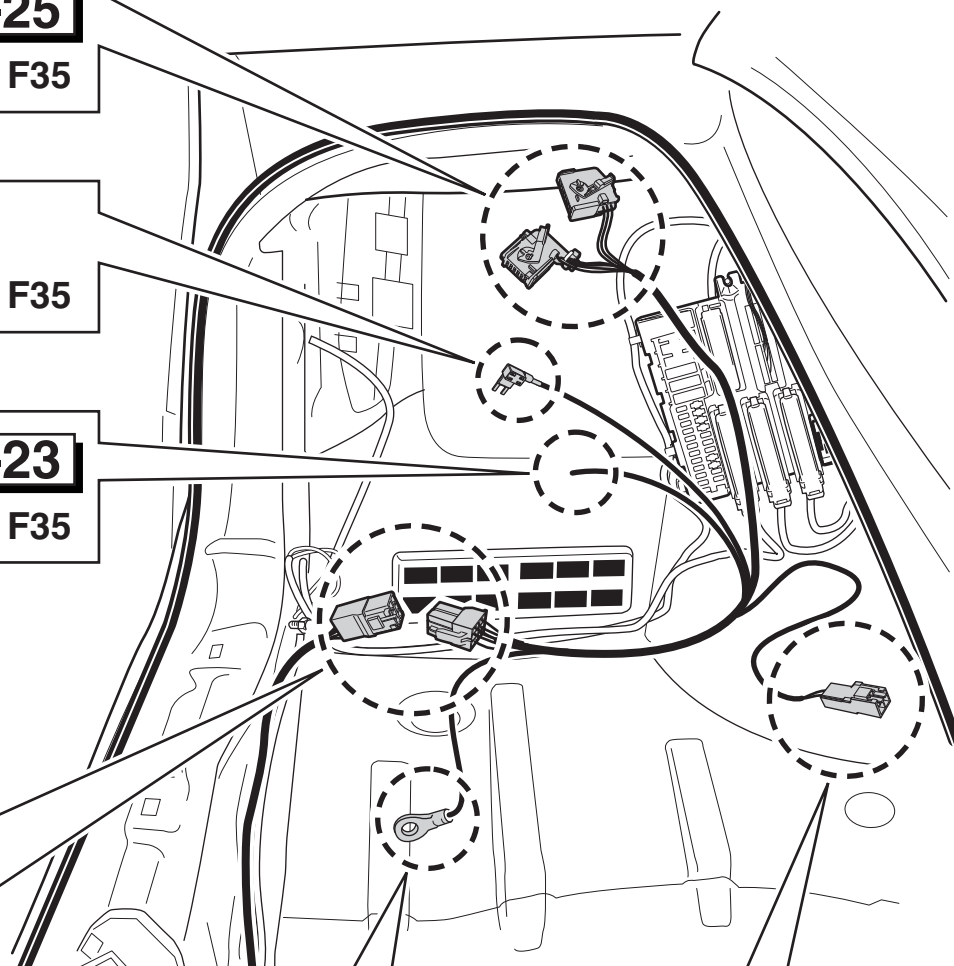

22

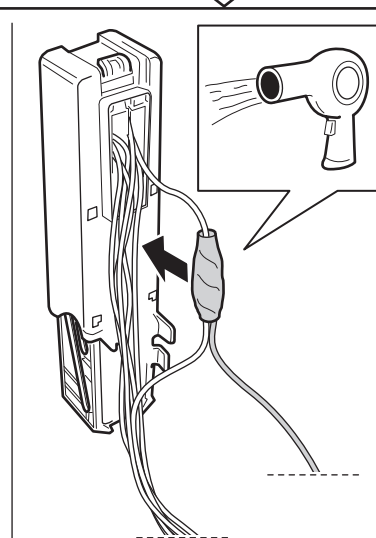
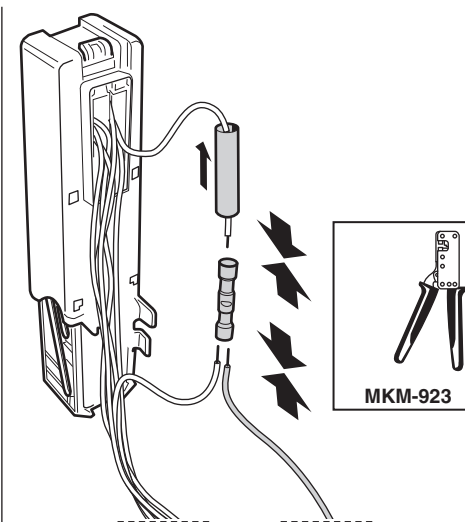
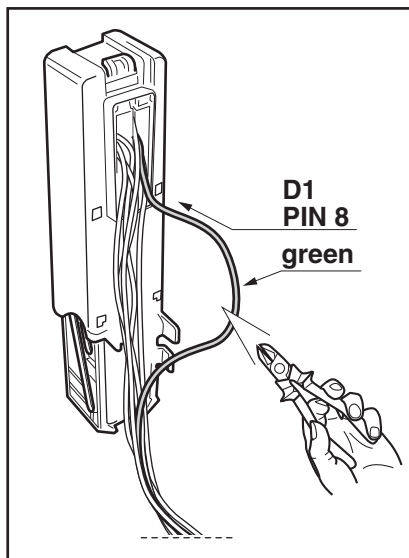
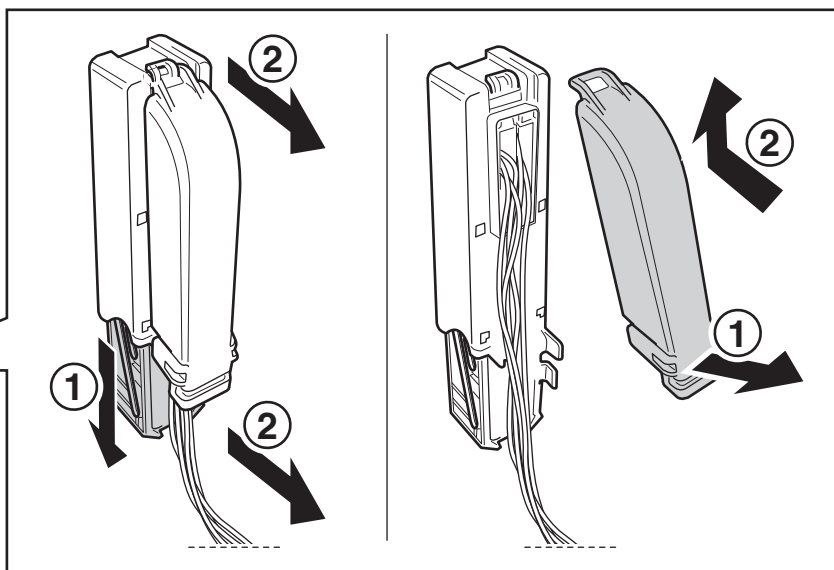
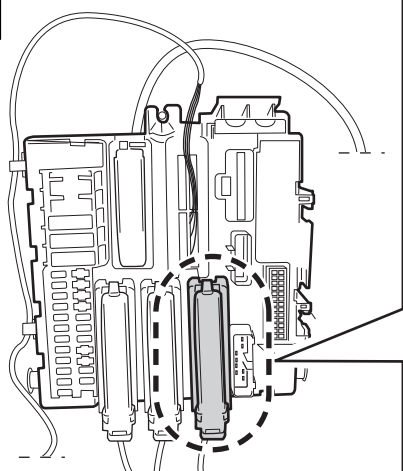

23

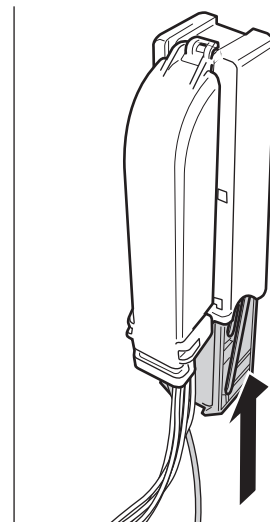
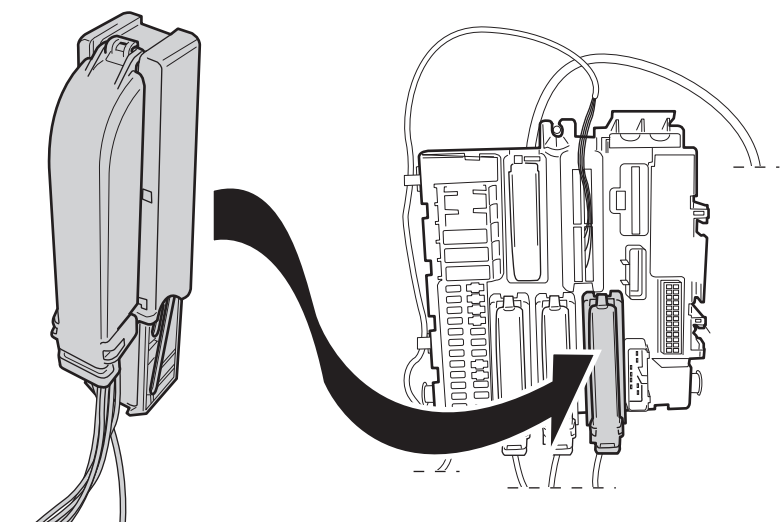

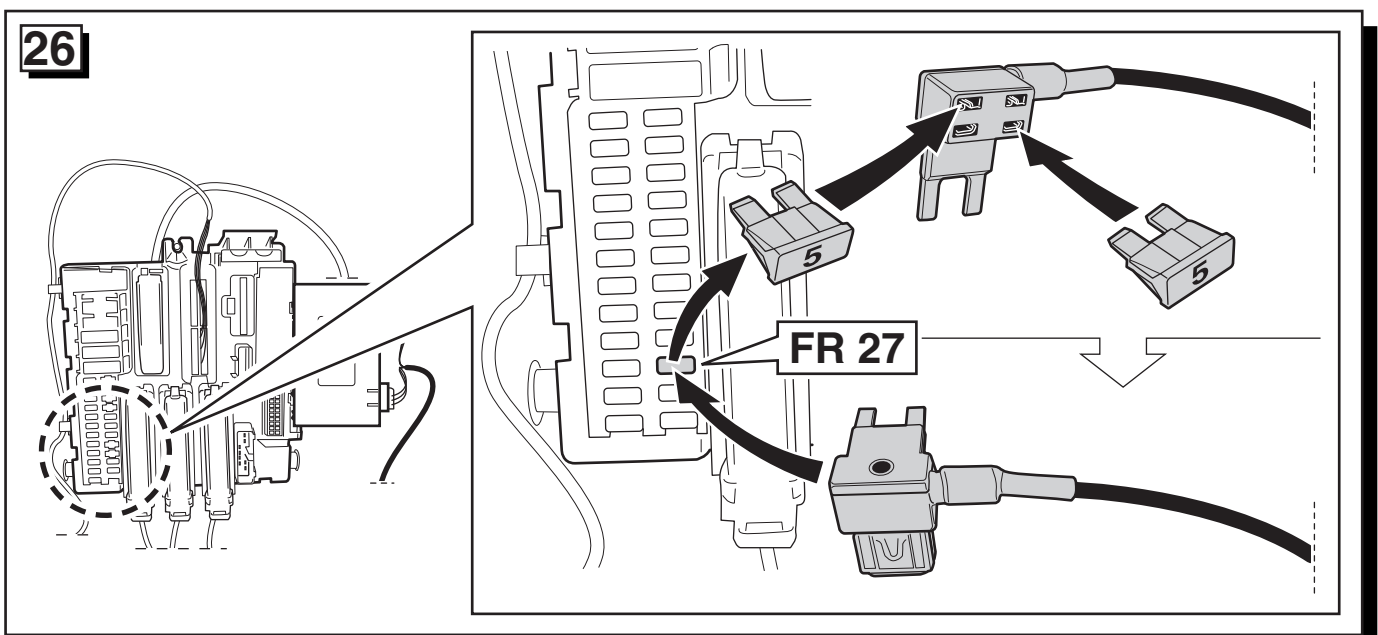
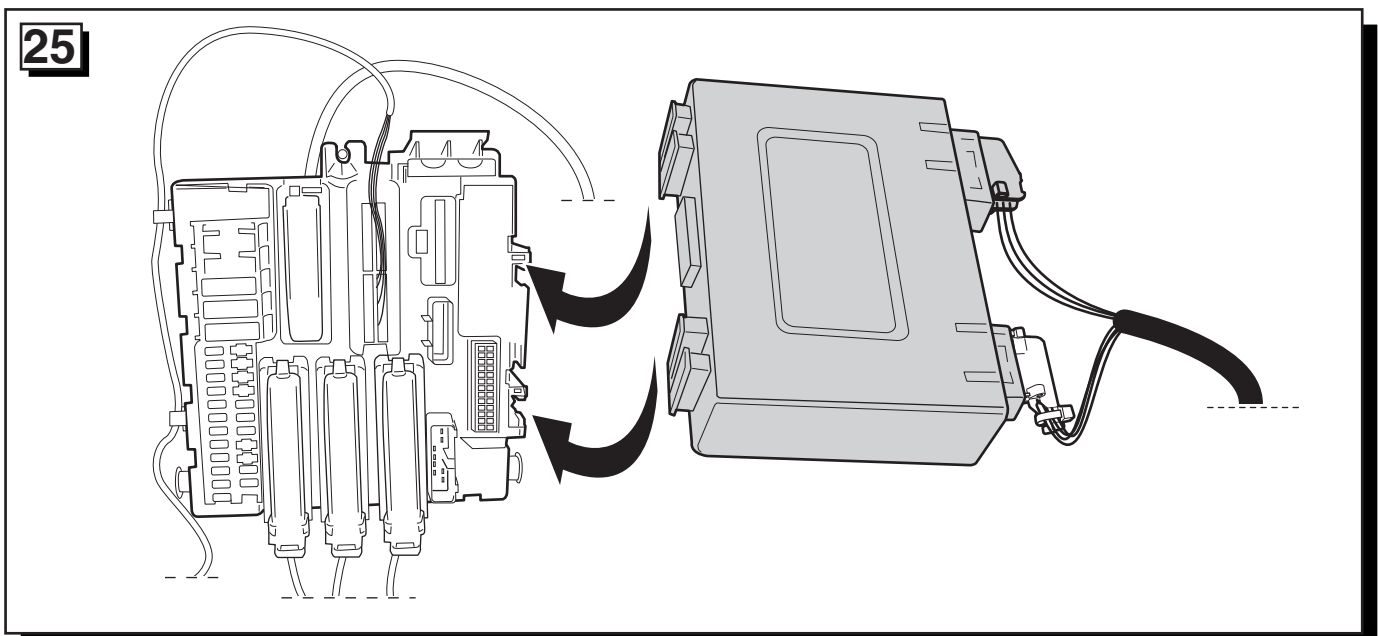
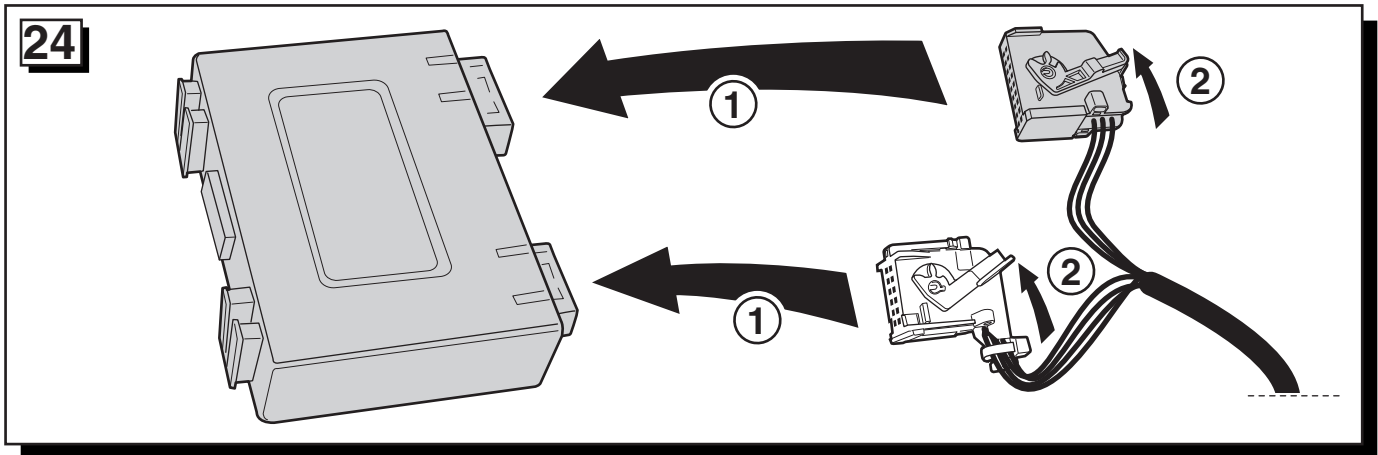

27 F68 / F69

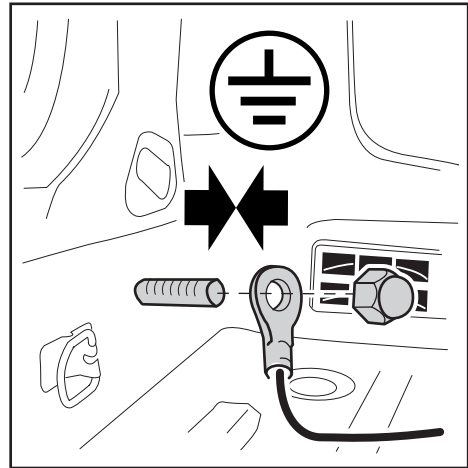
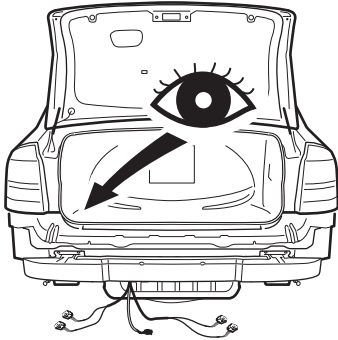

28 F48

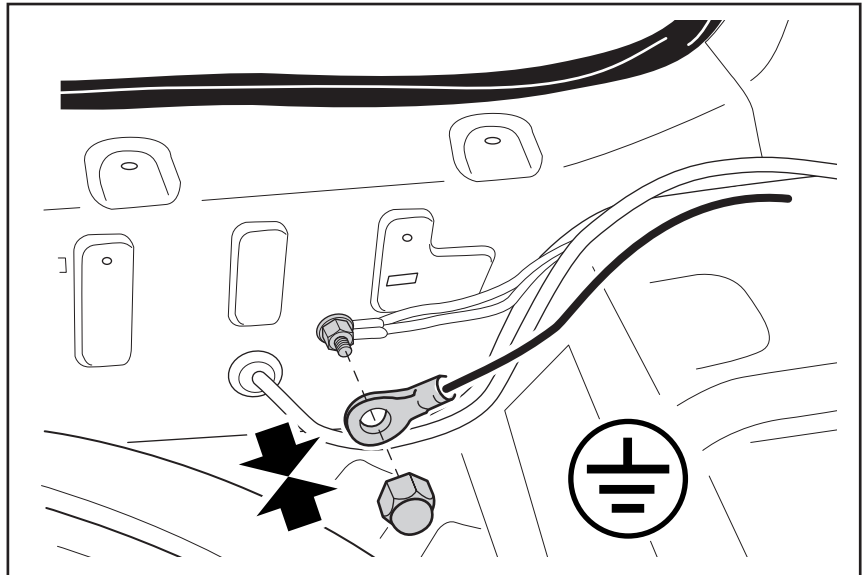
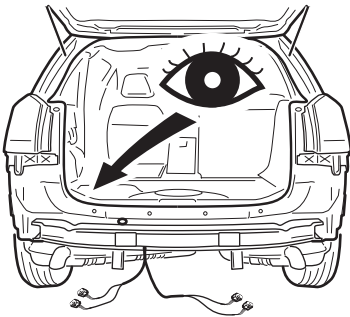

29 F35

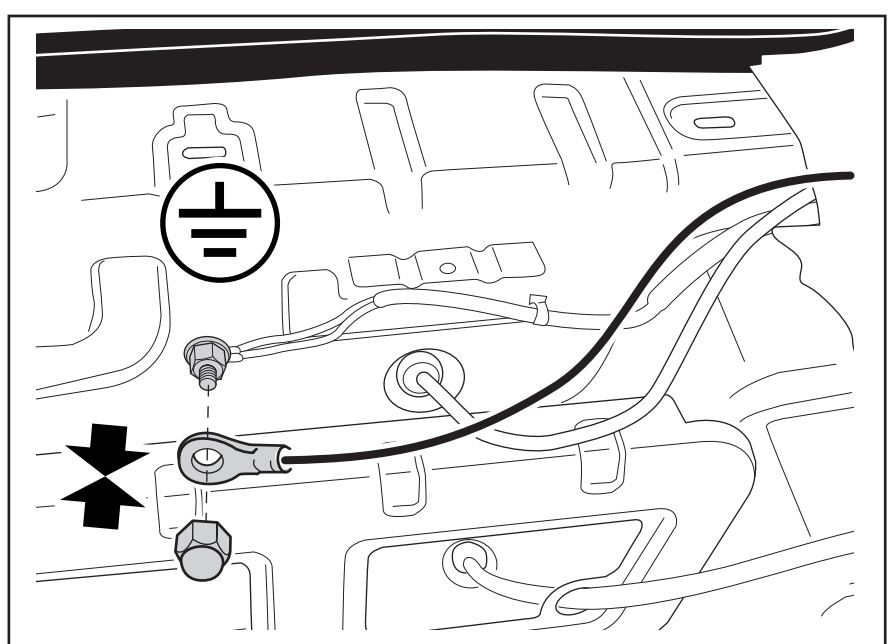
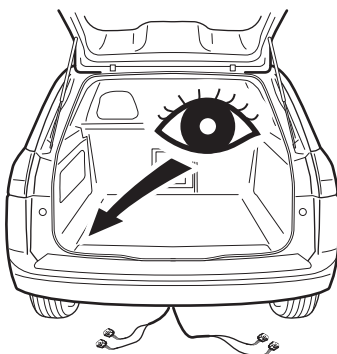

30 F68 / F69

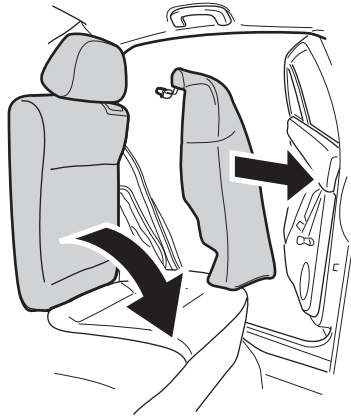
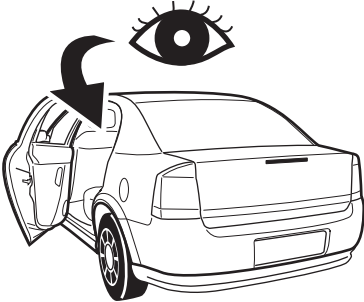

31 F68 / F69

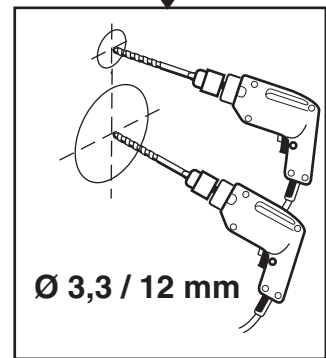
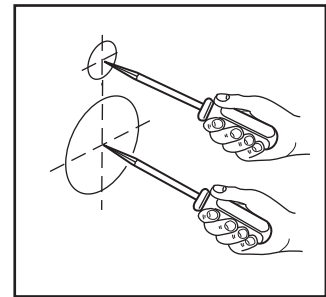
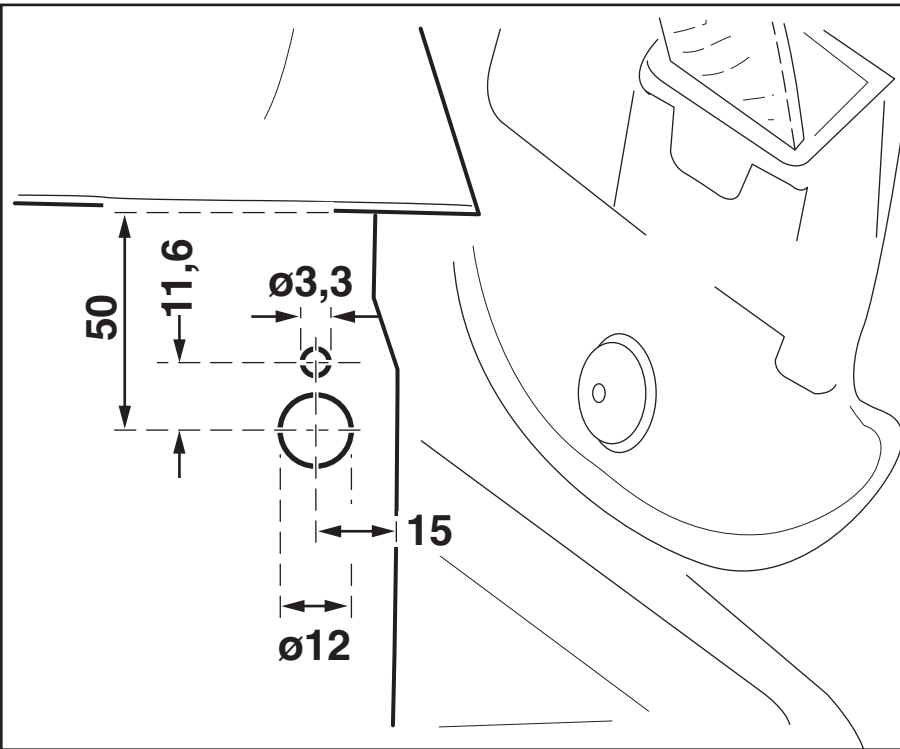
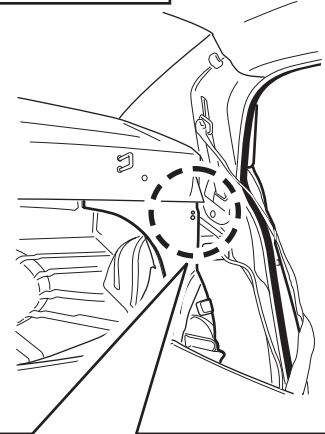

32 F68 / F69

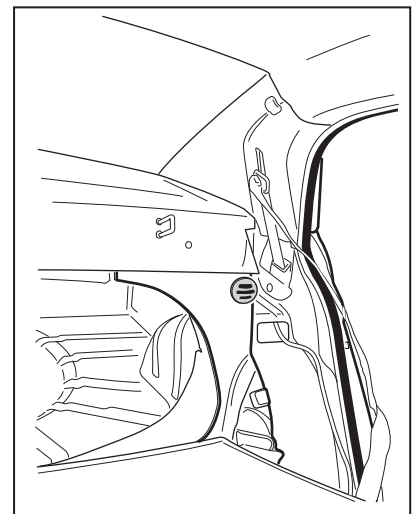
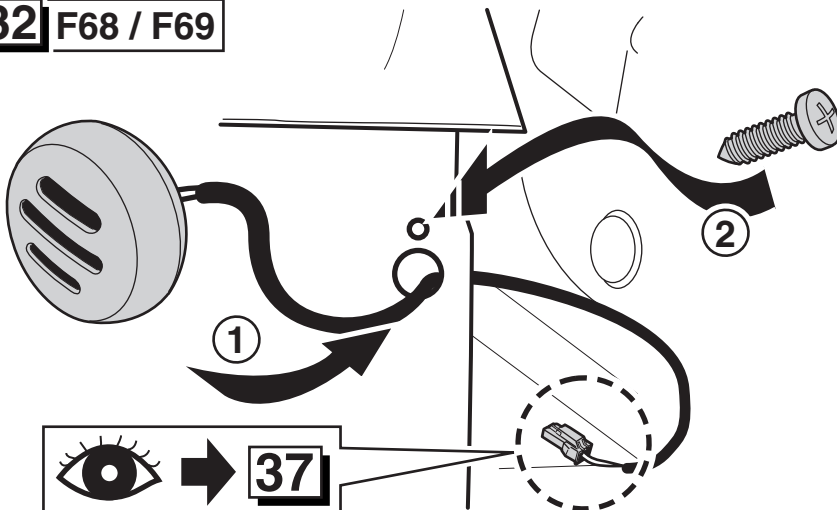

33 F48

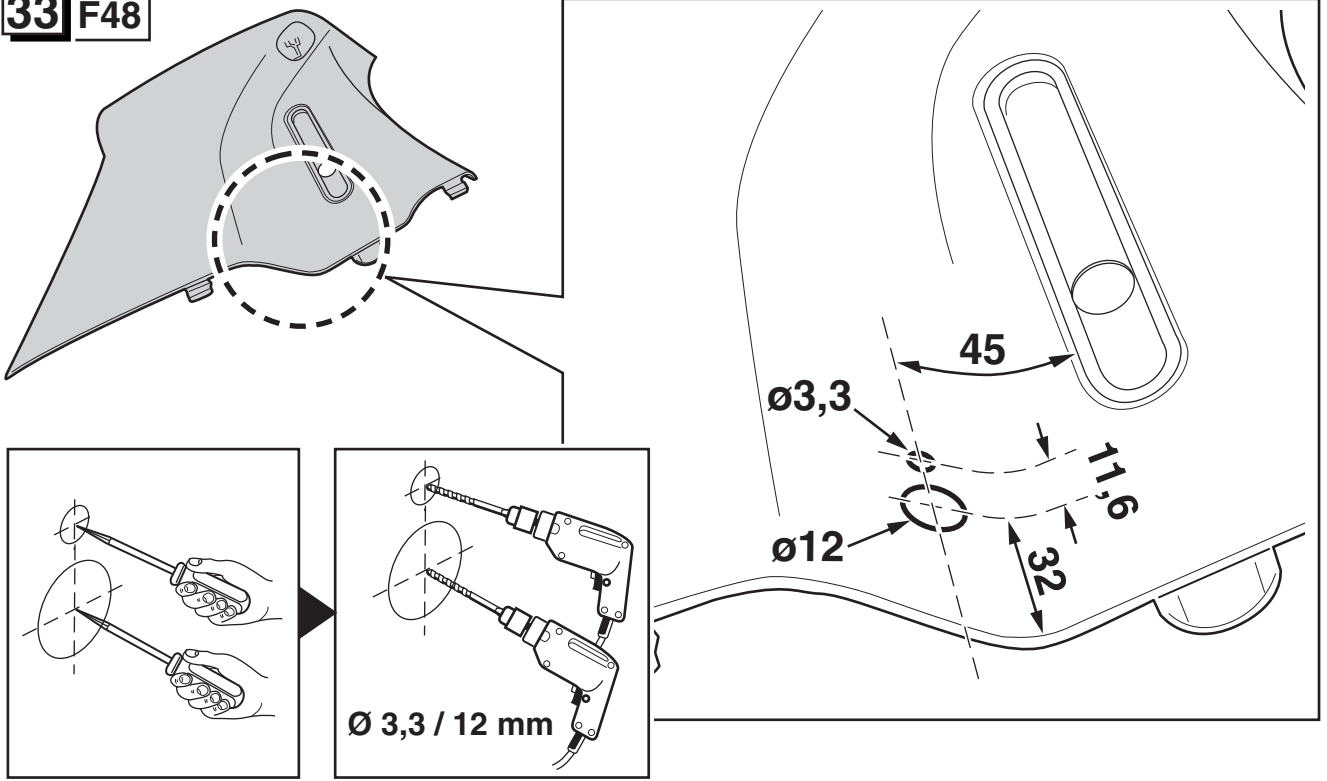

34 F48

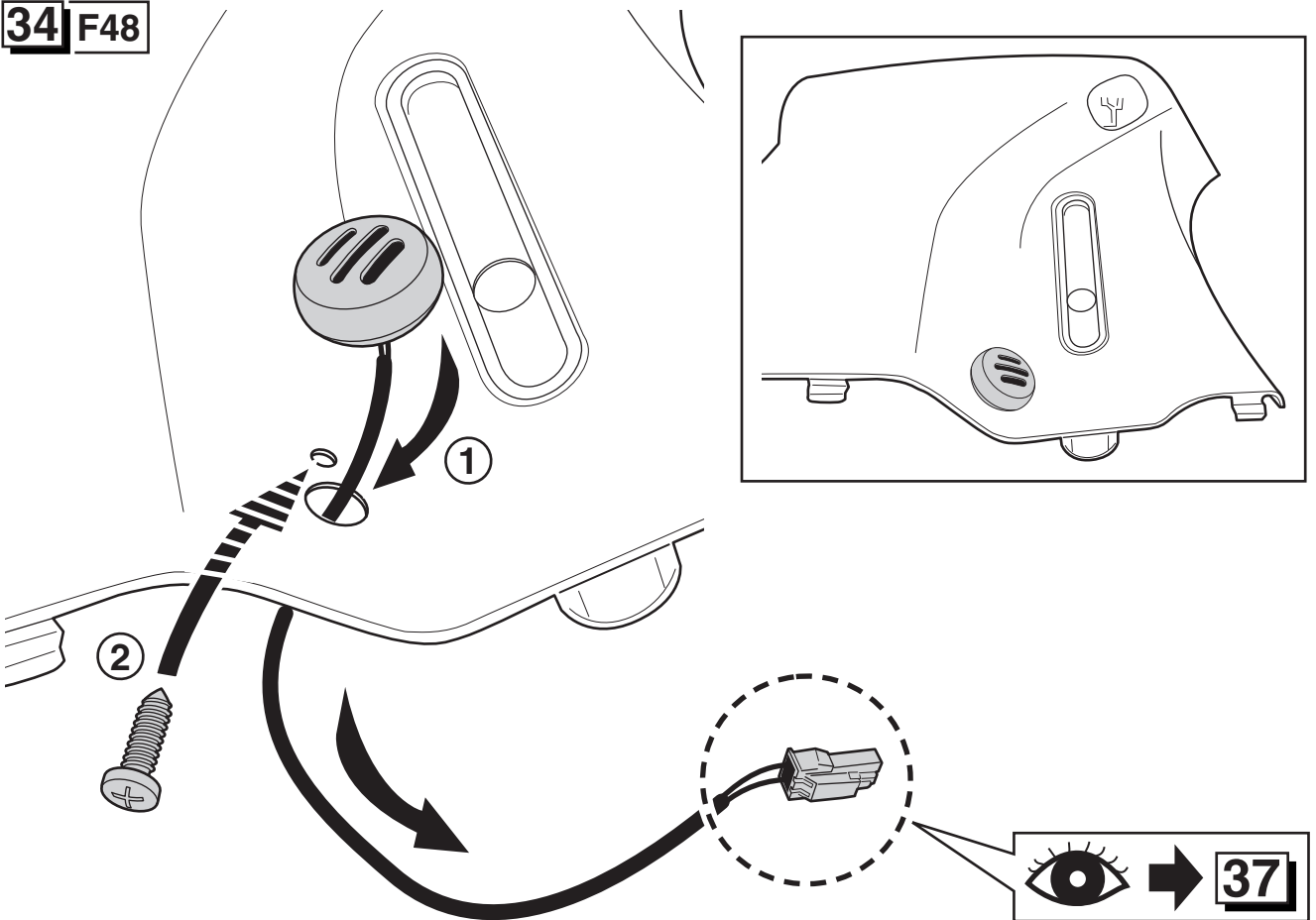

35 F35

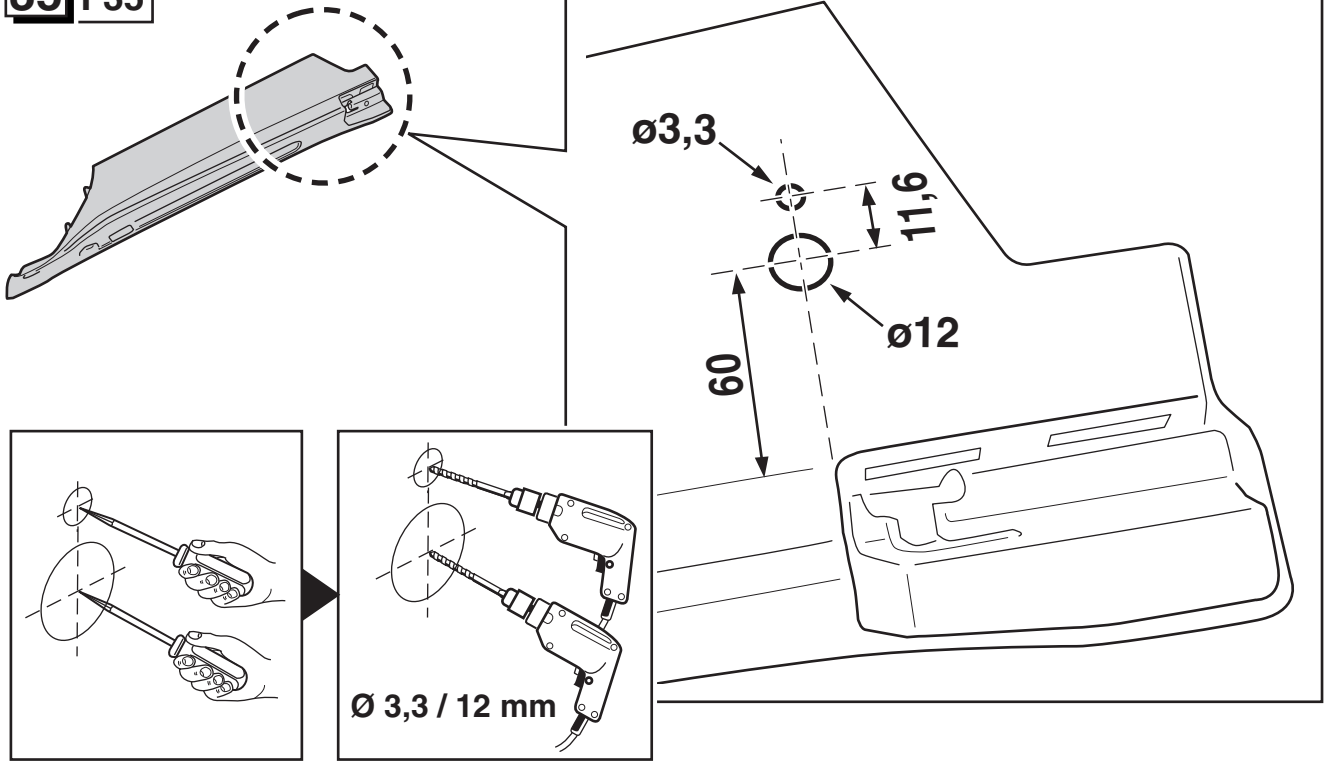

36 F35

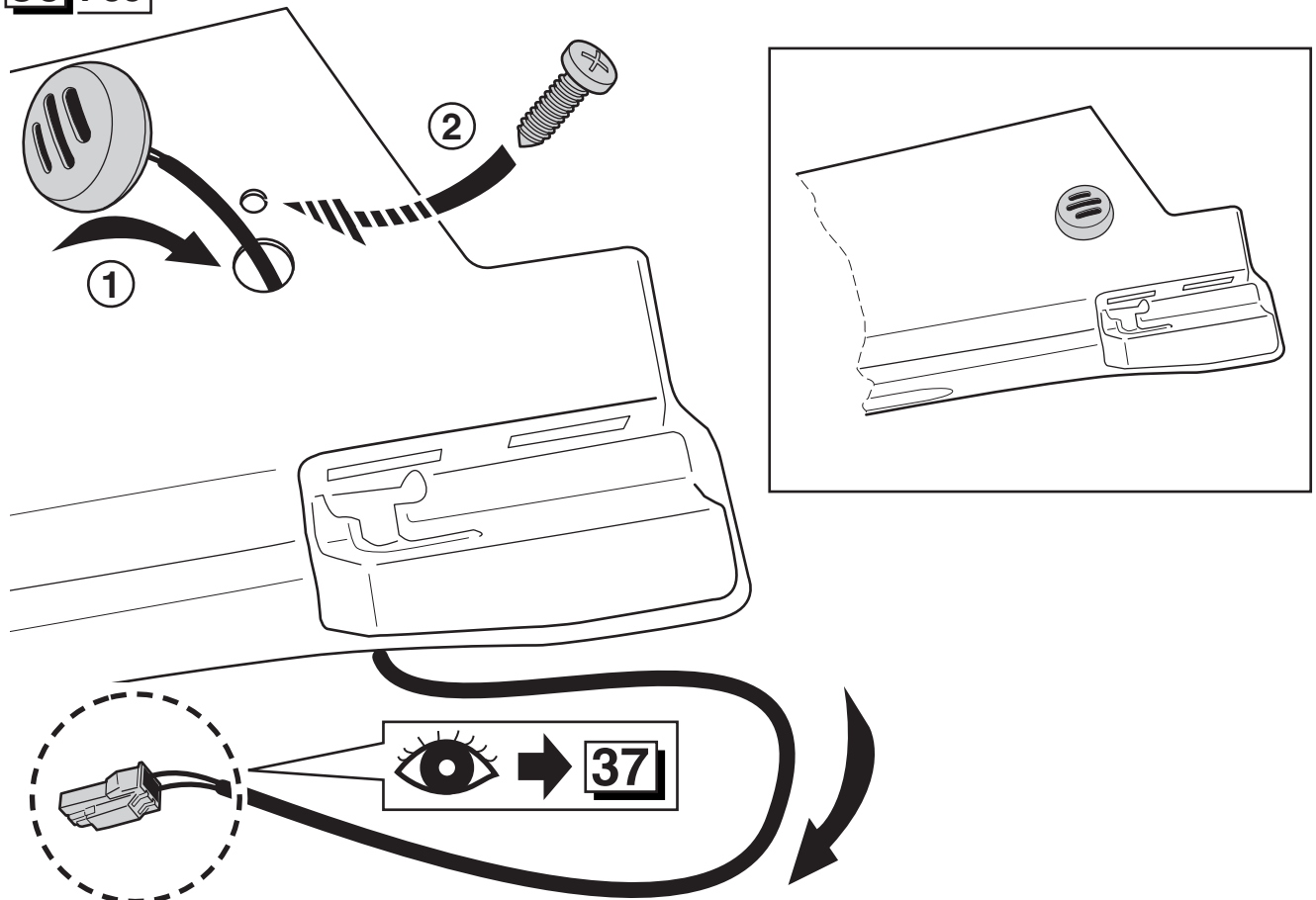

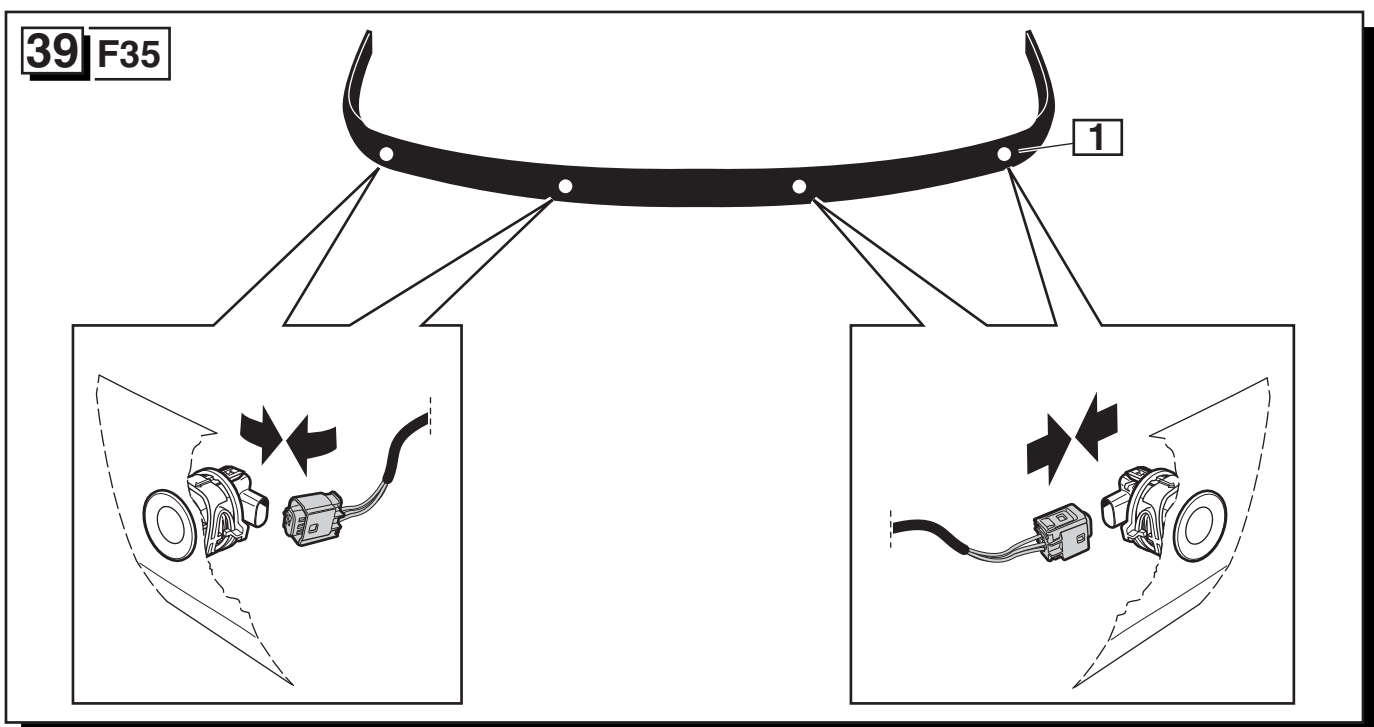
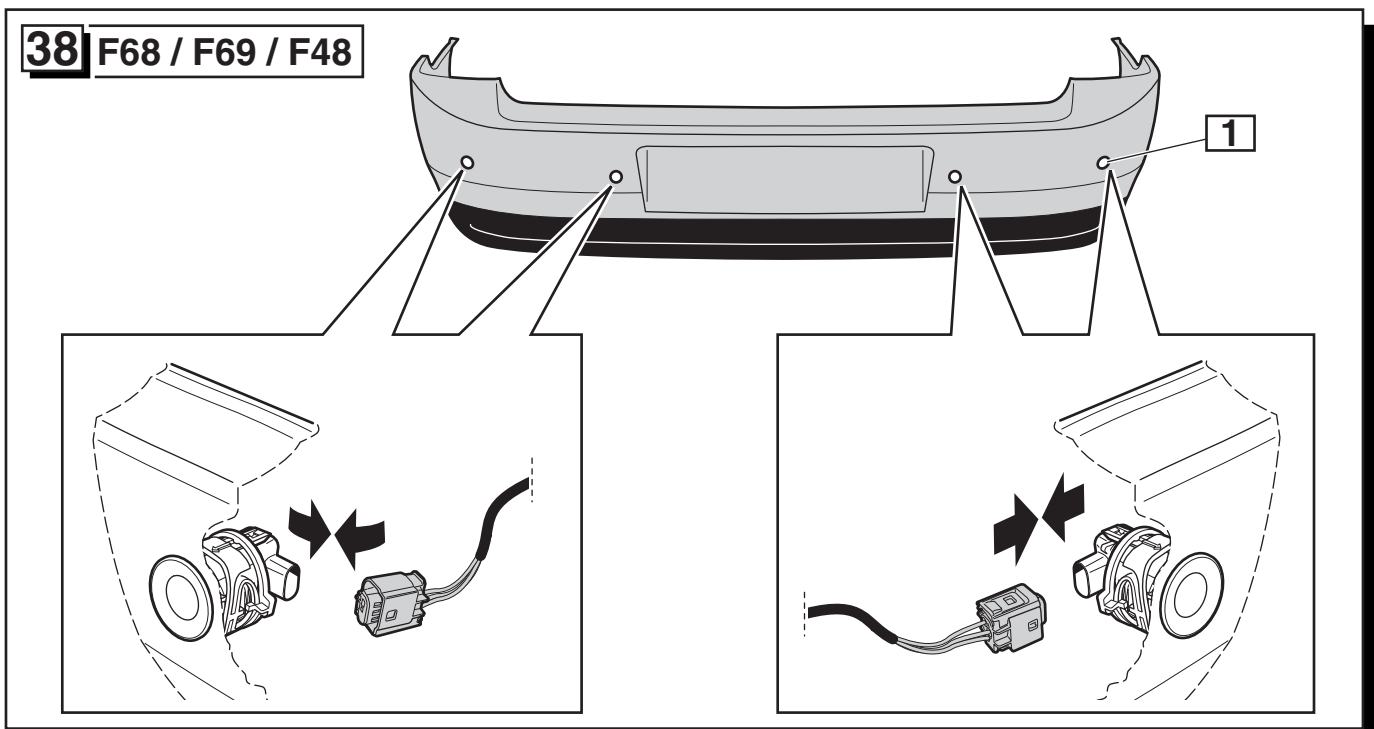
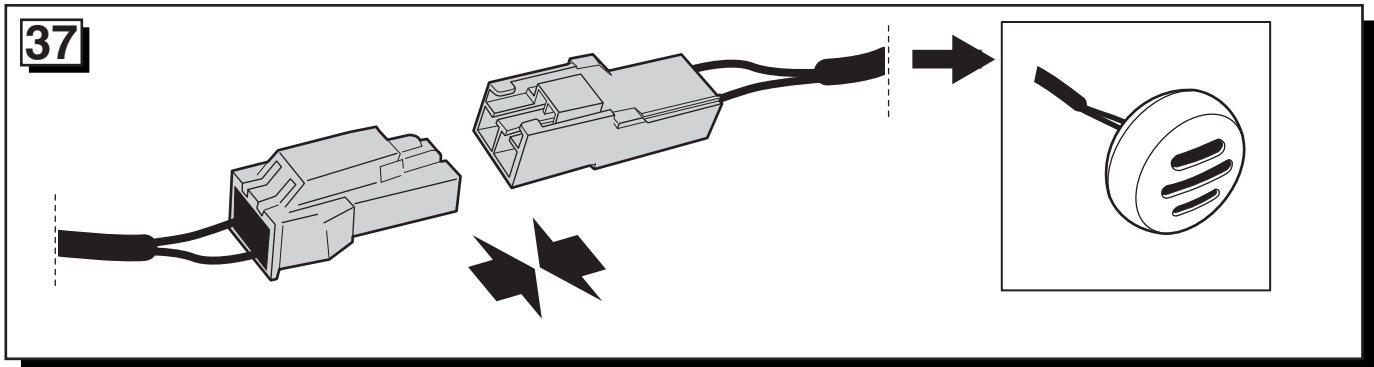

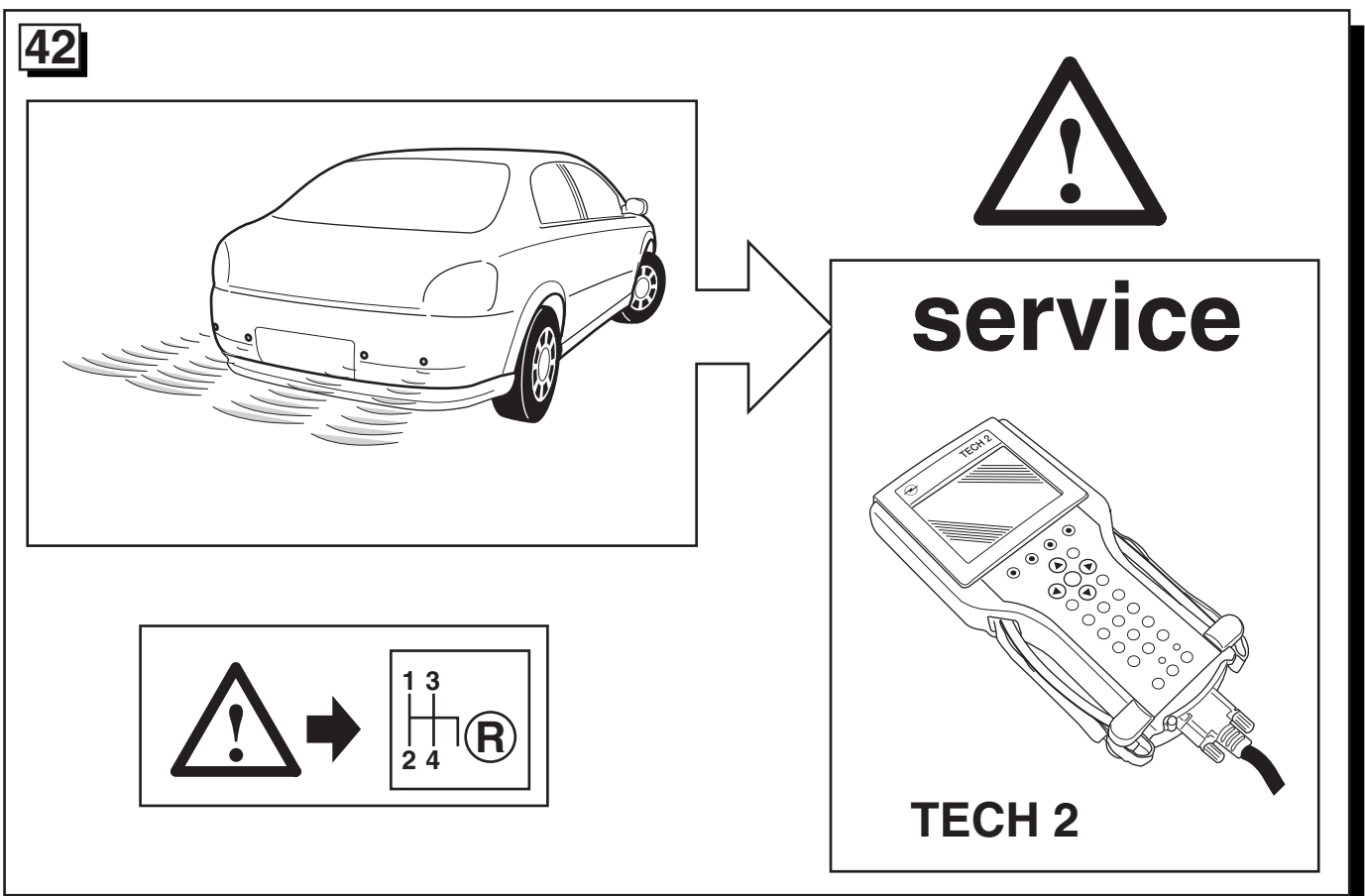
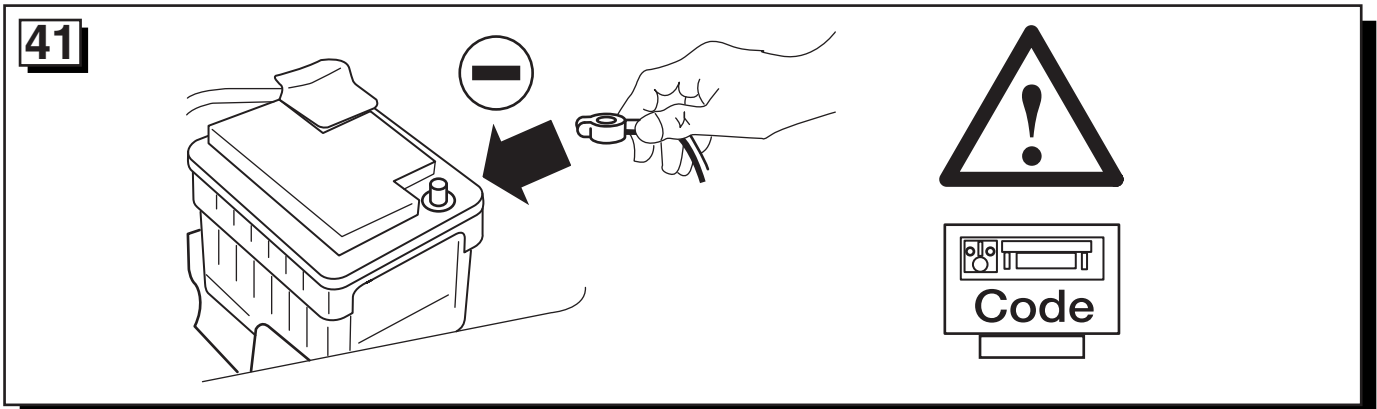
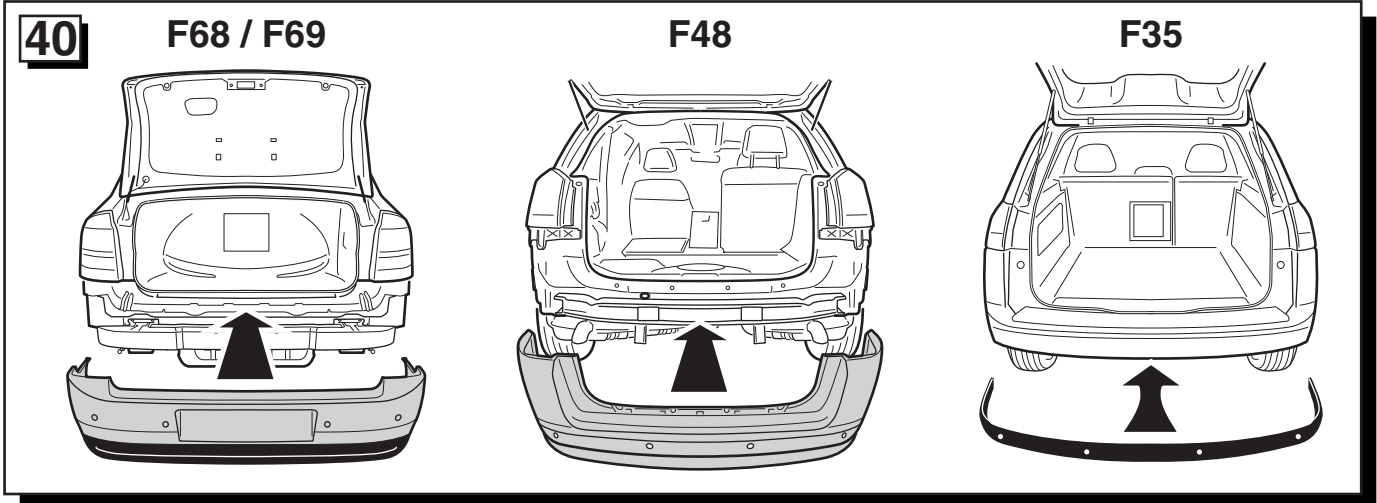

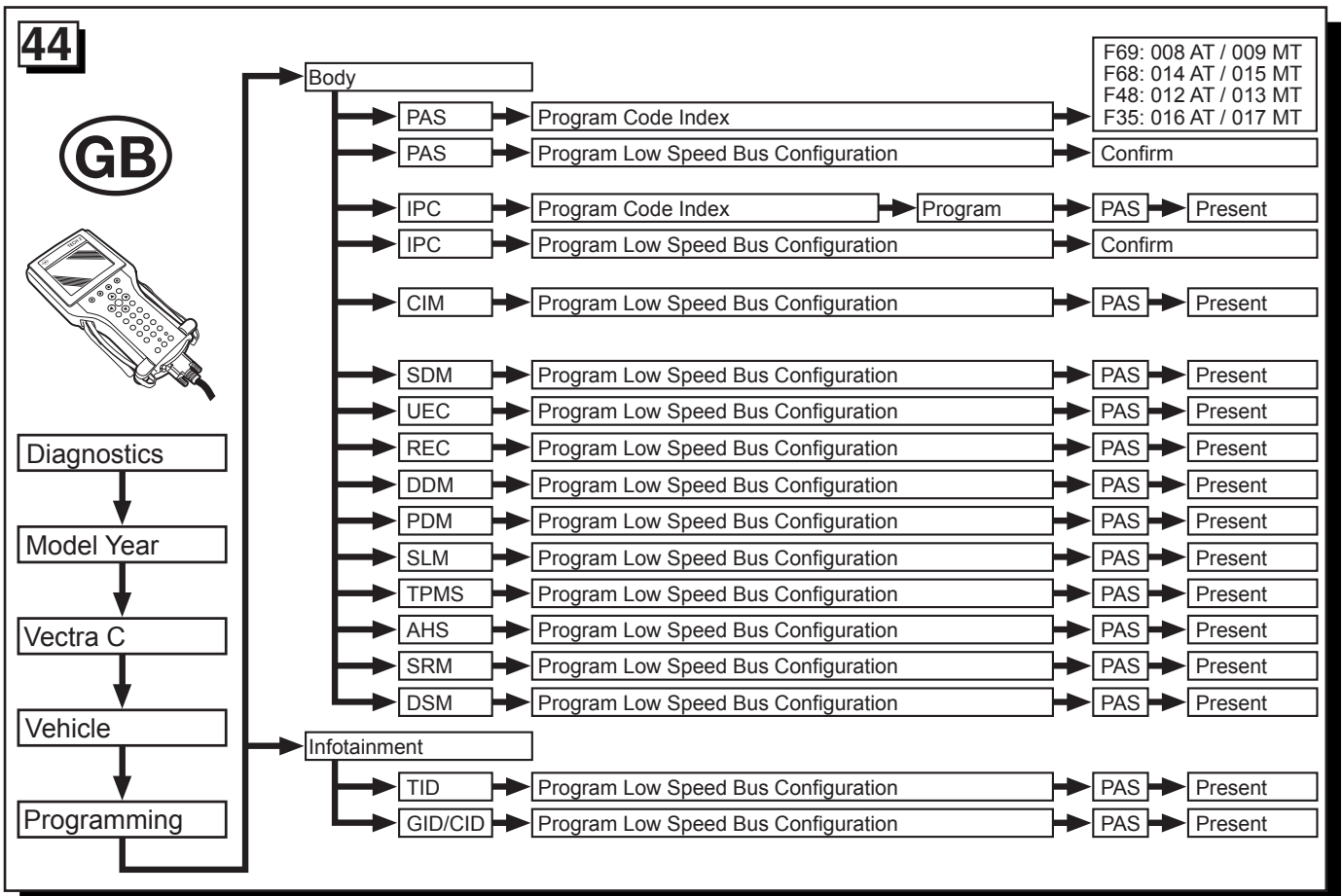
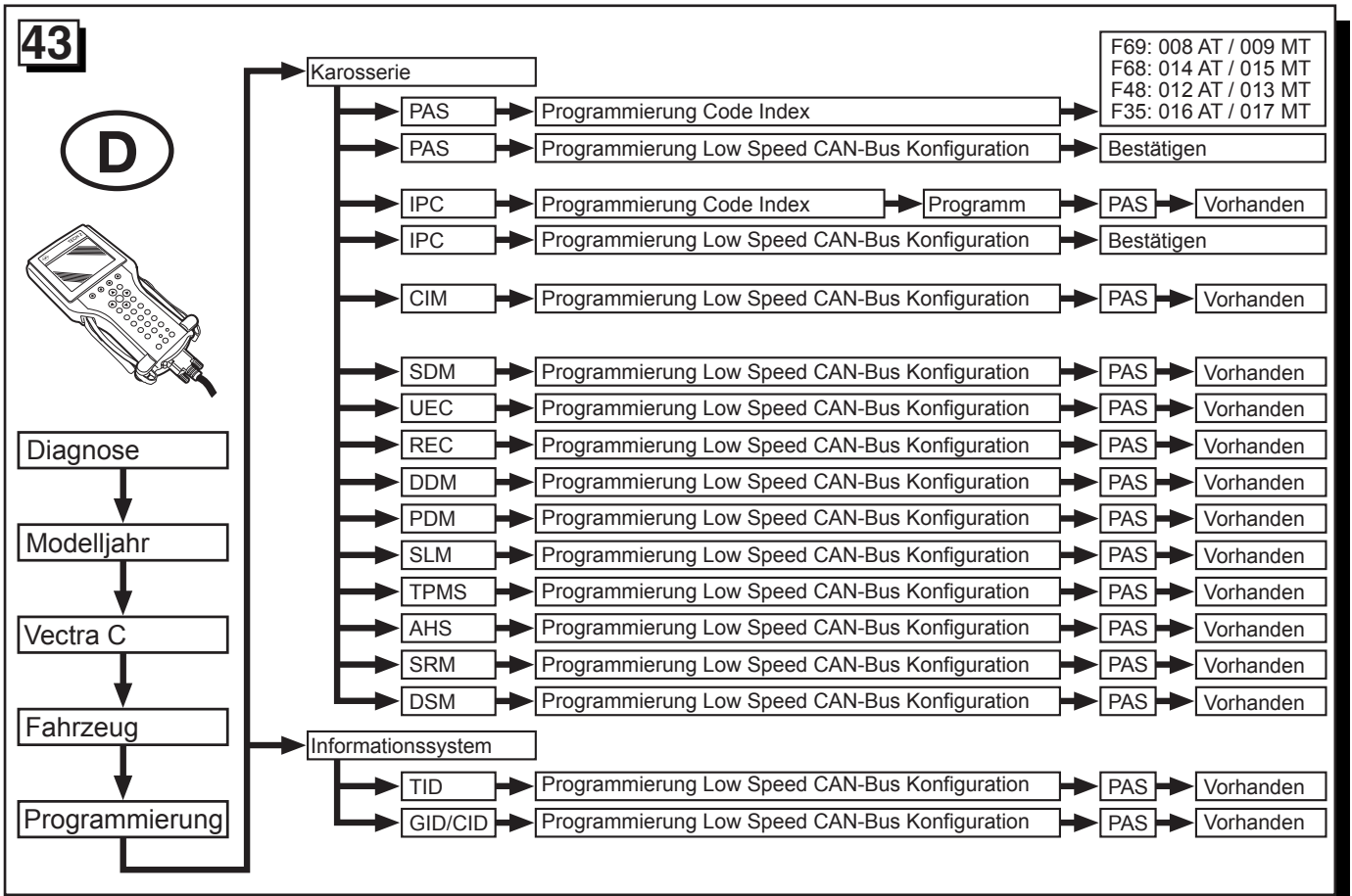

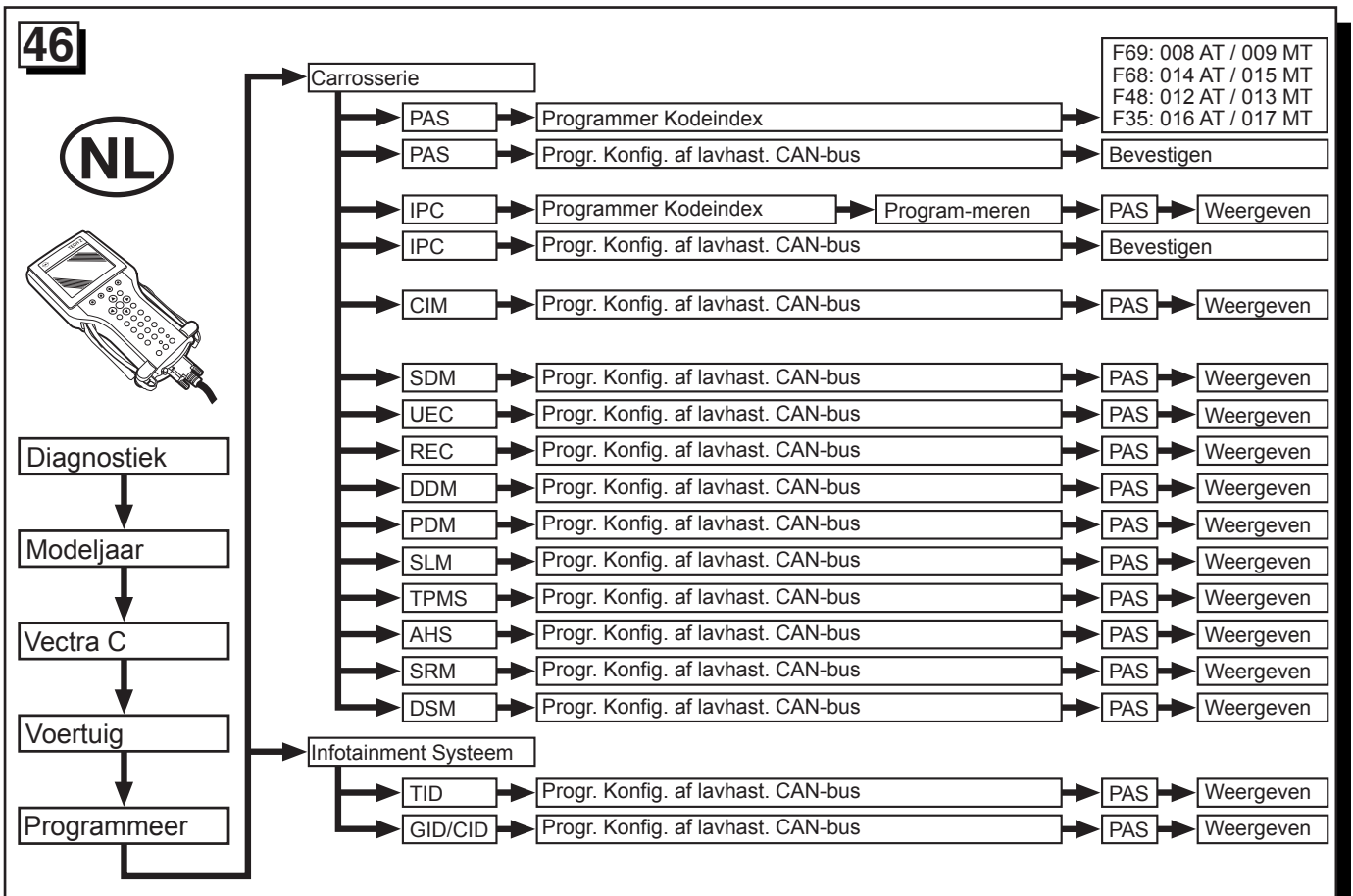
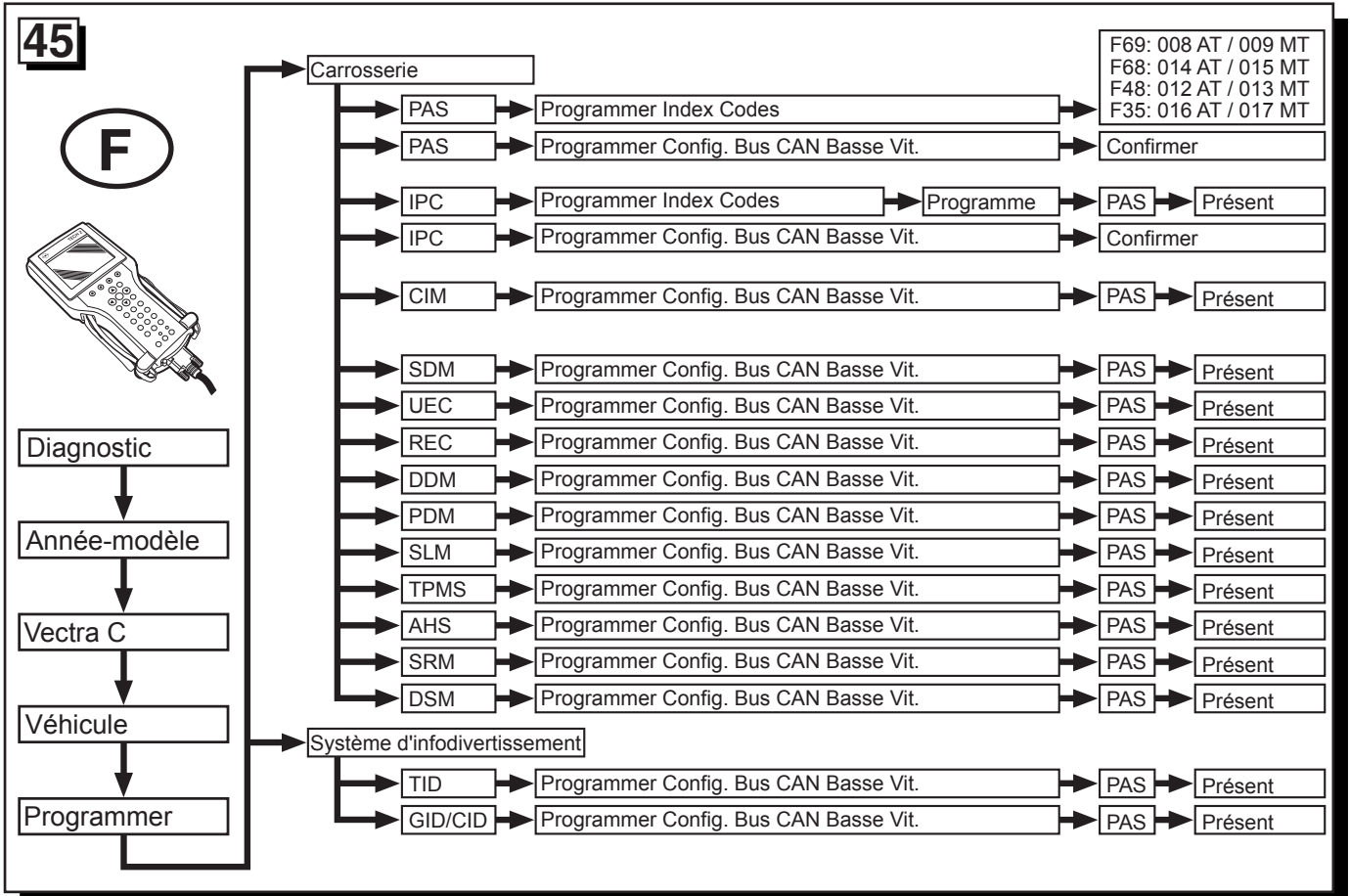

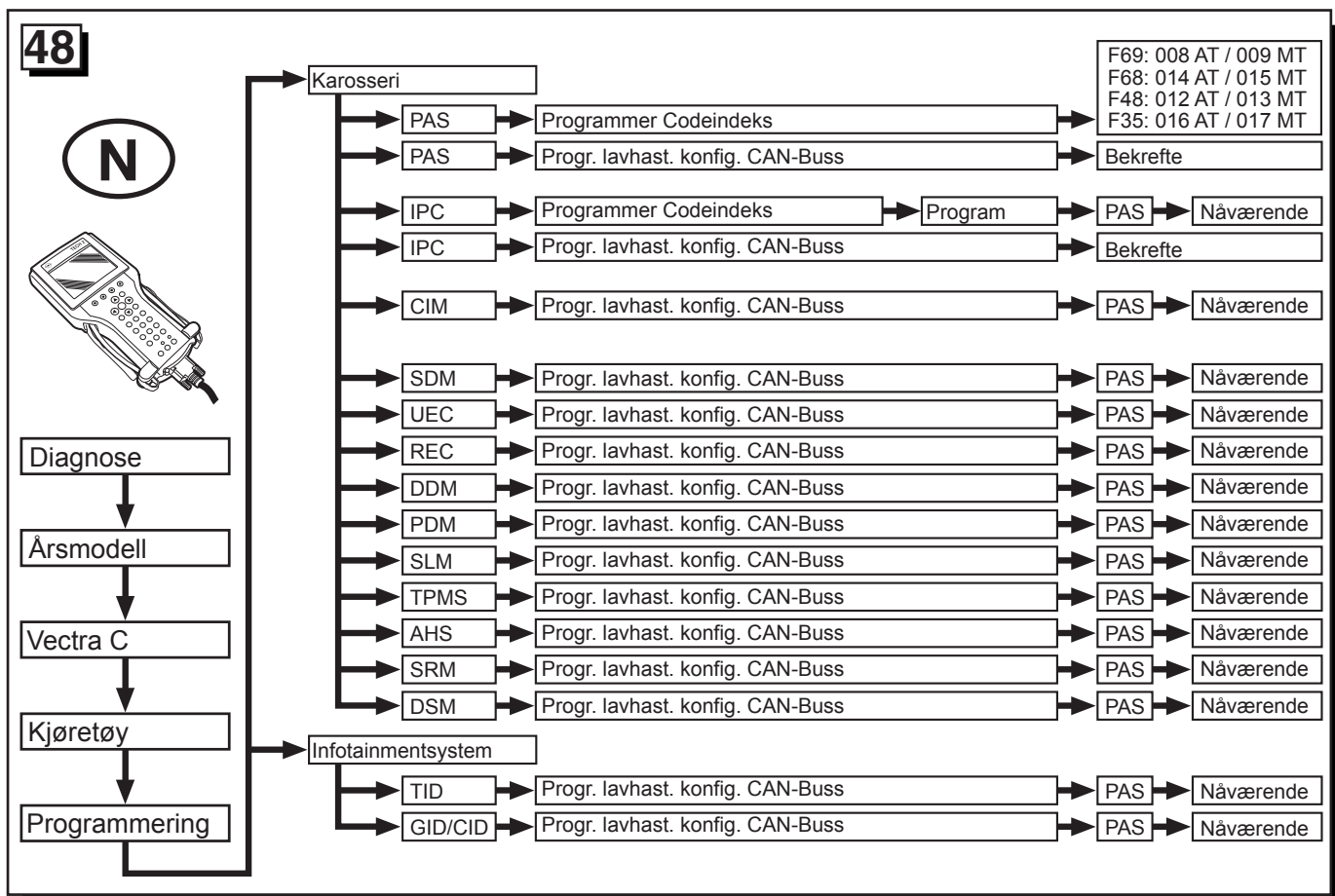
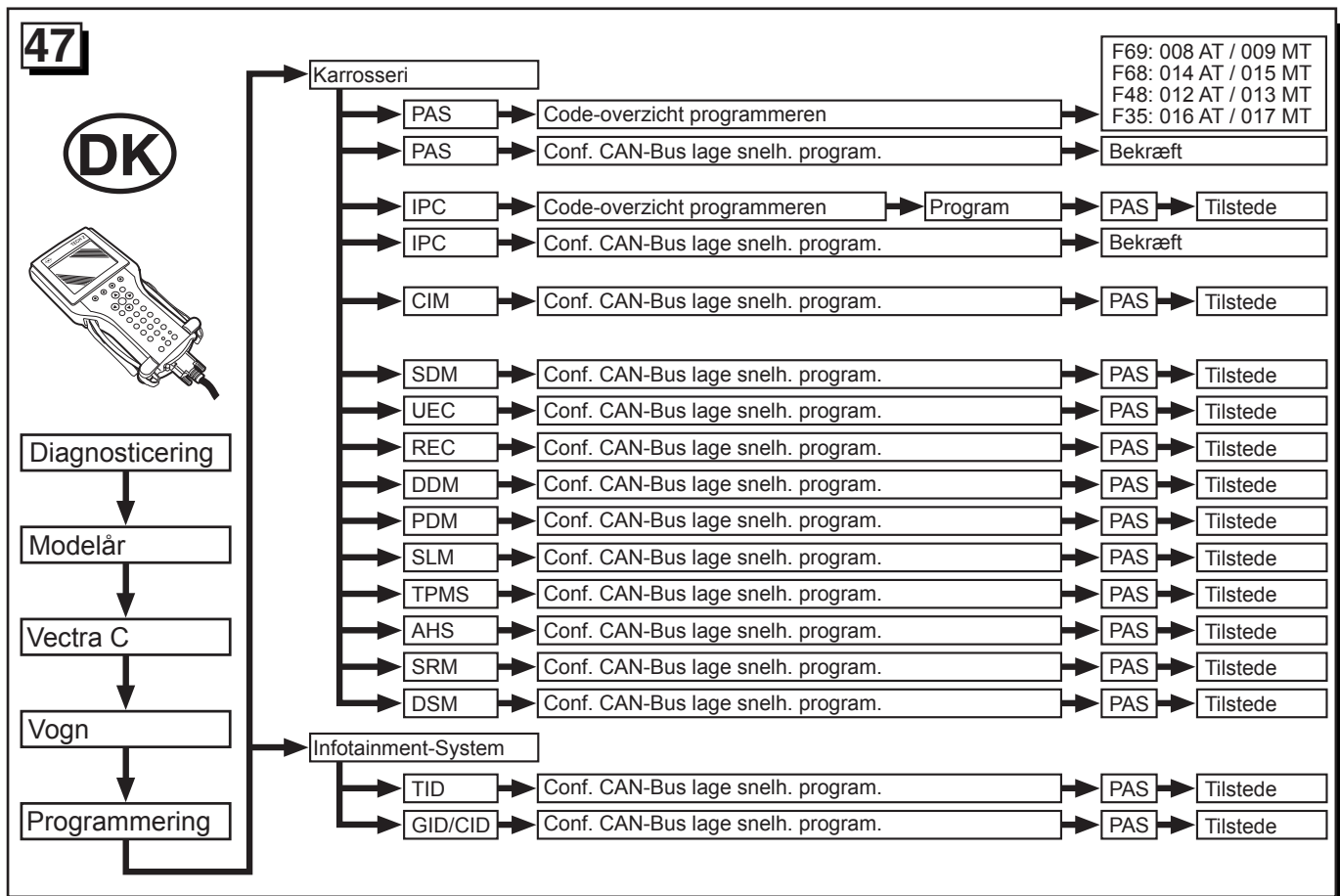

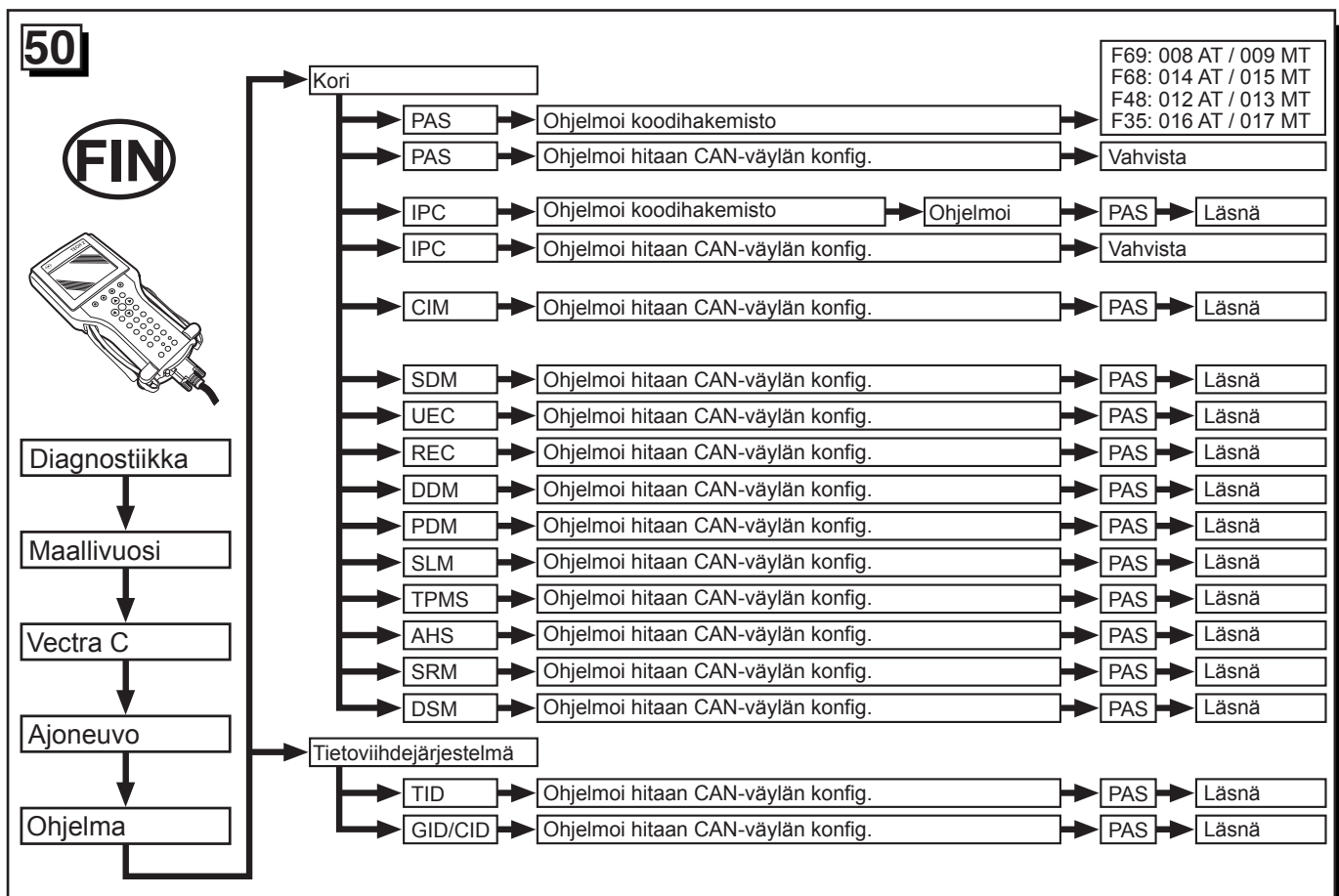
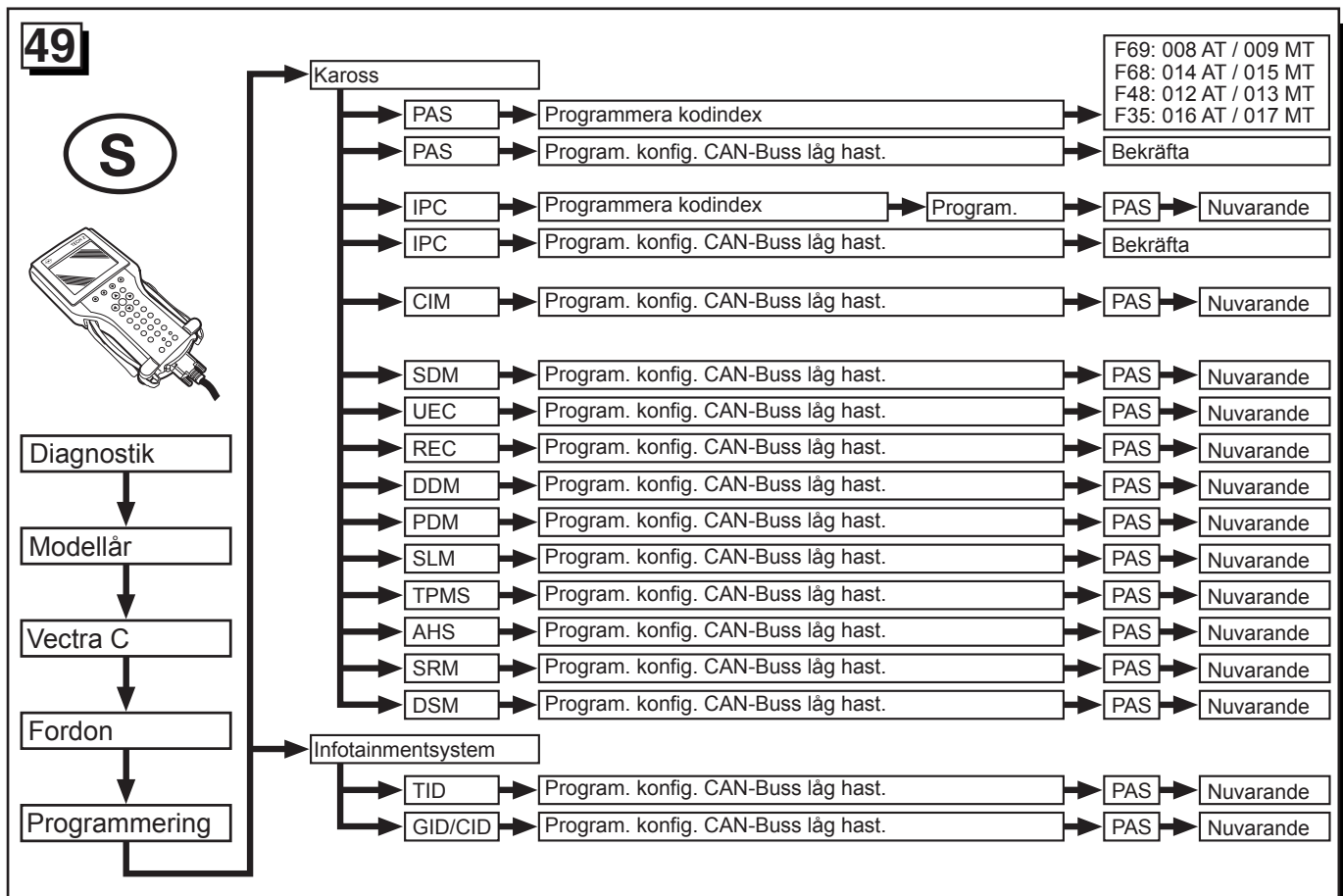

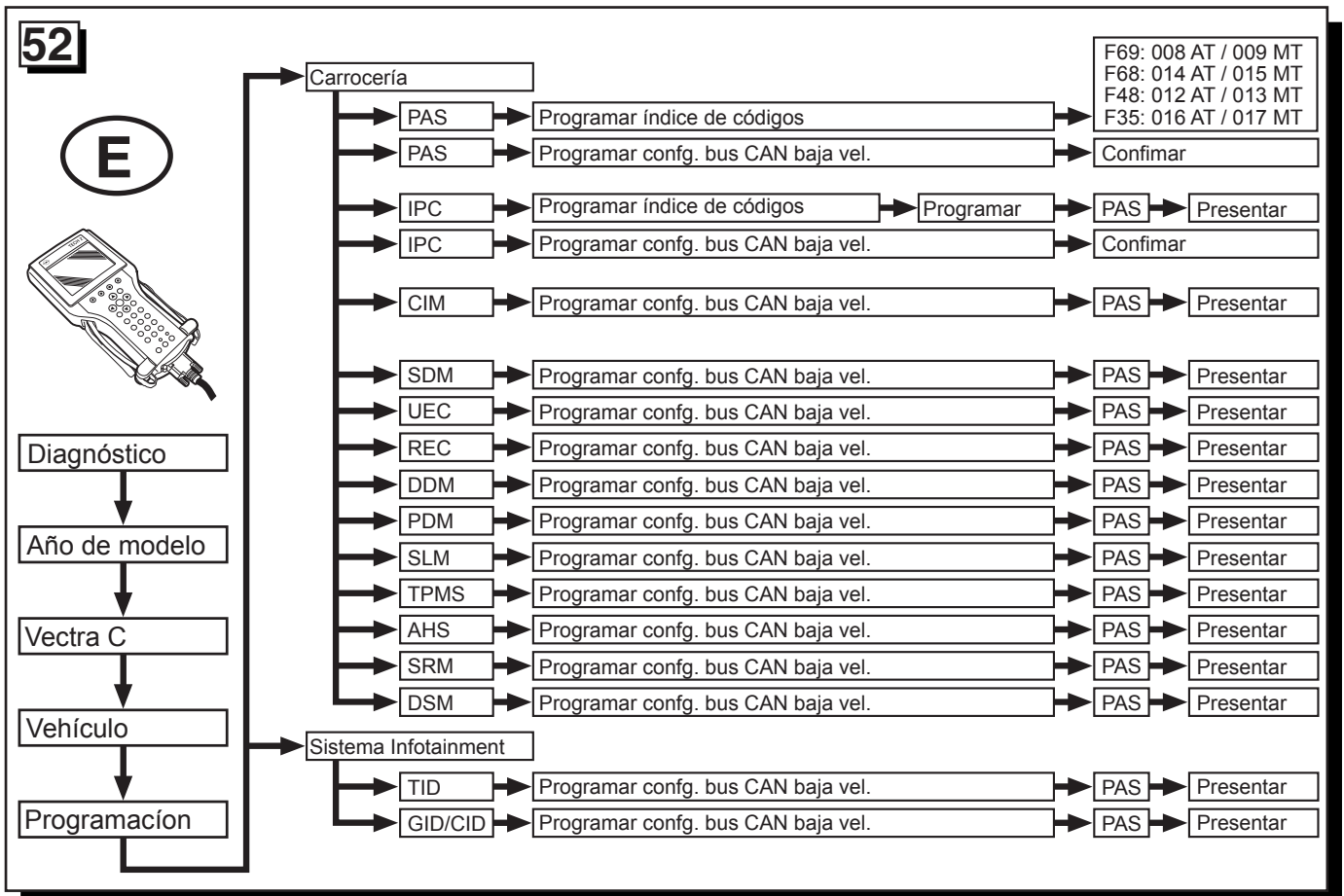
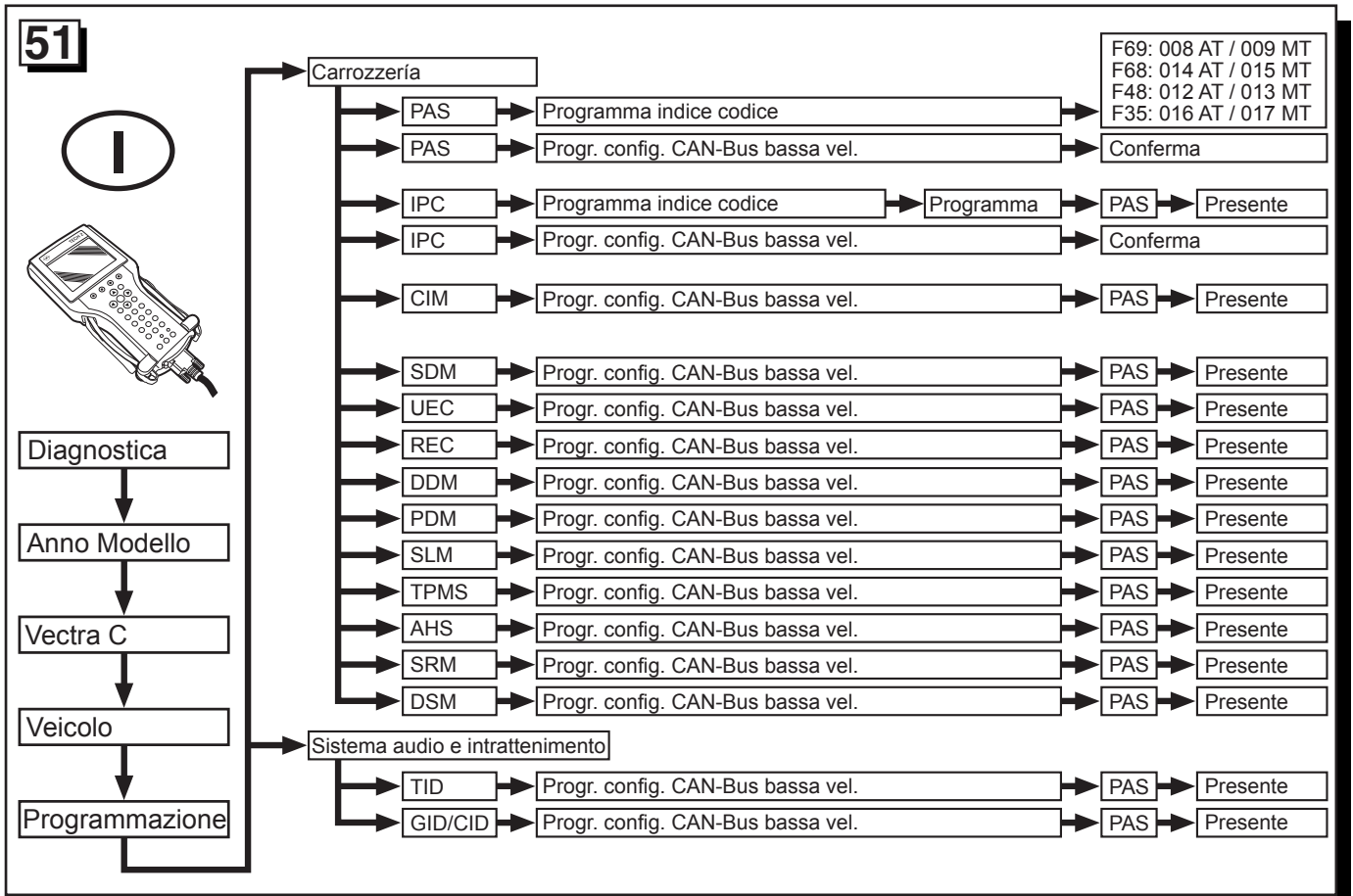

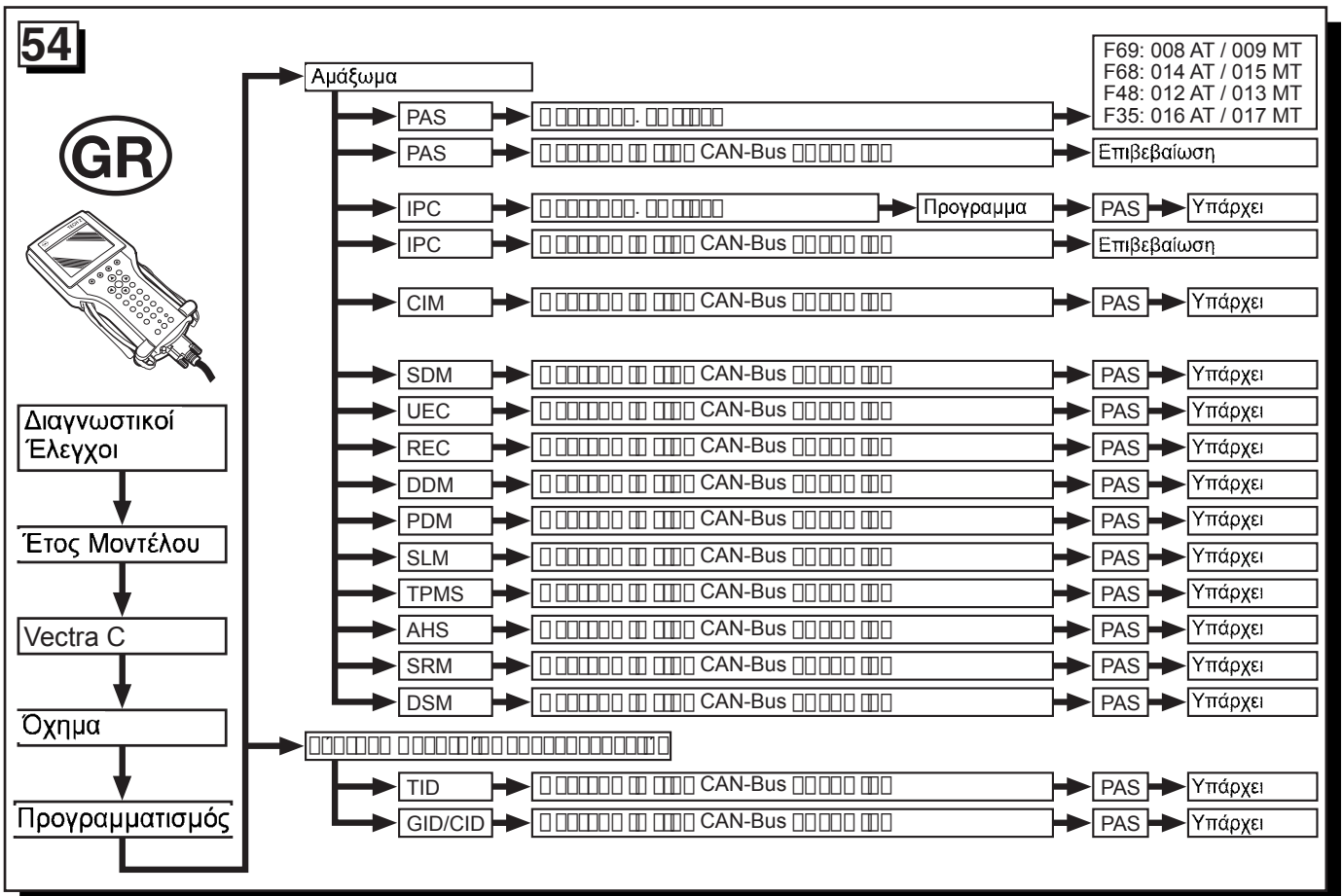
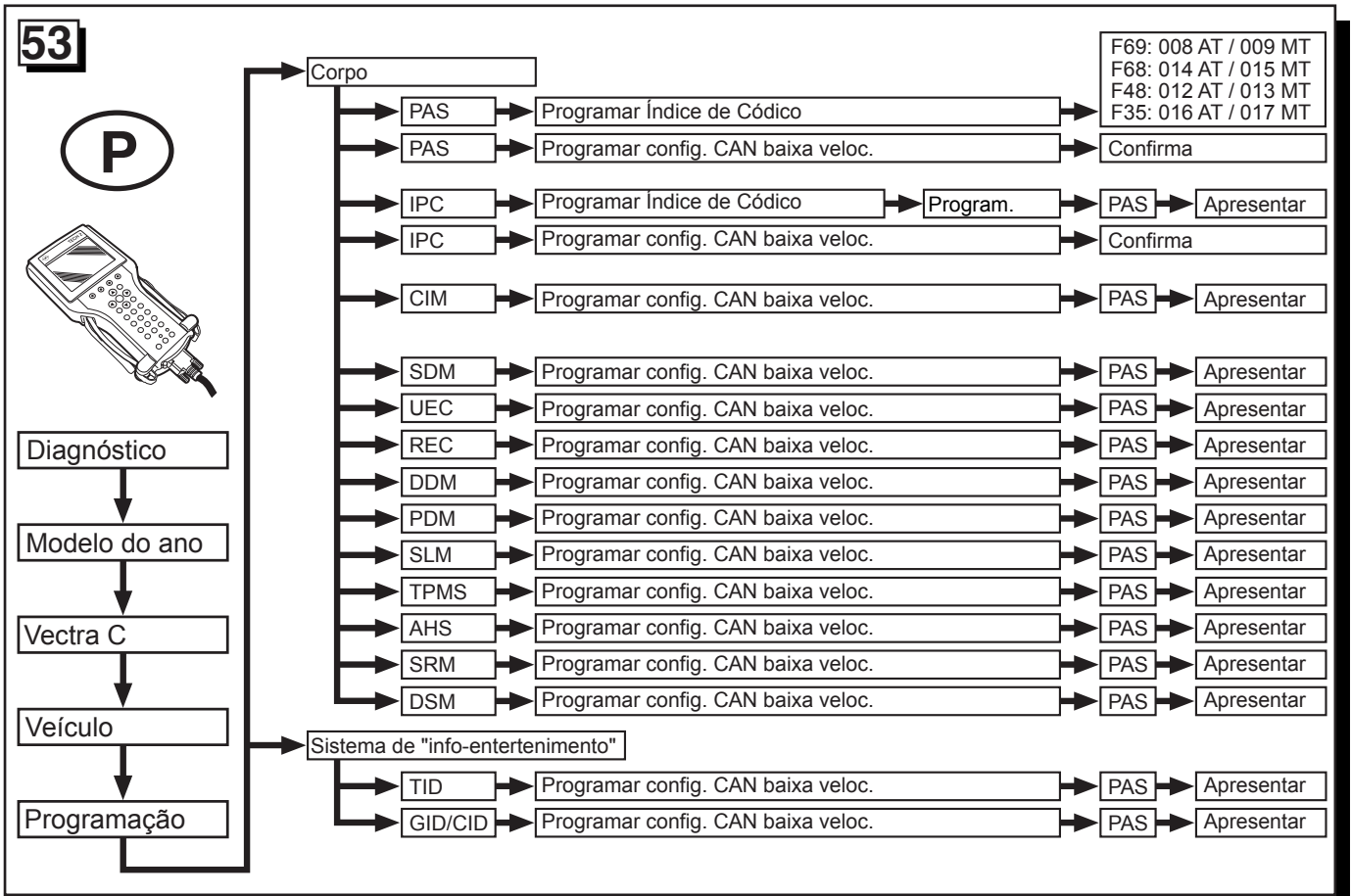

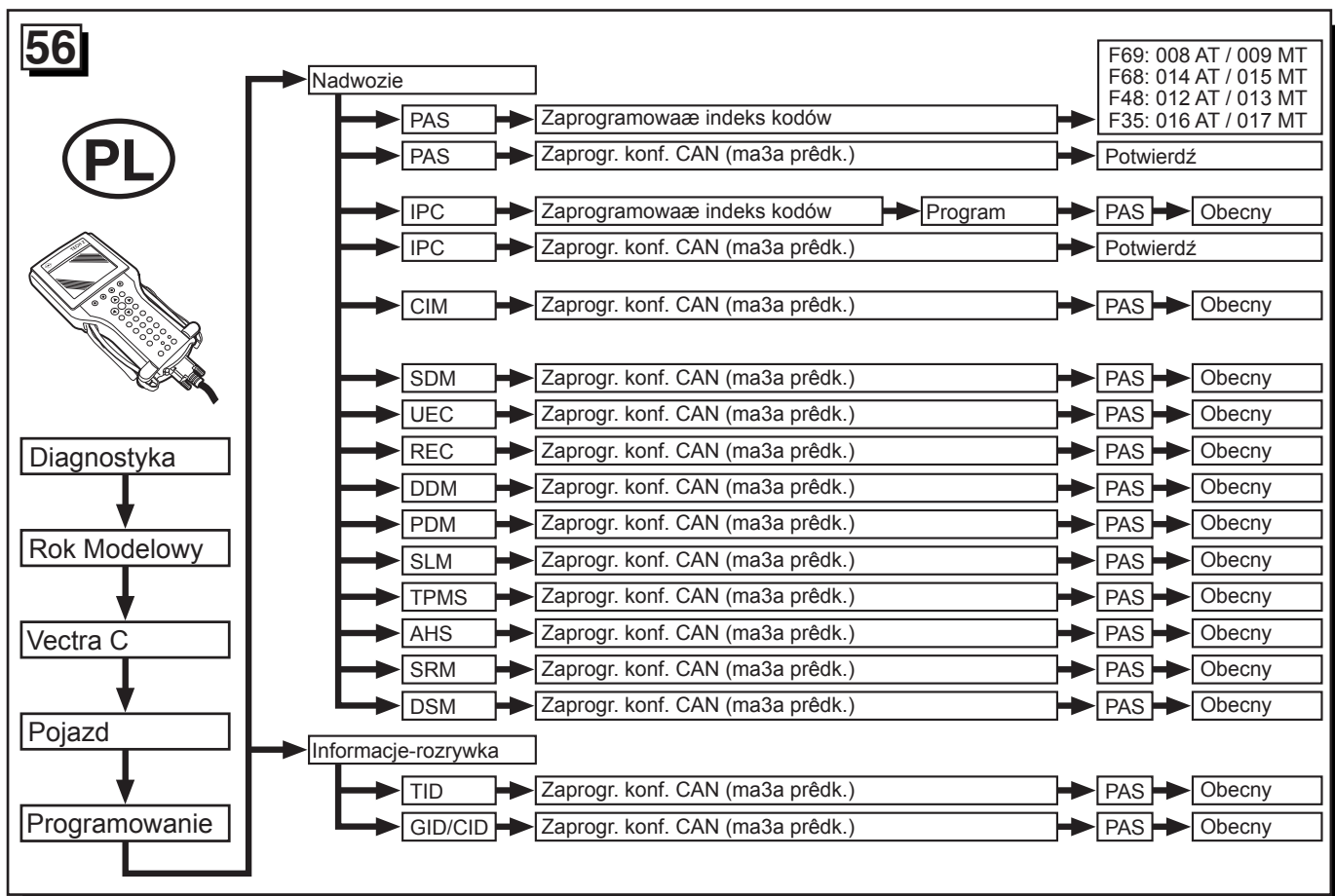
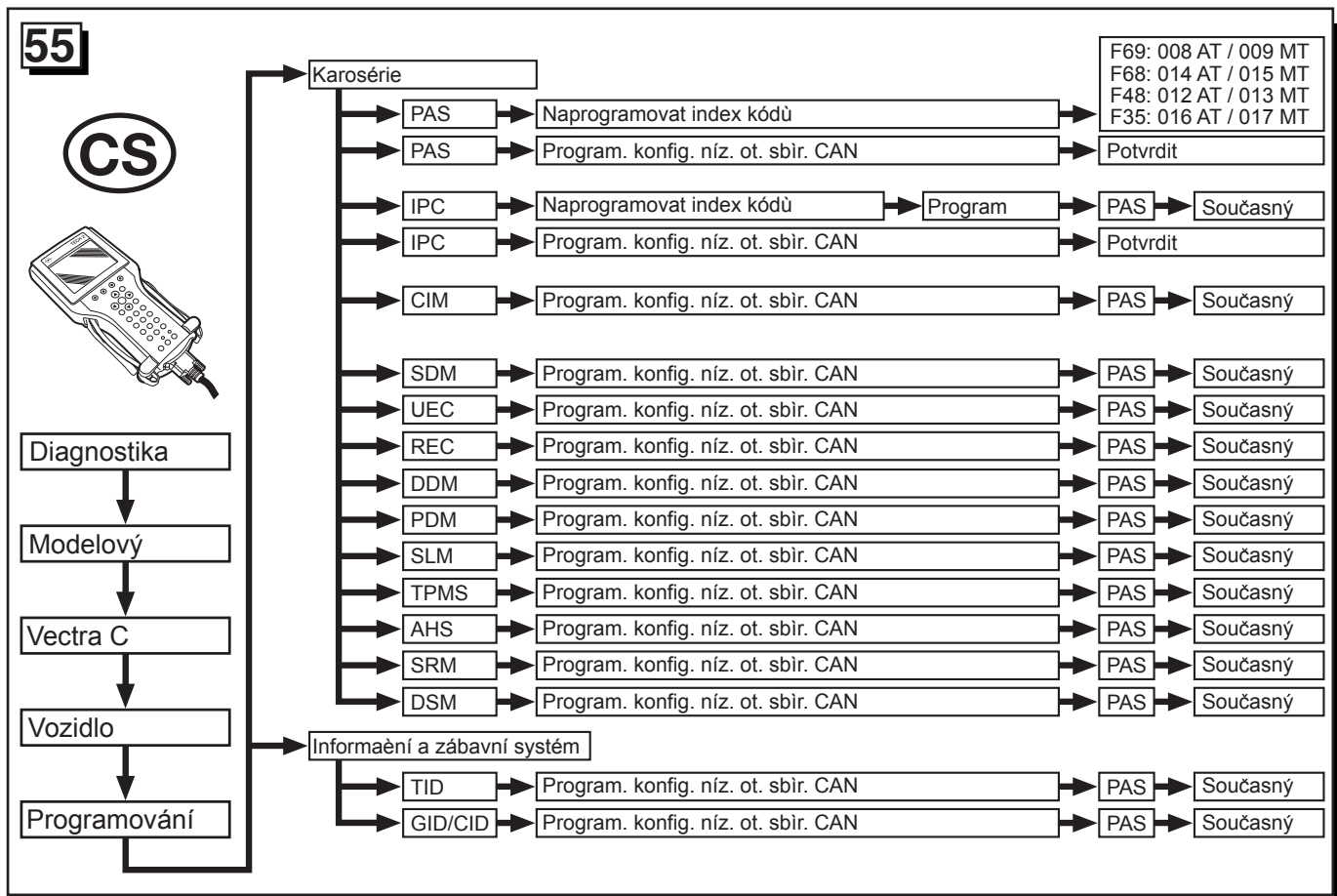

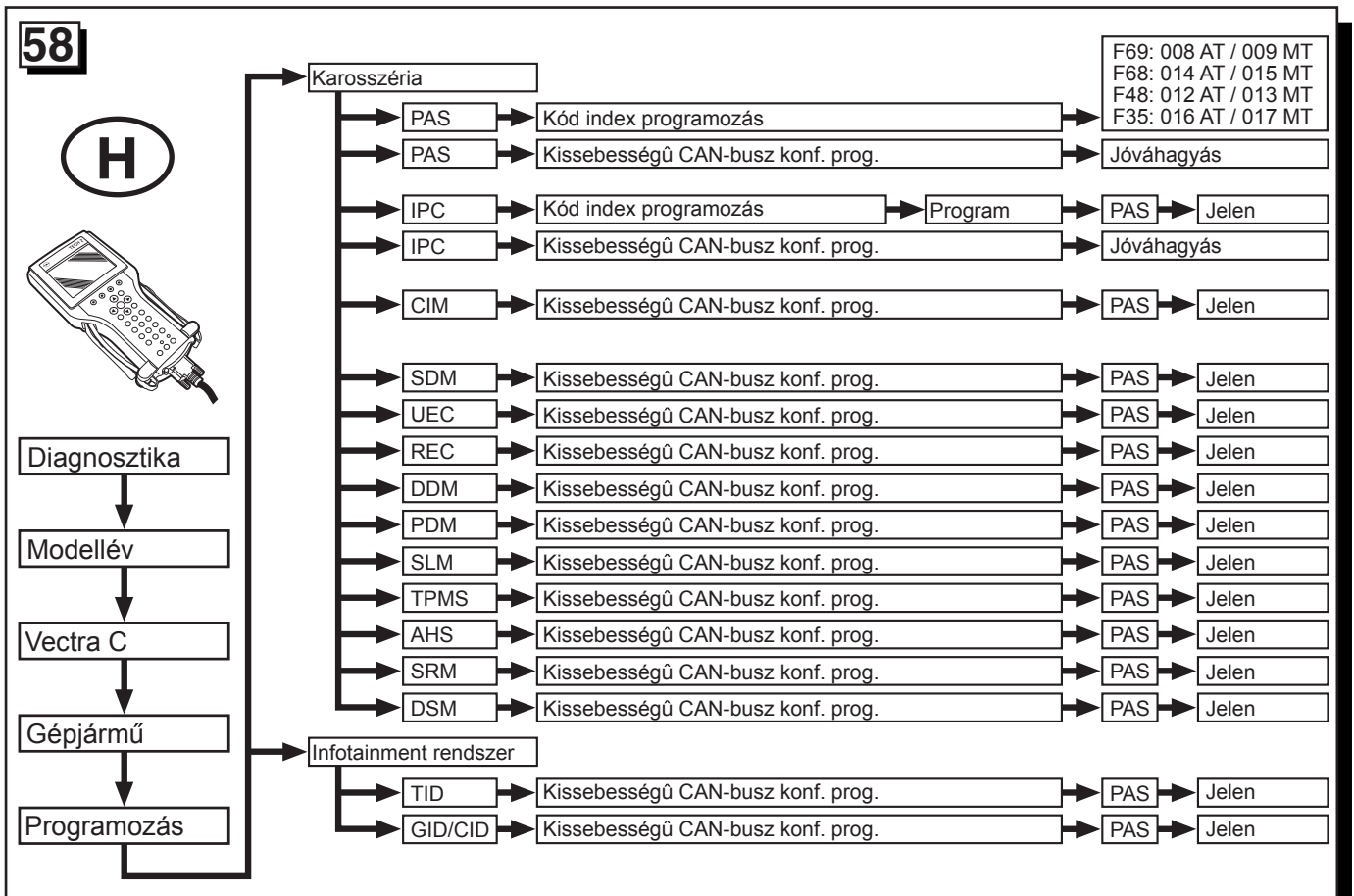
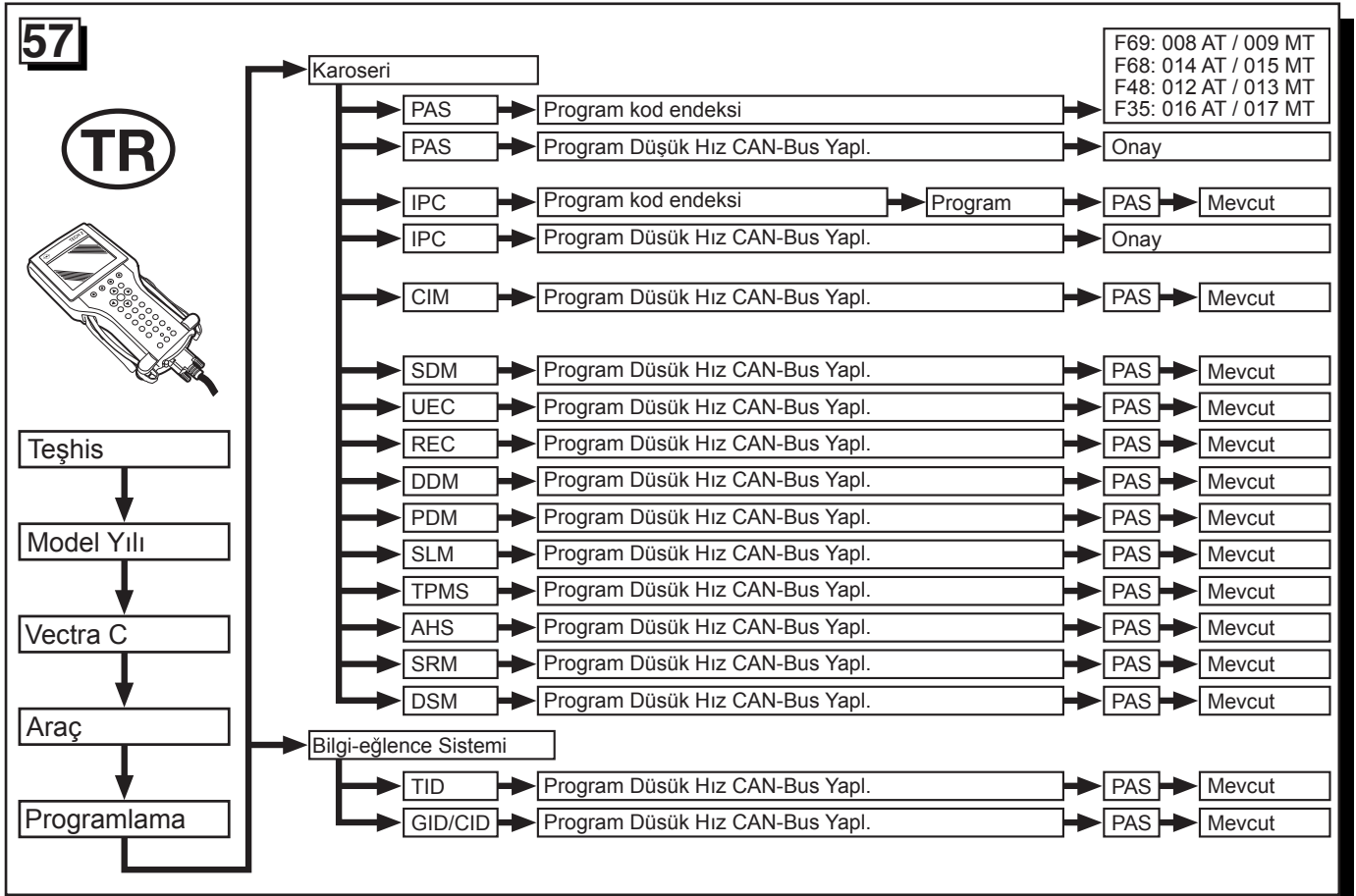

59

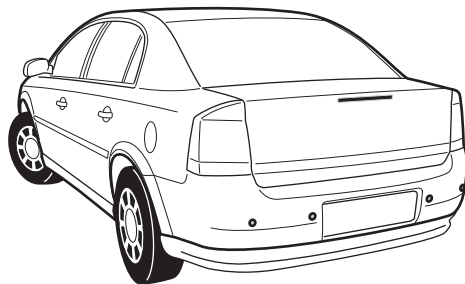

1000 mm

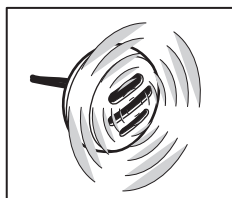

Funktionen kontrollieren !

Check functions !